

- LEGEND**
- EXISTING 2" IRON PIPE WITH BRASS CAP
 - EXISTING 1 1/2" INSIDE DIAMETER IRON PIPE
 - SET 3/4" X 24" RE-BAR WEIGHING 1.50 LBS PER LINEAL FOOT
 - SET NAIL ON LINE IN BLAZE OF 12" HEMLOCK
 - SET 600 NAIL WITH WOOD LATH FOR POINT ON 40' LINE
 - EXISTING 6" X 6" GRANITE MONUMENT

RECEIVED BY LINCOLN COUNTY
 SURVEYOR THIS 16TH DAY
 OF March 20 07
 COUNTY SURVEYOR

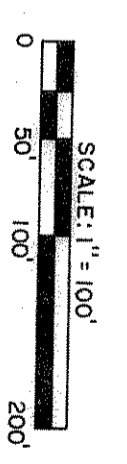

BEARINGS REFERENCED TO THE EAST LINE OF THE NE 1/4 OF SECTION 28,
 T34N, R8E, ASSUMED BEARING OF S0°13'27"W.

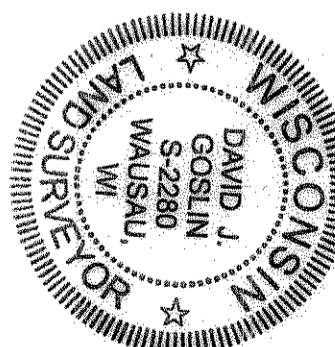

PLAT OF SURVEY
 OF
 THE NORTHWEST 1/4 OF THE NORTHEAST 1/4 OF SECTION 28, TOWNSHIP 34 NORTH, RANGE 8
 EAST, TOWN OF HARRISON, LINCOLN COUNTY, WISCONSIN.

I, David J. Goslin, Registered Land Surveyor hereby certify that I have surveyed and mapped by the order of Three Lakes Truck & Equipment, Inc. and that this map is a true and correct representation of the land surveyed to the best of my knowledge and belief. That I have complied with the provisions of Chapter AB-7 of the Wisconsin Administrative Code.

Prepared by:
 Wisconsin Valley Surveyors
 P. O. Box 1142
 222 N. 7th Avenue
 Wausau, WI 54402
 715-845-8146

David J. Goslin
 David J. Goslin RLS No. 2280
 March 9, 2007

L437A

EAST 1/4 CORNER SECTION 28

SOUTH 1/4 CORNER SECTION 28

50°13'27"W

EAST LINE NE 1/4

2659.38'