

THAT PART OF THE NE1/4 - NW1/4 AND THE NW1/4 - NE1/4 SECTION 8, AND THE SE1/4 - SW1/4, SW1/4 - SE1/4, NE1/4 - SW1/4, AND THE NW1/4 - SE1/4 SECTION 5, TOWNSHIP 31 NORTH, RANGE 7 EAST, TOWN OF MERRILL, LINCOLN COUNTY, WISCONSIN
 RELOCATION ORDER STH 17 LINCOLN COUNTY (STH 64 - BIG HAYMEADOW CREEK)

TO PROPERLY ESTABLISH, LAY OUT, WIDEN, ENLARGE, EXTEND, CONSTRUCT, RECONSTRUCT, IMPROVE, OR MAINTAIN A PORTION OF THE HIGHWAY DESIGNATED ABOVE, THE STATE OF WISCONSIN DEPARTMENT OF TRANSPORTATION DEEMS IT NECESSARY TO RELOCATE OR CHANGE SAID HIGHWAY AND ACQUIRE CERTAIN LANDS AND INTERESTS OR RIGHTS IN LANDS FOR THE ABOVE PROJECT.

TO EFFECT THIS CHANGE, PURSUANT TO AUTHORITY GRANTED UNDER SECTION 84.02 (3) AND 84.09, WISCONSIN STATUTES, THE DEPARTMENT OF TRANSPORTATION HEREBY ORDERS THAT:

1. THAT PORTION OF SAID HIGHWAY AS SHOWN ON THIS PLAT IS LAID OUT AND ESTABLISHED TO THE LINES AND WIDTHS AS SO SHOWN FOR THE ABOVE PROJECT.
2. THAT THE LANDS OR INTERESTS OR RIGHTS IN LANDS AS SHOWN ON THIS PLAT ARE REQUIRED BY THE DEPARTMENT FOR THE ABOVE PROJECT AND SHALL BE ACQUIRED IN THE NAME OF THE STATE OF WISCONSIN, PURSUANT TO THE PROVISIONS OF SECTION 84.09 (1) OR (2), WISCONSIN STATUTES.

PARCEL NUMBER	OWNER(S)	INTEREST REQUIRED	TOTAL ACRES OR S.F.	NEW	EXISTING	TOTAL	T.T.L.E. ACRES OR S.F.
1	EDWARD J. & PAULETTE A. HAGEDORN	FEE & A.R.	65,340 S.F.	145 S.F.	---	65,195 S.F.	0.06 AC (DRIVEWAY)
2	PAULETTE A. HAGEDORN	FEE & A.R.	27.5 AC	0.27 AC	---	27.23 AC	0.06 AC (DRIVEWAY)
3	RONALD PREY & WALTER PREY	FEE & A.R.	78.6	0.08 AC	---	78.52 AC	0.08 AC (DRIVEWAY)
4	THE EDWIN W. & KATHLEEN C. JOHNSON TRUST DATED 10-8-93	FEE, T.L.E. & A.R.	3.5	0.34 AC	---	3.16 AC	0.05 AC (DRIVEWAY)
5	G & M PETERSON, L.L.C.	FEE & T.L.E.	5	0.58 AC	---	4.42 AC	0.02 AC (DRIVEWAY)
6	FRED LATZIG, JR.	FEE & T.L.E.	10	0.21 AC	---	9.79 AC	---
7	RORY & JENNIFER JIROVEC	T.L.E.	---	---	---	---	---

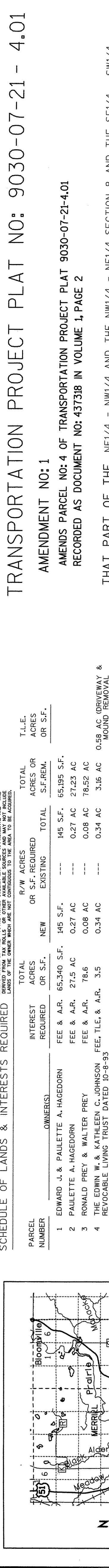

ABBREVIATIONS

ALUM.	RIGHT OF WAY	RT.
ACCESS RIGHTS	R/W	R/W
ACCESS POINT	SECTION	SEC.
CORNER	SQUARE FEET	S.F.
LEFT MONUMENT	TANGENT	TAN.
PROPERTY LINE	VOLUME	V.
REFERENCE LINE	PRIVATE DRIVEWAY	P.D.
REMAINING	AGRICULTURAL P.D.	AGRI. P.D.

CONVENTIONAL SIGNS

SECTION CORNER	IRON PIN	NON-MONUMENTED R/W POINT
NEW R/W LINE	VALVE (GAS, WATER, ETC.)	NON-COMPENSABLE R/W POINT
EXISTING R/W LINE	SIGN	COMPENSABLE R/W POINT
PROPERTY LINE	ELECTRIC POLE	NON-COMPENSABLE R/W POINT
MINOR LINES	TELEPHONE POLE	NON-COMPENSABLE R/W POINT
UNDERGROUND FACILITY (COMMUNICATIONS, ELECTRIC, ETC.)	PEDESTAL (LABEL, TYPE - COMMUNICATIONS, ELECTRIC)	NON-COMPENSABLE R/W POINT
TEMPORARY LIMITED EASEMENT	R/W	NON-COMPENSABLE R/W POINT
EXISTING R/W PLAQUE	NO ACCESS (BY ACQUISITION)	NON-COMPENSABLE R/W POINT
	NO ACCESS (BY STATUTORY AUTHORITY)	NON-COMPENSABLE R/W POINT
	ACCESS RESTRICTED (BY PREVIOUS PROJECT/CONTROL)	NON-COMPENSABLE R/W POINT

COORDINATE TABLE

POINT	NORTHING	EASTING	STATION	OFFSET
20	426867.020	404520.399	20	4986+51.45
101	426734.021	404520.226	101	4986+51.46
102	426433.393	404613.126	102	67+23.73
21	426459.134	404668.190	21	67+49.61
103	426482.536	404716.248	103	67+73.13
104	426811.297	404791.890	104	5016+23.18
105	426841.699	404841.699	105	5016+23.18
106	426832.970	404868.802	106	5026+00.00
22	426868.945	404868.945	22	5026+00.00
107	426868.970	404868.970	107	5026+00.00
108	426920.819	404843.383	108	5016+24.21
109	427187.367	404766.468	109	74+79.96
110	427907.223	404782.751	110	82+00.00
111	427994.171	404754.710	111	82+86.29
23	427985.526	404694.725	23	82+86.29
24	427153.641	404675.688	24	74+44.19
112	427155.900	404675.708	112	74+44.19
113	427000.016	404523.573	113	4986+54.45

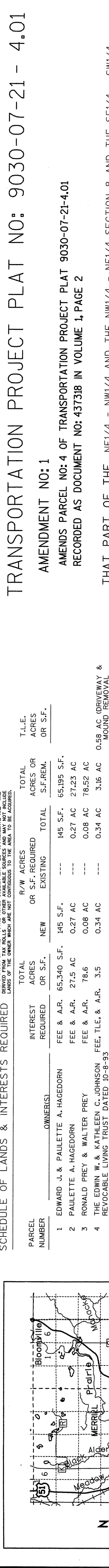

RESERVED FOR REGISTER OF DEEDS PROJECT NUMBER 9030-07-21-4.01
 ACCEPTED FOR RECORDING AND FILING IN THE OFFICE OF THE REGISTER OF DEEDS IN LINCOLN COUNTY, WISCONSIN AT 11:30 AM ON 10/22/04 AS DOCUMENT # 437318 AND FILED IN 10/22/04
 SIGNATURE OF REGISTER OF DEEDS: *Salene Calahan*

HEREBY CERTIFY THAT THIS PLAT MEETS ALL REQUIREMENTS OF SECTION 84.095, WISCONSIN STATUTES. THIS PLAT IS APPROVED FOR THE WISCONSIN DEPARTMENT OF TRANSPORTATION DISTRICT OFFICE.
 DATE: 10/22/04
 Name: *Debra De*
 Title: *District Supervisor*
 Name: *Abbey T. Bredt*
 DATE: 10/22/04

THIS PLAT WAS PREPARED BY OR UNDER THE DIRECTION OF:

STATION OFFSET TABLE

POINT	STATION	OFFSET
20	4986+51.45	0
101	4986+51.46	133.00' RT.
102	67+23.73	55.00' RT.
21	67+49.61	0
103	67+73.13	50.00' RT.
104	5016+23.18	55.00' RT.
105	5016+23.18	55.00' RT.
106	5026+00.00	33.00' RT.
22	5026+00.00	33.00' RT.
107	5026+00.00	33.00' RT.
108	5016+24.21	52.79' LT.
109	74+79.96	90.00' RT.
110	82+00.00	90.00' RT.
111	82+86.29	60.00' RT.
23	82+86.29	0
24	74+44.19	0
112	74+44.19	100.00' LT.
113	4986+54.45	133.00' LT.

COORDINATES AS SHOWN ARE NOT INTENDED TO BE USED FOR RETRACEMENT PURPOSES AND MUST BE VERIFIED

SCALE, FEET: 0 100 200

PLOT DATE: 22-NOV-2004 14:16
 PLOT BY: DITJXB
 PLOT NAME: L410B
 PLOT SCALE: 100.000000:1.000000
 WISDOT/CADDIS SHEET 72