

SCALE 1" = 2000'

NOTES:  
BEARINGS ARE REFERENCED TO THE LINCOLN COUNTY COORDINATE SYSTEM AS DEVELOPED BY THE WISCONSIN DEPARTMENT OF TRANSPORTATION AND ARE BASED ON MEASUREMENTS TO CONTROL MONUMENTS WHOSE COORDINATES WERE PROVIDED BY LINCOLN COUNTY.

SURVEYORS CERTIFICATE  
I, DAVID A. RENAUD, REGISTERED LAND SURVEYOR, HEREBY CERTIFY THAT I HAVE MADE THIS SURVEY AND MAP THEREOF AT THE DIRECTION OF LINCOLN COUNTY AND THAT THIS IS A TRUE AND CORRECT REPRESENTATION OF SAID SURVEY.

*David Renaud* 10/11/05  
DAVID A. RENAUD (AGENT) REGISTERED  
WI R.L.S. S-2142

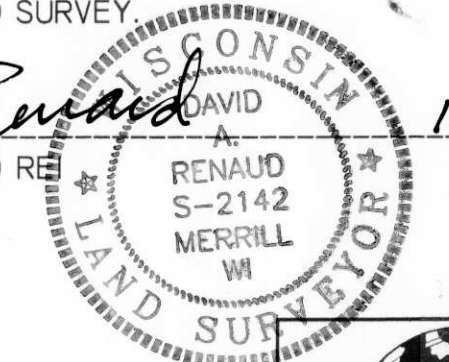

**REI**  
CIVIL & ENVIRONMENTAL  
ENGINEERING, SURVEYING  
4080 N. 20th AVENUE  
WAUSAU, WISCONSIN 54401  
PHONE: (715) 675-9784 FAX: (715) 675-4060  
EMAIL: mail@REIengineering.com

SECTION SUBDIVISION DIAGRAM  
TOWN OF BRADLEY  
TOWNSHIP 35 NORTH  
RANGE 6 EAST  
LINCOLN COUNTY, WISCONSIN

DESIGNED BY:	CHECKED BY: KF
SURVEYED BY:	APPROVED BY: DAR
DRAWN BY: MFL	DATE: 10/10/05

DATE	REVISION	BY	CHK'D
------	----------	----	-------

SHEET 1	PROJECT No. 4039
------------	---------------------

L406A

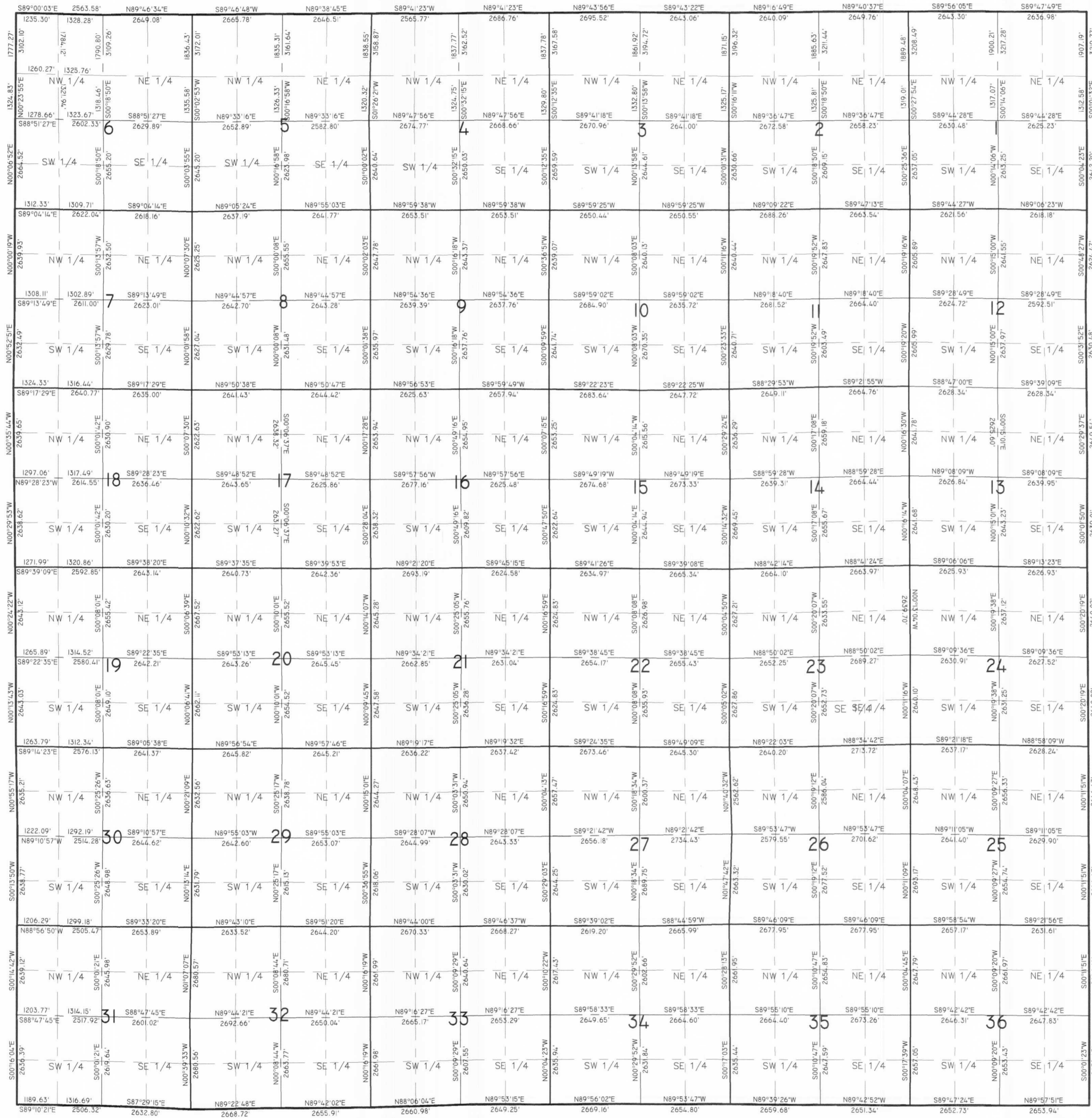

SCALE 1" = 2000'

NOTES:  
BEARINGS ARE REFERENCED TO THE LINCOLN COUNTY COORDINATE SYSTEM AS DEVELOPED BY THE WISCONSIN DEPARTMENT OF TRANSPORTATION AND ARE BASED ON MEASUREMENTS TO CONTROL MONUMENTS WHOSE COORDINATES WERE PROVIDED BY LINCOLN COUNTY.

SURVEYORS CERTIFICATE  
I, DAVID A. RENAUD, REGISTERED LAND SURVEYOR, HEREBY CERTIFY THAT I HAVE MADE THIS SURVEY AND MAP THEREOF AT THE DIRECTION OF LINCOLN COUNTY AND THAT THIS IS A TRUE AND CORRECT REPRESENTATION OF SAID SURVEY.

*David Renaud*  
DAVID A. RENAUD (AGENT) RE 2142  
WI R.L.S. S-2142

10/11/05



**REI**  
CIVIL & ENVIRONMENTAL  
ENGINEERING, SURVEYING  
4080 N. 20th AVENUE  
WAUSAU, WISCONSIN 54401  
PHONE: (715) 675-9784 FAX: (715) 675-4060  
EMAIL: mail@REIengineering.com

SECTION SUBDIVISION DIAGRAM  
TOWN OF BRADLEY  
TOWNSHIP 35 NORTH  
RANGE 6 EAST  
LINCOLN COUNTY, WISCONSIN

DESIGNED BY:	CHECKED BY: KF
SURVEYED BY:	APPROVED BY: DAR
DRAWN BY: MFL	DATE: 10/10/05

DATE	REVISION	BY	CHK'D

SHEET	PROJECT No.
1	4039

L406B