

LOCATED IN THE NE 1/4-SE 1/4, SECTION 24, T35N, R07E, TOWN OF KING LINCOLN, COUNTY, WISCONSIN

BEARINGS REFERENCED TO THE EAST LINE OF SECTION 24, T35N, R07E,
ASSUMED TO BEAR N00°25'07"W.

LEGEND

- FOUND GRANITE MONUMENT
- ▼ FOUND 2" CAPPED IRON PIPE
- FOUND 1" IRON PIPE
- SET 1" X 24" IRON PIPE
- () RECORDED AS
- ▬ SET 3/4" X 24" IRON ROD

PROPERTY DESCRIPTION

A parcel of land located in the NE 1/4 - SE 1/4, section 24, T35N, R07E, Town of King, Lincoln County, Wisconsin described as follows:
Commencing at the east 1/4 corner of said section 24, and point of beginning, thence S00°25'07" E, a distance of 1297.15 feet to an iron pipe; thence N88°55'22" W, a distance of 1308.11 feet to an iron pipe; thence N00°25'07" W, a distance of 1352.28 feet to an iron pipe; thence S88°30'48" E, a distance of 1310.71 feet to the point of beginning. Said parcel contains 39.76 acres. Subject to easement, restrictions, reservations, and rights-of-way of record or in use.



NOTE: Above area includes that portion of the pond as shown.

I, KEVIN P. BIXBY, HEREBY CERTIFY THAT I HAVE SURVEYED THE ABOVE PARCEL OF LAND UNDER THE DIRECTION OF CORKY McREYNOLDS AND THAT THE ABOVE MAP IS A TRUE AND CORRECT REPRESENTATION OF THE LANDS SURVEYED TO THE BEST OF MY KNOWLEDGE AND BELIEF THAT I HAVE PROVIDED A DESCRIPTION OF THE PARCEL, THAT I HAVE COMPLIED WITH THE PROVISIONS OF AE 7 OF THE WISCONSIN ADMINISTRATIVE CODE.

Kevin P. Bixby
KEVIN P. BIXBY R.L.S. 2343

02/09/04
DATE

RECEIVED BY LINCOLN COUNTY
SURVEYOR THIS 10TH DAY
OF February 20 04
Tommy Dull
COUNTY SURVEYOR

L374B

REVISED 11/07/03 W.L.M.

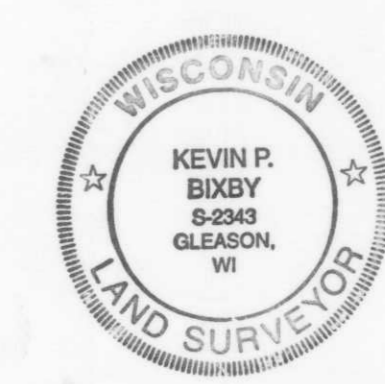

DWG. NO. 0175	BIXBY LAND SURVEYING INC. RHINELANDER, WISCONSIN
SURVEY FOR U.W.S.P. TREEHAVEN TOMAHAWK, WI.	
SCALE: 1" = 100' DATE: 02/25/03 DWN. BY: K.B.	