

L I N C O L N C O U N T Y

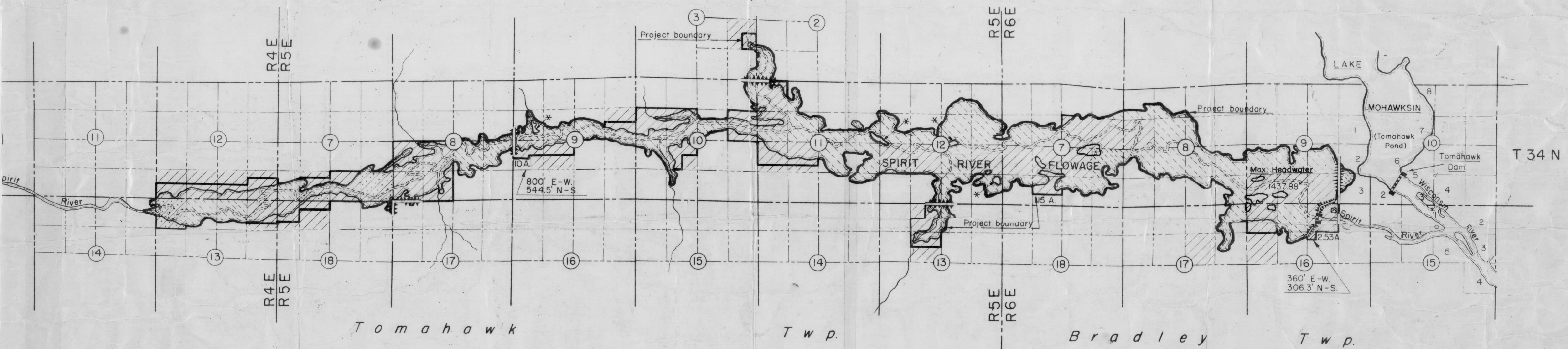

NOTE:  
See Exhibit "F" for details of ownership

NOTE: This is a DUPLICATE of the ORIGINAL filed with the Federal Power Commission.  
Revisions shown are only those made or noted on the filed Original.

NOTE-- USC & GS. Elevations shown hereon have been corrected 0.35' higher to agree with 1955 Level circuit.

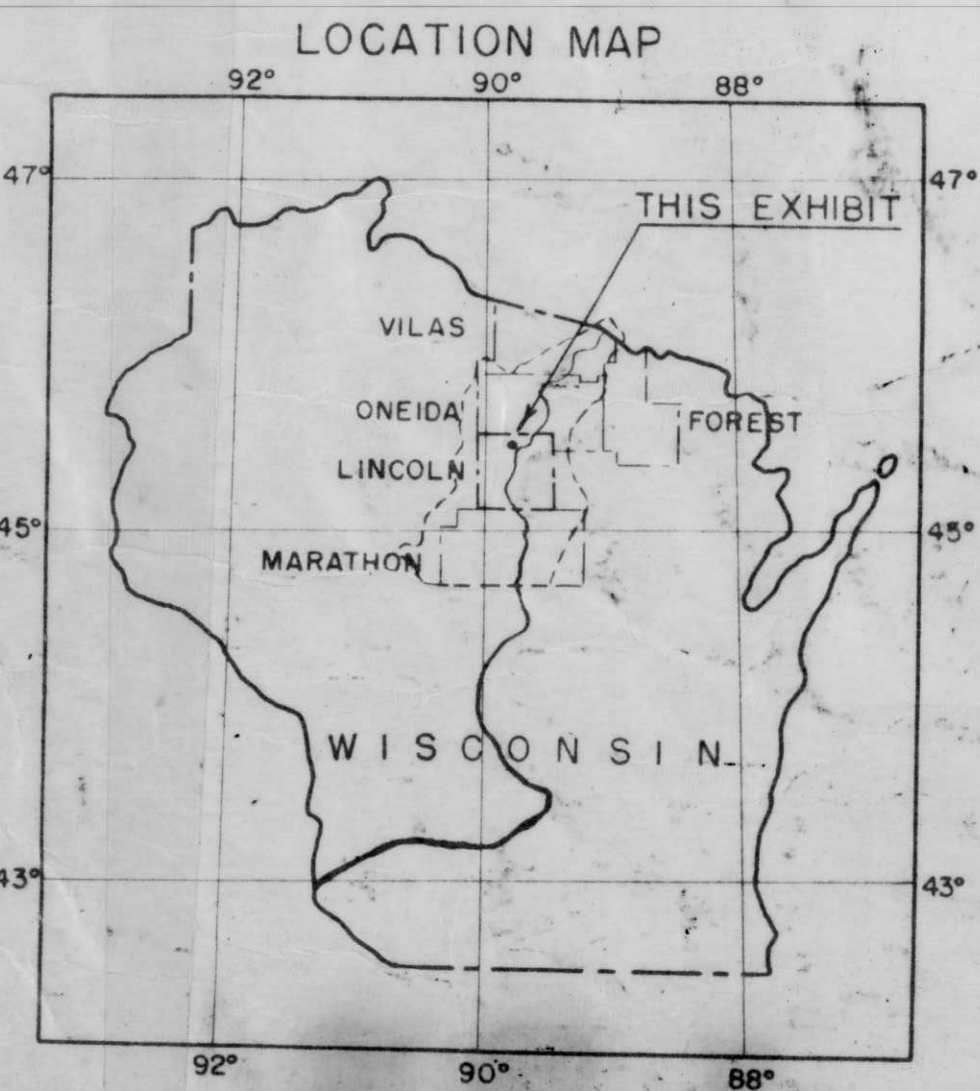

- LEGEND**
- BRIDGE
  - DAM
  - FILL
  - RAILROAD
  - BENCH MARK
  - LAND OWNERSHIP**
  - OWNERSHIP IN FEE
  - OWNERSHIP IN FEE - TIMBER RIGHTS TO OTHERS
  - FLOWAGE RIGHTS
  - NON-PROJECT

**ELEVATION DATUM**

Bench Mark-- A bronze tablet marked Railroad Commission of Wisconsin set in a concrete post 116.8' from Northwest corner and 97.9' from Northeast corner of dam-tender's house and 36.5' West of centerline of C.T.H. "E", Elevation 1431.74', referred to the 1929 datum of the U.S. Coast & Geodetic Survey BM "Metz".

Bench Mark-- A "□" cut in concrete roadway of dam in line with center pier and about 2' from downstream edge of roadway, Elevation 1442.97', referred to the 1929 datum of the U.S.C. & G. BM "Metz".

Maximum Headwater- 1437.88' - 2096 Acres  
 Minimum Headwater- 1420.88' - Original River - Approx. 40 Acres  
 Maximum Capacity- 756 M.C.F.  
 Minimum Capacity- 0 M.C.F.  
 No Seasonal Limits

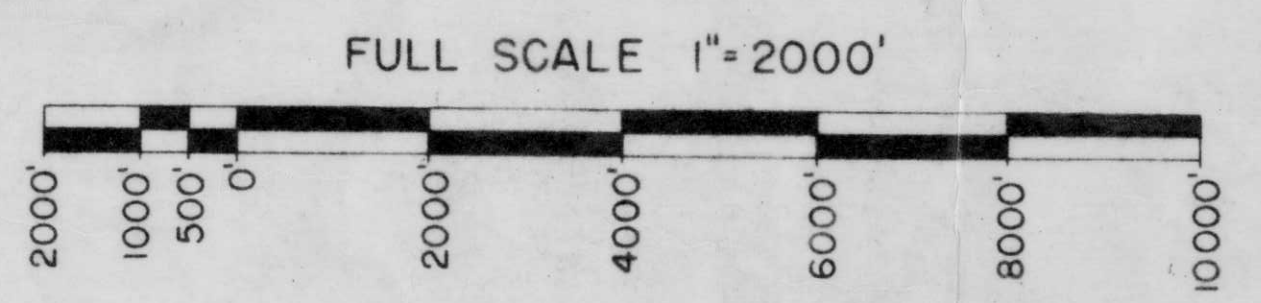

**CERTIFICATE OF EXHIBIT**

THIS MAP IS A PART OF THE APPLICATION FOR LICENSE MADE BY THE UNDERSIGNED THIS 21<sup>st</sup> DAY OF June, 1952

Wisconsin Valley Improvement Co.  
NAME OF APPLICANT

BY *Walter A. Taylor*  
VICE-PRES.

**WISCONSIN VALLEY IMPROVEMENT CO.**  
WAUSAU, WISCONSIN  
EXHIBIT "K" - SHEET 17

**SPIRIT RESERVOIR**

SCALE AS SHOWN DECEMBER 1952  
Revised 3-14-63

B