

LOTS 9 - 18
 and part of
 LOTS 1 & 2
 BLOCK 23
 ORIGINAL PLAT
 CITY of TOMAHAWK
 being in
 SECTION 34
 T. 35 N., R. 6 E.
 LINCOLN COUNTY, WIS.
 NE SW

4th STREET

5th STREET

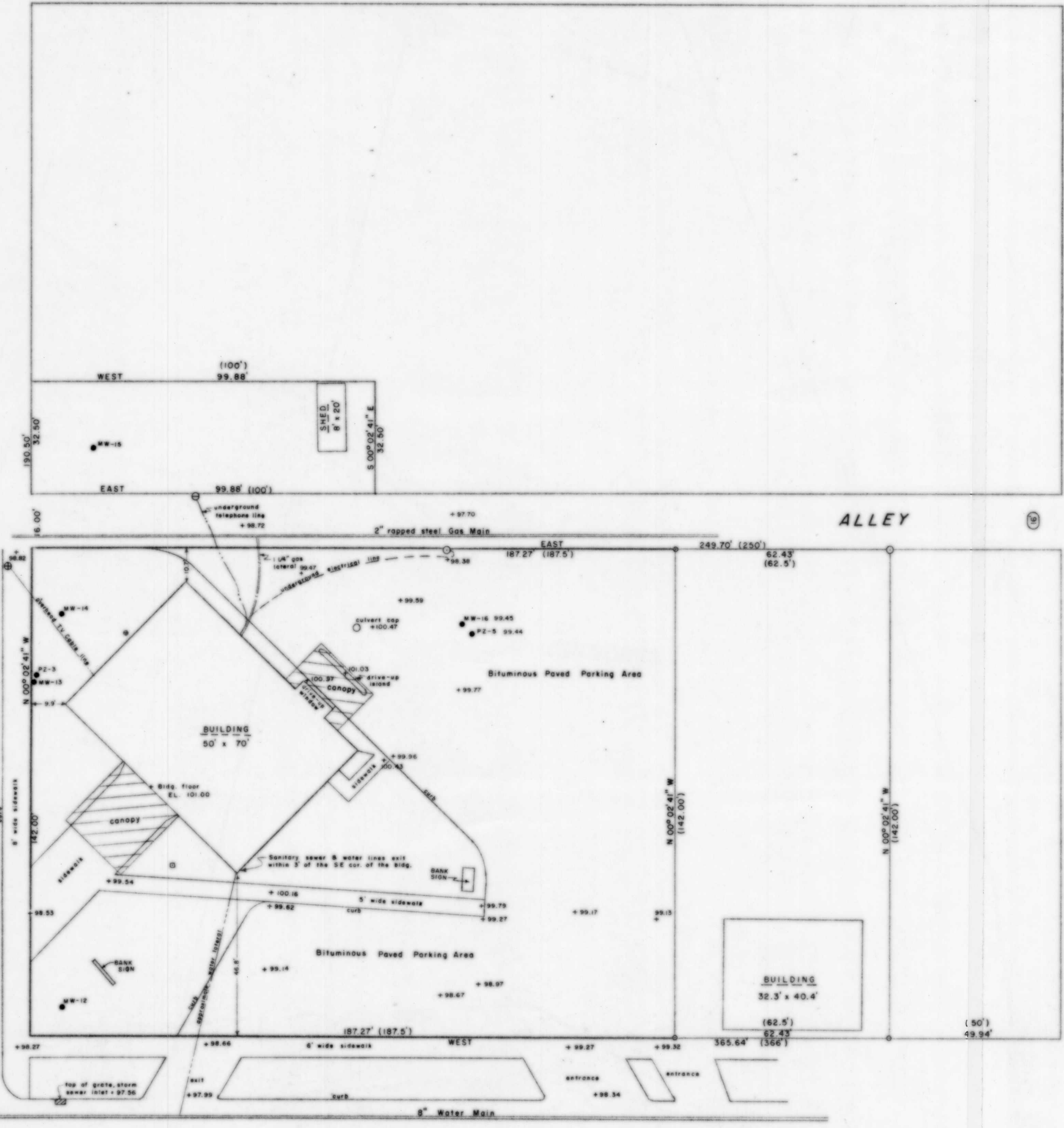

LEGEND

- ⊙ 1 1/4" IRON PIPE FOUND IN PLACE.
- 1" IRON BOLT FOUND IN PLACE.
- 1" IRON PIPE FOUND IN PLACE.
- 1" IRON PIPE SET THIS SURVEY.
- ⊙ POWER POLE
- ⊙ TELEPHONE POLE
- ⊙ LIGHT POLE
- () INDICATES RECORDED DISTANCE.
- MONITORING/PIEZOMETER WELL.
- ⊙ FLAG POLE.
- ASSUMED CLEANOUT FOR SUMP PUMPS.

I, Lester J. Schmit, Registered Land Surveyor S-1192 hereby certify that I have surveyed the property shown hereon; that this map is a true and accurate representation thereof; that said survey was performed by order of James S. Dentler and the Tomahawk Community Bank; and that I have complied with applicable requirements of s. A-E 7 of the Wisconsin Administrative Code.
 Note: Legal descriptions conforming to this survey have been provided on separate sheets.
Lester J. Schmit
 Lester J. Schmit R. L. S. S-1192
 Dated this 7th day of February 1992

Rec'd
 Oct 1992
 M.G.

B

TIMBERLAND SURVEYORS TOMAHAWK WIS.

SURVEY FOR
TOMAHAWK COMMUNITY BANK
 15 EAST WISCONSIN AVE.
 TOMAHAWK, WIS.

DATE 7 FEB 92 DWN BY L.J.S. SCALE 1" = 20'
 REVISED 13 FEB 92 BY L.J.S. DWG. NO.
 REVISED BY 946

BEARINGS ASSUMED