



LANDS OWNED BY OTHERS

1 1/4" iron pipe found in place

1 1/4" iron pipe found in place

1032' Fence line

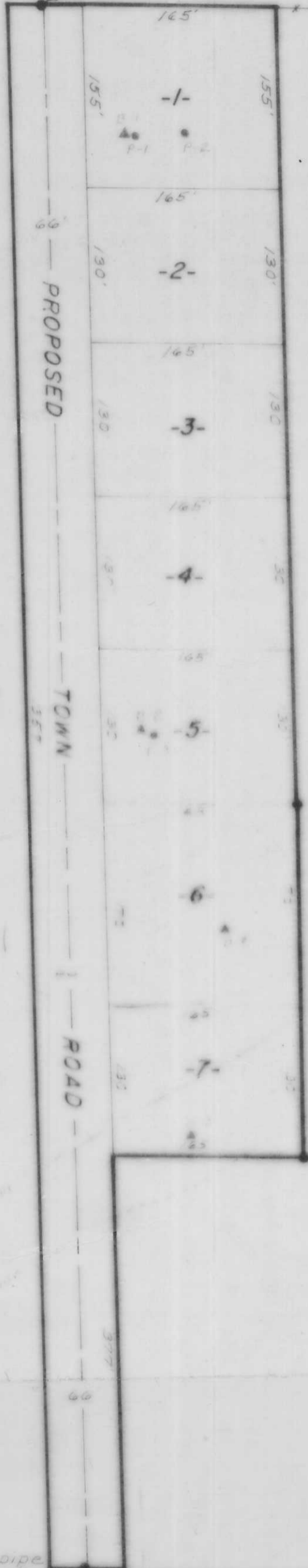

PLATTABLE
LANDS OWNED
BY SUBDIVIDER

NE 1/4

LANDS OWNED BY OTHERS

LANDS OWNED BY OTHERS

1" iron pipe found in place

DUGINSKI

ROAD

LANDS OWNED BY OTHERS

LANDS OWNED BY OTHERS

PRELIMINARY
DOERING HIGHLANDS
Part of the
SW 1/4 of the NE 1/4
SECTION 1, T31N, R6E

Merrill Township
Lincoln County, Wisconsin

Northwoods
Surveyors
Inc.

Scale 1"=100'

The slope and contour information
shown hereon is accurate and true
to the best of my knowledge and belief.

Registered Land Surveyor #5-836
Dated this _____ day of _____, 1975

B

Drafted by D. McMullen