

34 B

1855

34-8 Lines_a

6	5	4	3	2	1
7	8	9	10	11	12
<small>47</small> 18	17	<small>35</small> 16	<small>15</small> 15	<small>3</small> 14	<small>10</small> 13
<small>46</small>	<small>36</small>	<small>22</small>	<small>17</small>	<small>11</small>	<small>13</small>
<small>66</small> 19	<small>43</small> 20	<small>38</small> 21	<small>19</small> 22	<small>4</small> 23	<small>7</small> 24
<small>62</small>	<small>41</small>	<small>33</small>	<small>68</small> <small>21</small>	<small>5</small>	<small>6</small>
<small>64</small> 30	<small>61</small> 29	<small>39</small> 28	<small>32</small> 27	<small>27</small> 26	<small>73</small> <small>23</small> 25
<small>58</small>	<small>67</small>	<small>31</small>	<small>29</small>	<small>25</small>	<small>45</small>
<small>56</small> 31	<small>59</small> 32	<small>40</small> 33	<small>30</small> 34	<small>28</small> 35	<small>26</small> 36

34-7 Lines_a

6	5	4	3	2	1	
7	8	9	10	11	12	
18	17	16	15	14	51 13	47
					50	
19	20	21	22	23	52 24	66
					65	
30	29	28	27	26	53 25	64
					57	
31	32	33	34	35	54 36	56
					55	

297
 1000
 74
 335
 319

2,14.5

207.3

2,087.7

43,500

4

0.3560

32.64

3.9600

CAROL
 PAGE

41

210.4

1.7

56

6	5	4	3	2	1
7	8	9	10	11	12
14	17	35	615	15	3141013
46	36	22	17	11	13
66	19	20	38	19	32433729
62			35	4	5
35	6	29	30	23	717561035
30	67	21	23	25	(45)
36	31	932	33	39	5418352036

33

The image shows two pages of graph paper from a notebook. The left page is numbered '12' in the top left corner. The right page is numbered '2' in the top right corner. Both pages are covered in a grid of small squares. A vertical line runs down the center of the notebook, and a horizontal line runs across the middle of each page, creating a table-like structure with four columns and two rows. The pages are otherwise blank.

SOUTH BET 14-15
20-23

BEGIN AT SEC COR STONE
14-15, 10, 11 ON RANDOM
DOWN ROAD 1388 LEAVE
ROAD AT FENCE LINE
FENCE ON ~~1/2~~ LINE SOUTH
2675.6 TO ~~1/2~~ IRON STAKE
(WEST 7.4)

ALSO END OF FENCE
4549.5 OFF SET EAST
1287.6' EAST TO Δ
4323.1 TURN LT $58^{\circ} 57'$ WEST

4326 TO LAKE 14.5' WEST TO MC,
IRON AND WOOD STAKE
ON HUB ACROSS TURNED $7^{\circ} 28'$
OFF RANDOM TO OFF SET
FLAG $7^{\circ} 58'$ (BET. HUBS 215AA)
STATION OF HUB ON SOUTH
SHORE 6443.9

LEAVE LAKES
6440
6443.9 TURNED LT NW OFF
BACKTAN. 21' 5' TO MC
POST AND IRON PIN, 73.6'

6856 PRIVATE ROAD NNW.

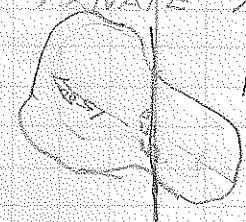

7870.8
TO LAKE AND SET FLAG
FOR TRIANGULATION
FROM HUB ACROSS 21.5
OFF SET WEST 156.9
TURNED $74^{\circ} 14'$ BET. HUBS
ON RANDOM LINE

8416 LEAVE LAKE
9202 PRIVATE ROAD SSW

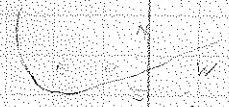

10371.0 TO HIGHWAY "B" ENE
10726.7 TURNED EAST

EAST BET 23-26

BEGN AT STA 10726.7
ON RANDOM BET 22-23
SEE PAGE 4

880 E "B" N-S

~~5351.5~~ TURNED RT. (NORTH)
OFF BACK TAN. TO
OLD STAKE (ROUST FENCE)
80.5.5' 13.2' OFF BACK TAN

5193.5 TURNED RT. NORTH
TO REMAINS OF VERY
OLD STAKE & MOUND OF
STONE AROUND IT. FENCE
CORNER TO IT
95° 31' 55.1

FENCE TO SOUTH EAST
AND WEST

EAST BET 24-25

CONTINUING SAME RANDOM.
5143.0 BET 23-26
0000 BET 24-25 SEE
PAGE 5

1363 FENCE N-S OFF BACK TAN
5649.5 TURNED RT TO $\frac{1}{4}$
ORIGINAL 38.6
92° 35'

MOUND 1.16

3153 E. MOUND (2 NE
3972.5 GREAT NORTH (3 W)

TO AVOID WET

SWAMP (3900)

NORTH TO END 1163

186.1' TO END NORTH

4561 DEEP CREEK

5173.9 ~~400~~ TURNED LT. (NE)
TO 79" IRON PIPE

BACK W.C. SET BY LA CLAY
COUNTY

2° 49' 137.6

(OVER)

PIPE MARKED THUS

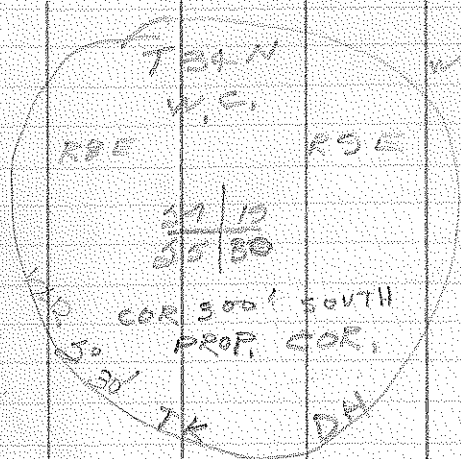

NORTH ① BET 3334

30 CO TWO SMALL LAKES

EAST OF RANDOM ABOUT

400' EAST N-S

1142 ENTER SWAMP

1512 LEAVE "

2468 ENTER "

2665 LEAVE SWAMP

3652 FLAG ON RANDOM FOR

TRIANGULATION / TOP OF

STEEP HILL

3957 TO SOUTH SHORE OF

CHAIN LAKE

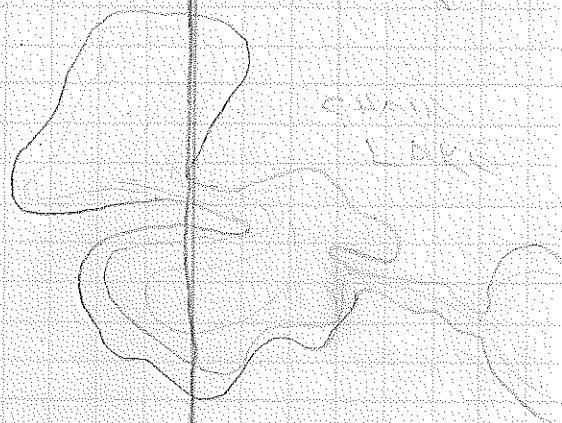
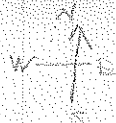

RANDOM

OFF SET WEST ON HUBACROSS

392.5 TURNED TO

FLAG ACROSS BOTH LAKES 78°

TO FLAG ON POINT

BET. THE TWO LAKES 66° 17'

4300 TO POINT DIVIDING
 THE LAKES
 4407 ACROSS POINT TO
 LAKE
 5056 LAKE
 5008.1 HUB ON TAN,
 FROM WHICH WE
 OFF SET WEST
 592.5' TO TRIANGULAR
 5811.1 END RANDOM

4572 ENTER LAKE
~~4805~~ ENTER SWAMP
 5015 LAKE FLOWS (E) OFF FOR TAN
 5262.5 TURNED RT (N E)
 1937 NOTES) 54° 58'

NORTH
 BET 13-14

5811.1 ON RANDOM
 BEGIN AT STA
 BET 33-31 9 1/2 HRS
 539 ENTER LAKE
 359 LEAVE " EAST EDGE
 2541 TO LAKE
 2537.0 TURNED LT N E
 135° S OFF BACK TAN
 10314
 TO 1/2 POST BY PIT
 2536.0 SET FLAG ON
 RANDOM FOR
 TRIANGULATION
 OFF SET ON W
 HUB ACROSS 152.1
 AND TURNED 84° 24' SET
 HUBS ON RANDOM
 1542.0

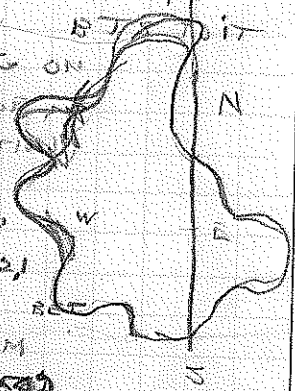

LEAVE LAKE 3912
 4078 STA OFF WHICH
 WE OFF SET WEST
 4689 LEAVE LAKE
 4995 CREEK FROM
 OTHER CREEK FLOWS WEST
 TO 266, COPS 11, 12, 13, 14 CREEK
 255.7

WEST BET 23-24

BEGIN AT STAY 5011.1
 ON RANDOM BET, 23-24
 1207.0 SET FLAG ON
 RANDOM FOR TRIANGULATION
 SET HUB ACROSS
 1263 TO LAKE
 1670 LEAVE LAKE

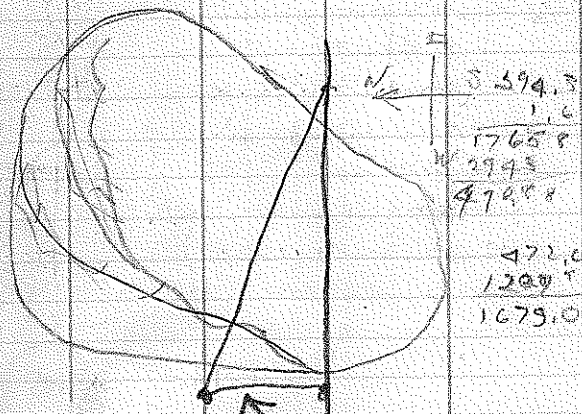

OFF SET 594.3
 TURNED 58° 4' BET
 HUBS 294.3'

1679.0 STAY OF FROM WHICH
 WE OF SET NORTH 294.3
 BY SWAMP LAKE 1660
 3000 LEAVE SWAMP
 2130 ENTER "
 2240 LEAVE "

~~EAST BET 13-24~~

23 70 ENTER SWAMP
 24 45 CREEK ^{FROM LAKE} FLOWS ESE
 26 02 LEAVE SWAMP
 31 20 SAME LAKE
 3118.6 FLAG FOR
 TRIANGULATION
 (3715 LEV) ON HUB ACROSS 3140
 3719.4 OFF SET NORTH
 152.0
 TURNED 95° 45' 2300
 BET HUBS ON RANDOM
 4077.2 TURNED ^{OFF ELECT TAP} LT NW 936°
 136° 32' 275.1
 TO IRON STAKE MC
 WITNESSED



EAST BET 13-29
 BEGIN AT STA. 5011
 ON RANNEY, SECT 33-29

535 ENTER LAKE
 640 LEAVE LAKE

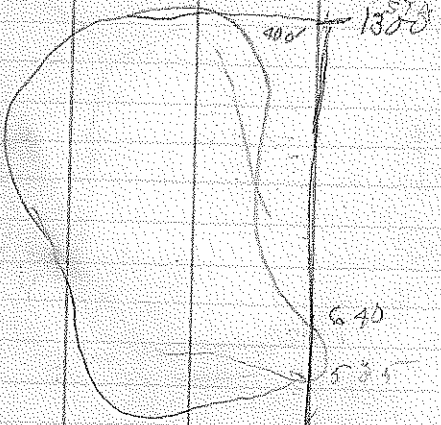

1930 CREEK FROM
 CAMP 2 LAKE
 FLOWS SE

2500 TANGENT TO SAME
 CREEK WHICH
 THEN FLOWS SE
 AGAIN

4065 ENTER SWAMP
 4223 LEAVE "

5342.9 TURNED RT. OF
 BACK TANK TO
 SEC. COR. 13, 12, 14,
 24 AS SET
 BY LANGLAND CO
 100° 57'
 118.4 FT



MAPLE 14" N @ 17'
 HEMLOCK 9" N W 12.4'

15

SOUTH BET 15-16

BEGIN AS STONE SEC
CORE 9, 10, 15, 16763.1 SET FLAG FOR
TRIANGULATING
LAKE ENTER4988
798.1 LEAVE LAKE
HUB FROM WHICH
OFF SET FOR
TRIANGULATION.
135.7' TURNED
75° 20'2634.5 TO SECPOST
VERY OLD IN LAKE
WEST OF RANDOMLINE 0.2'
IN CENTER OF INLET
BETWEEN BASS AND
LONG LAKES2878 ENTER BAY
2970 LEAVE BAY
ENTER LAKE

16

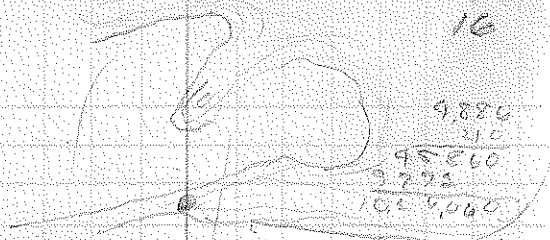
3528.4 SET FLAG FOR A
3230 TO LAKETURNED
Δ 78° 56' BET
HUBS - OFF SET
210.0'4254.4 HUB FROM WHICH
OFF SET WEST
510 FOR Δ

4232.0 LEAVE LAKE (BASS)

4441.0 LOT LAKE ROAD

5084.0 TURNED RT OFF
BACK TAN 38.393° 53' TO STAKE
BTS TO VERIFY -
CORRECT DISTANCE
FROM LAKE

EAST BET 15-52
 BEGIN AT STA 5279.0
 ON RANDOM GET 15-16
 56.3 OFF SET
 NORTH 150.4 FOR TOL &
 60.6 LAKE (LONG)

(Δ 150.4 TURN - $73^{\circ} 51'$)

180 LEAVE LAKE
 650 HEINAMAN COTTAGE
 756 ENTER SAME LAKE
 850 ACROSS TO POINT
 IN LAKE
 700.4 SET FLAG FOR
 TRIANGULATION
 1030 ENTER THE LAKE
 1445 LEAVE LAKE

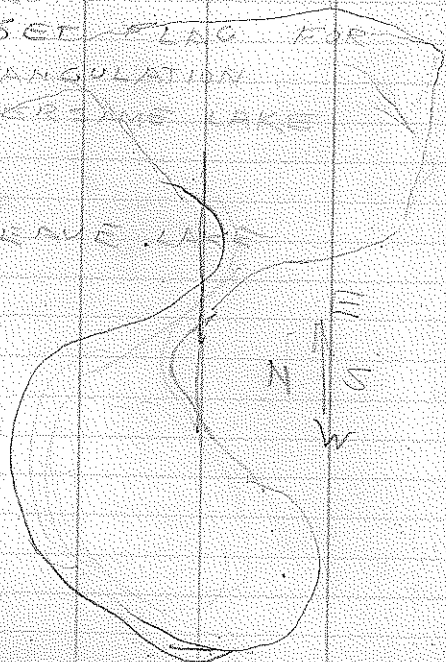

X
 1451.4 OFF SET SOUTH
 232.7
 TURNED $73^{\circ} 47'$
 1460.0 MC - 1.4' NORTH
 OF RANDOM LINE
 (IRON PIPE - WOOD
 STAKE - OLD BUSINESS
 HIGHWAY "B")
 1607
 2355.6 TURNED RT ON
 BACK TAN TO
 MC. SET BY LW.
 STECKBAR (1936)
 $91^{\circ} 35'$ 32.3
 ALSO SET 4 HUB 34
 NORTH OF RANDOM
 LINE WHICH IS ON A
 STRAIGHT LINE WITH
 MC. AND SEC COR.
 5357 LAKE (SEVEN ISLAND)

SOUTH BET 21-31
 BEGIN AT POST
 WHICH IS 2.6 SOUTH
 OF RANDOM BET 15-22
 AT STA. 38.3'
 (STA. BEGINS AT POST)
 350 LAKE (LONG 100'
 EAST [RANDOM])



1098 FIRE LANE (6) N
 1230 SWAMP ENTER
 1453 LEAVE SWAMP
 2642.5 TURNED LT OF H
 BACK TAN. TO
 VERY OLD STAKE
 AND ORIGINAL BT 22.6
 27° 37'

2826 & PROPOSED FIRE
 LANE SSE
 2870 SWAMP
 3046 LEAVE SWAMP
 3220 FIRE LANE PROPOSED
 SW
 3519 FIRE LANE EAST
 OF JUNCTION OF
 PROPOSED FIRE LANE
 200' FIRE SW.

3943 ENTER POND
 4040 LEAVE " "
 POND LIES CHIEFLY
 ON THE EAST
 OF RANDOM LINE



5275.9 TURNED LT.
 96 OFF BACK TAN.
 52855 100' 2' 55.8
 32416 To SEC. CORN
 26437 21, 22, 27, 28
 AS EVIDENCED
 BY ORIGINAL BT
 AND OLD BLAZE
 LINE

3220	1000	0416
6640	26	116
583	10026	125
544		140
2225		2625
		241.6
		222
		222

EAST BET 30-37
BEGIN AT STA 5270.7
ON RANDOM BET
31,50.

1730 ENTER SWAMP
5315 LEAVE " "
2965 ENTER LAKE " "
2964.5 FLAGED FOR " "
3359.9 ON HUB
ACROSS OFF SET
SOUTH 95.9 AND
TURNED 76° 52' BET, W
HOSE ON RANDOM
3700. ENTER OPEN SWAMP
4305. LEAVE " "
5000 HIGHWAY 2 (E)
NORTH 35'
5135 ENTER SWAMP
5355.3 INTER SECT NS
LINE BET 22-23
AT 105+65.3
5360 LEAVE SWAMP

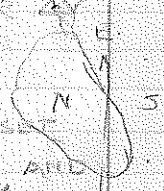

WEST BET 16-21
BEGIN AT STA 5384.0
ON RANDOM BET 15-16

860 OLD HIGH
LAKE MARK
1280 ACROSS E
TO OLD HIGH LINE
1456.2 FIRST LINE N S
2560 TURNED RT NW
OFF FORD, TAN TO
1/4 POST
31° 24' 40.5 W
2700 ENTER SWAMP
3705 LEAVE " "
4100 LAKE NORTH ABOUT
150'
5201.2 TURNED RT OFF
FORD, TAN TO
SEC COR. STAKE -
ORIG. BTS
36.4' 62° 30'

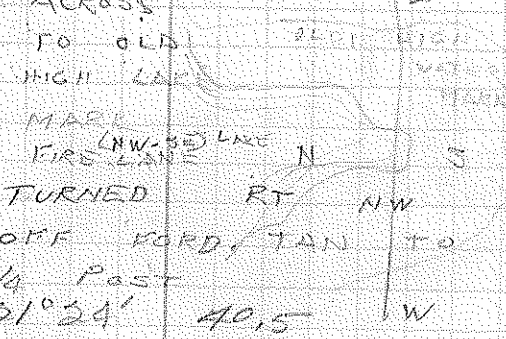

SOUTH BET 25-26

TURNED RT (WEST)

OFF FORWARD TAN TO

FOLLOW SECTION LINE

MORE CLOSELY $0^{\circ} 46'$

OFF N-S RANDOM BET

23-24 ALSO STA 5193.5

BET 25-26

1207.4 FENCE

2025 E HIGHWAY 

5612.6 TURNED RT,

OFF BACK TAN,

$90^{\circ} 6'$ 38.3'

TO IDENTIFIED

4 COR,

53.97.3 TURNED RT OFF

BACK TAN TO IRON

STAKE SECTION COR,

25, 26, 35, 36 END

OF ROAD FROM THE

WEST. ($\frac{1}{2}$ MILE OF ROAD

TO THE EAST PROPOSED)

63.3 $90^{\circ} 45'$

08' S OF \perp TO RANDOM LINE

WEST BET 26-35

BEGIN AT STA 5299.3

ON RANDOM BET (25-26)

TURNED NORTH OF 90° -

50° 28' RUNNING ALONG

ROAD

5593.3 HIGHWAY

44 05.9 OFF SET

SOUTH TO FOLLOW

ROAD 124.6

5530.3 TURNED RT

OFF BACK TAN,

97° 16' 16.3

TO IRON PIPE

ACCEPTED AS

CORNER TO SECS,

36, 27, 34, 35

5571.3 TURNED RT (NW)

OFF ROAD TAN

TO INTERSECTION OF

ROADS 19° 15'

23.3'

SOUTH BET 35-36

OFF SET EAST AT

STA 5399.3 ON RANDOM

BET 25-26 - 80.0 TO

RUN IN OPEN FIELD,

NORTH OF IRON STAKE

(8') - 16.9'

1319.7 OFF SET WEST

25.65 TO FOLLOW

FENCE LINE 67° 52'

9.11

3700.6 TURNED RT SW. OFF

FAD INTO KENCE CORNERS

ACCEPTED AS 4

58° 34' - 5.4' FT.

3165 ENTER PRAIRIE

3266 LEAVE "

4171.9 OFF SET EAST

134.4'

5596.0 TURNED LEFT

TO SEC COR STAKE

OFF BACK TAN

(NW) 85° 45' 179.8'

ONE FOOT BELOW TOP OF

ROAD

NORTH BET 26-27
 TURNED 95° 30'
 OFF RANDOM BET
 26,35

1366 E ROAD TO FIRE
 TOWER.

1379. 13.1 WEST TO
 CONCRETE POST (?)

2622.6 TEMPORARY APPROX
 STAKE WEST 22.2

4086 ENTER SWAMP.

4700 LEAVE ')

5309.1 INTERSECT E-W
 LINE BET 33-37
 AT 5248.2

SOUTH BET 35-39

BEGIN AT 00+0 = 5230.3

SAME AS (N-S) LINE
 0+15.8 2.75' WEST OF
 RANDOM

2050 STREAM - FALLS
 FROM HEAVY RAINS.

2718.2 TURNED LT OFF
 BACK TAN. TO
 1/4 SEC COR STAKE

AND IRON PIN,
 60° 45' 4.0'

4046.1 1/8 POST WEST 17

5276.4 TURNED RT WEST
 OFF FORWARD TAN TO
 SEC. COR STONE
 13° 16' 102.1'

WEST BET 27-34

BEGIN AT STA 16.1
ON N-S RANDOM BET
34-35 (27 EAST OF 18012
STAKE)

1853 ENTER SWAMP

1977 LEAVE "

2492.8 OFF SET SOUTH

FOR Δ 134.4'

2484 TO POND

(TURNED $57^{\circ} 26'$

BET, HUBS ON RANDOM

MEASUREMENTS = 5653.5

3700 LAKE SOUTH 90'

3942 ENTER SWAMP,

5025 LEAVE "

5379.1 TURNED SOUTH ON
RANDOM

SOUTH BET 33-34

BEGIN AT STA 5379.1

BET 37-39

2160 ENTER SWAMP

2455 LEAVE "

3390 ENTER EAST EDGE
OF ^{OPEN} SWAMP

3600 LEAVE EAST EDGE OF
OPEN SWAMP

5254.9 TURN LT OFF FORD

TAN $24^{\circ} 18'$ TO

SEC COR STONE

148.0

WEST BET 28-33

BEGIN STA 53479.1 ON
RANDOM BET 37-39 (LINE EXTEND)

1105 ENTER OPEN SWAMP

1335 LEAVE " "

1740 SMALL POND ON NORTH

20'

2600 SMALL POND ON SOUTH

50'

4819 FIRE LANE SW-NE

5105 ENTER OPEN SWAMP

5097.5 TURNED LT OFF

FORWARD TAN. $9^{\circ} 52'$

159.7 TO SEC

COR POST

SOUTH BET 37-38

BEGIN AT STA 5375.9

ON RANDOM BET 32-31

65 ENTER SMALL SWAMP

140 LEAVE " "

1375 AN OLD $\frac{1}{8}$ STAKE

?

WEST 38' A WATER

HOLE BRO EAST

ABOUT 10' HIGH

AT THIS TIME

2000 ENTER SWAMP

2380 LEAVE " "

4050 SWAMP ON THE WEST

4600 END SWAMP " " "

5269.9 INTERSECT E-W

LINE BET 27-39

AT STA 5314.9

WEST BET ~~21-30~~
 BEGIN STA 5275.9⁰⁰ ON
 RANDOM BET 27-30
 THIS POINT COMMON TO
 ALL RANDOM LINES
 55 ENTER SWAMP
 181 LEAVE " "
 592 \times FIRE LANE WSW
 665 ENTER SWAMP
 915 ENTER POND
 1193. LEAVE POND
 1150.0 OFF SET FOR
 \triangle FLAG ON EAST
 910.8
 OFF SET 137.2 \times 60° 51'
 2213 NORTH END OF TURTLE
 5211.9 FLAG FOR G
 5761.9 HUB ACROSS OFF SET
 5782 \rightarrow SOUTH 275.6' \times 63° 23'
 LEAVE LAKE.
 8543 ENTER SWAMP
 (NARROW)
 5300 LEAVE NARROW SWAMP

5377.5 TURNED N.E. OFF
 LT. OFF
 OFF BACK TAN.
 TO ORIGINAL SEC
 COR. - STAKE AND
 ORIGINAL BT
 41° 55' 51.6

NORTH BET 16-17

TURNED 90° NORTH OFF
STA 5301.2 ON RANDOM
OFF 16.21

3367 E FIRE LANE E-W
3720 E CREEK WSW 3'
3000 LARGE LAKE EAST
ABOUT 450'

4675 ENTER SWAMP

5323.3 WEST OF COR.
STONE 09'

WEST BET 17-20

TURNED 90° OFF
3716 ON RANDOM BET 16-17
TURNED LT TO STONE
OFF SAME STA 17° 12'
17.0' OFF FORWARD TAN

1620 TAN TO CURVE IN FIRE
LANE

3080 FIRE LANE ENE-SW

3900 SMALL LAKE ABOUT 4
MILE SOUTH

5354.8 INTERSECT N.S AT
STA 10731.3

SOUTH BET 20-21

BEGIN AT STA 16.4 ON

RANDOM BET 17-20

NORTH OF EX-ONE 5.0'

STA 2639.0 TURNED RT (SW) OFF

FORD TAN $64^{\circ} 31'$

TO OLD $\frac{1}{4}$ POST 43.0

5115 ENTER SWAMP

5417 LEAVE "

5406.5 TURNED LT OFF

BACK TAN. TO ORIGINAL

SEC COR (SW) $82^{\circ} 23'$

133.0

SOUTH BET 28-29
OFF STA 5377.5
ON RANDOM BET 21-28

3607.2 TURNED RT EAST
OFF BACK TAN
TO $\frac{1}{4}$ COR STAKE
6.4' 90° 44'

TWO SMALL LAKES WEST
OF $\frac{1}{4}$ ABOUT $\frac{1}{4}$ AND $\frac{1}{2}$
MILES RESPECTIVELY

3967 ENTER WET MARSH

3967.6 SET FLAG FOR
 \triangle 80° 15' 99.9

4534.2 HOB ACROSS

4500 LEAVE WET MARSH

5133.4 TURNED RT OFF
FORD TAN. SE
TO SEC COR
113.0' 10° 35'

SOUTH BET
33-33 CONTINUING
RANDOM BET (28-29) FROM
STA 5133.4

0130 ENTER MARSH

530 LEAVE "

560 E FIRE LANE NE-
S-W

2659 ENTER SWAMP

2806.2 TURNED LT OFF

BACK TAN TO

ORIGINAL $\frac{1}{4}$ COR

BT ORIGINAL STAKE

IN MUCK 62.2'

46° 43'

2780 LEAVE SWAMP

3860 ENTER "

3991 LEAVE "

4525 DEEP VALLEY E-W

5300.3 TURNED LT SW

OFF BACK TAN TO

SEC COR STONE

SET BY TOWN OF

RUSTEN 79.4'

135° 00'

WEST BET 20-29
TURNED 91° OFF N-S
LINE BET 29-28
5377.3 = 00+0 ON
RANDOM BET 29-28

1984 LAKE
1483.7 SET FLAG FOR ▲
2200 LEAVE LAKE

2882.1 HUB OFF SET
SOUTH 134.0 TURNED
80° 14' BET HUBS

3400 SMALL LAKE ON THE
SOUTH ABOUT 200'

3635 DEEP RAVINE N-S

4482.6 SET FLAG FOR
▲

4684.1 HUB ACROSS
TURNED 67° 14'
FROM OFF SET
NORTH 85.0
ENTER LAKE 300 E-W
ACROSS 2000' N-S - 700
FROM SOUTH END
1300' FROM NORTH END

4770 LEAVE LAKE

5364.6 TURNED LT. OFF
FORD. TAN TO
ORIGINAL COR 2A.0
21° 56'
BIRCH WITNESS ORIGINAL

SOUTH BET 19-20
CONTINUING RANDOM
BET 17-18 (SEE 1937 NOTES)

10731.2 INTERSECT E-W
LINE AT ^{5354.1} 5454.2 5354.8
(SEE PAGE 36)

11055 FIRE LANE E-W

11171 CREEK (NW FLOW)

12880 ENTER SWAMP

12960 CREEK E-W

13100 LEAVE SWAMP

14600 (E) SHORTER MOST POINT
OF LAKE (EAST)

14940 120' EAST TO LAKE

15993.7 TURNER RT EAST OFF BACK
87° 16' 30.2" TO TAN
ORIGINAL COR

EAST BET 35-36
 BEGIN AT STONE 3° 30' W
 PRAIRIE RIVER
 ACROSS "

5085.4 TURNED RT NE
 OFF BACK TAN TO SEC.
 COR ESTABLISHED BY
 LANGLADE CO.
 125° 12' 359.6'

(1308.75 EACH 1/4 MILE)
 SET ALL 40 STAKES
 1/4 = NORTH 1060.5 OFF
 STA OFF STA 3617.5

WEST BET 18, 19

BEGIN AT STA 5364.6
 ON RANDOM BET 20-17

100 SWAMP
 578 CREEK RUNS N.W.
 330 LEAVE SWAMP
 369 FIRE LANE NW-SE
 1010 SWAMP
 1139.5 TO FLAG FOR A
 1155 LAKE. TURN
 1469.9 136.2 67° 36
 1460 LEAVE LAKE
 (RANDOM CROSSES
 SOUTH POINT OF
 FAIR SIZED LAKE)
 5437.0 TURNED RT (NORTH)
 OFF TAN.
 101° 13' 42.5
 TO SEC COR. POST

87

X

SOUTH BET 13-18
 BEGIN AT STONE MARKERS

95 ENTER SWAMP
 225 LEAVE "
 2509.8 TURNED LT WEST
 OFF BACK TAN TO
 NOT $\frac{1}{10}$ $\frac{1}{10}$ $\frac{1}{10}$ STAKE QUESTION-
 ABLE. 99°06' 21.8'
 2580 E FIRE LANE E W
 3234 ENTER SWAMP
 3650 CREEK E-W 8' WIDE
 4670 LEAVE SWAMP
 5250.9 TURNED LT. (WEST)
 OFF BACK TAN TO
 OLD POST 44.5
 84°55'

SOUTH BET 19-24
 TURNED SOUTH OFF
 STA. 5437.0 ON RANDOM BET
 18-19

8 / TS4N R7E

EAST BET 13-24

CONTINUING RANDOM BET
18, 19.

580 CREEK N-S 10' WIDE
603 LEAVE SWAMP
720 ENTER "
1324 SOUTH 5.3 TO $\frac{1}{8}$ FOOT
1455 LEAVE SWAMP
2043 ENTER "
2218 LEAVE "
3514 ENTER "
3900 LEAVE
4066 CREEK 2' WIDE FLOWS
SOUTH
4266 ENTER SWAMP
4383 LEAVE "
4850 ENTER "
5000 LEAVE
5132.0 TURNED LT (SW) OFF
FORD, TAN TO CONCRETE
SBC COR POST
54° 30' 9.0'
FENCE LINE TO IT

51 T34N R7E

NORTH BET
SEC 13-14 OFF STA
5132.0 BET 13-24 T34N R7E

705 ENTER SWAMP
1030 LEAVE " "
1317 FIRE LINE
E-W
5616.7 TURNED LT OFF
BACK TAN. NE
55.0' 105° 40'
TO OLD & PART
FENCE LINES TO IT
4500 ENTER OPEN SWAMP
4383 LEAVE " "
4708 CREEK 1' FLOWS
WEST
5173.7 TURNED RT NE
TO COR STONE SET
1937 (see notes)
47° 52' 143.0'

63° 50'
52 12.5
T34N R7E 51

SOUTH BET 23-24
OFF STA 5132 BET 13,24
EW RANDOM

840 ENTER SWAMP,
1895 CREEK FLOWS SWAMP
1995 CREEK DIVERGENT WEST
3270 LEAVE SWAMP
4303 CREEK FLOWS WNW 2'
5573.5 TURNED LT ^{OFF BACK TAN} 63° 50'
(NW) 39.8' TO OLD
STAKE CORRECT DIST.
TO LEAVE SWAMP EAST
OLD B.T.S AND OLD
BLAZE LINES TO IT

SOUTH BET 35-36

CONTINUING FROM STA

5575.5 ON RANDOM

BET 23-24

SET FLAG FOR

5705.0 POND (LONG - E-W)

3800.0 ACROSS POND

2860.7 DIF SET EAST

90.6 AND α $61^{\circ} 18'$

3505 ENTER SWAMP

3535 LEAVE "

5304.6 END OF RANDOM

4539 ROAD E-W

SOUTH BET 35-36

BEGIN AT STA 5304.6

CONTINUING RANDOM

458.2 OFF SET WEST

111.2 TO ROAD

AND SOUTH (TO

OF ROAD 103')

5871.4 TURNED RT (WEST)

OFF FORD TAN TO

FOLLOW α ROAD $2^{\circ} 50'$ 5433.7 TURNED RT $88^{\circ} 35'$

11.5'

TO SECTION CORN

55 BEU T SAN T 33 N

EAST BET 36-1
BEGIN AT STONE AND
LINED UP WITH ROAD
TO THE WEST
LEAST ALONG OLD
ABANDONED ROAD

1329 AN IRON STAKE
7.0' NORTH

2678.4 TURNED RT (NW)
OFF BACK TAN TO
STONE 35° N
57.3'

3448 E OFF POOR ROAD
WHICH NEARLY FOLLOWS
THE SECTION LINE
NE-SW

5300.0 TURNED RT (NW)
OFF BACK TAN
TO TOWNSHIP COR
STONE AT SOUTH -
WEST COR OFF SMALL
WATER HOLE 5.2'
79° 30'

NORTH BET 36-31
ON RANGE LINE 56

BEGIN AT STA 5300.0
ON RANDOM BET 36-1

275 SWAMP
372 LEAVE SWAMP

430 E ROAD E.W.

965 SWAMP

1060 LEAVE SWAMP

1675 POND (HIGH WATER)

1685.5 SET FLAG FOR Δ

1933 LEAVE LAKE

1949.2 HUB OFF SET

WEST 53.9 TURNS
70° 35'

2635.5 TURNED LT OFF
BACK TAN TO 1/2
STAKE - BLAZE
LINE TO IT.

19.2 90° 6'

3955 E POST EAST 15.0'

5115 E OLD ROAD E.W.

5580 TURNED RT OFF
FOOD TAN 86° 43'
15.4
TO POST

36-35

OFF STA 52 80 ON
RANDOM BET 31-36

32 SMALL SWAMP

80 LEAVE "

3260 E OLD ROAD

3553.8 TURNED RT (NW)
OFF FORD TAN 50°30'

75.7' To OLD

STAKE END

ORIGINAL B.T.

2945 E OLD ONE LANE ROAD

3136 E " " " "

4050 OPEN SWAMP 300'

ACROSS - SOUTH 40'

5152 INTERSECT N-S LINE

AT 153.2

5182.4 TURNED LT SW

OFF FORD TAN TO

SEC COR STAKE

43.7' 27°35'

30



30-31

BEGIN AT STA 5280

BET 31-36

3637.6 TURNED RT. OFF

BACK TAN, 83°

30' 26.6' NORTH

TO OLD STAKE -

STUMPS LIKELY B.T.S.

3165 ENTER SWAMP

3300 LEAVE "

3700 ROAD N-S

3825 SMALL SWAMP

3950 LEAVE SWAMP

6475.8 END OF RANDOM

SOUTH BET 31-32
 TURNED SOUTH OFF STA
 5279.8 ON RANDOM BET
 80.31
 280 ENTER SMALL SWAMP
 365 LEAVE " "
 730 ENTER SMALL SWAMP
 875 LEAVE " "
 1005 SMALL SWAMP
 1067 LEAVE " "
 RUNNING ON OLD BLAZE LINE
 3215 ENTER SWAMP
 3385 LEAVE " "
 1973 LOGGING ROAD
 2530 ENTER SWAMP
 2605 LEAVE " "
 2626.9 TURNED RT (E) OFF FORD
 TANGENT TO OLD
 STAKE RT TO IT
 18.3 76° 41'
 3385 ENTER WEST END
 OF LARGE SWAMP
 3540 LEAVE SWAMP
 4778 ENTER OPEN MARCH
 4968 LEAVE " "

5279.9

TURNED

RT OFF FORWARD
 TAN TO SEC
 COR. AND OLD STAKE " "
 STONE 3 "
 OFF STONE SHOWING
 51.0' 71° 30' NG
 (LINE BLAZE ON DEAD
 TREES WEST 100' OF
 STONE VERY CONFUSING

NORTH BET 29-30
 TURNED NORTH OFF
 STA 5479.8 ON RANDOM
 BET 30-31

130 WATER HOLE

509 LEAVE " "

550 ENTER SWAMP

675 LEAVE

1435 ENTER OPEN MARSH
 BR3 WEST

1502 LEAVE MARSH

2640 LAKE (SMALL) EAST
 ABOUT 275'

3637.5 TURNED RT OFF FORD
 TAN TO OLD PIPE
 STAKE AND IRON PIPE
 7' LONG 55° 30'
 31.7'

3845 ENTER OPEN SWAMP

3968 LEAVE

5303.2 TURNED LT OFF

BACK TAN TO
 STONE ORIG COR
 44.7 91° 50'

(SEE SOL CORRS
 PAGE 41.)

WEST BET 19-30

TURNED WEST OFF STA.
 5303.2 ON RANDOM
 BET 29-30

0400 NARROW SWAMP E-W

201 LEAVE " MAIN SWAMP

IS ON THE SOUTH WEST

205 40' SOUTH TO SWAMP

810 SWAMP SMALL

915 LEAVE " "

SWAMP ON THE NORTH

1400 (100) 500' X 300' E-W

2566.0 TURNED RT IN W OFF

FORD TAN 52° 30'

30.5' TO ORIGINAL

& COR RANDOM

LINE FOLLOWED OLD

BLAZES ALL THE

WAY ORIGINAL C&K

RT

3717 ENTER OPEN MARSH

3910 LEAVE " "

5436.3 TURNED RT OFF

BACK TAN 90° 30'

14.6' TO OLD

STAKE OLD BLAZE

LINE TO IT

NORTH BET 25,30
 BEGIN AT 5280 ON
 RANDOM BET 31,36,
 356 ENTER SMALL SWAMP
 290 LEAVE " "
 3850 SLOUGH LAKE
 3872 LEAVE " "
 4955 ASH SWAMP BRS E-W
 3190 LEAVE "
 3583 ENTER SPRUCE SWAMP
 3670 LEAVE " "
 3735 ENTER " "
 3900 POND 80' WEST 300'
 ACROSS (ROUND
 4038 LEAVE
 5286.9 HUB TURNED RT OFF
 FORD TAN. TO SEC
 POST 67° 4' 37.9

EAST BET 24 25

BEGIN AT STA 5375.5
 BET 23-24
 350 OPEN MARSH
 430 LEAVE "
 600 ENTER SWAMP
 720 LEAVE "
 1955 ENTER SWAMP
 2240 LEAVE "
 5310.7 TURNED RT OFF BACK
 TAN TO SEC POST
 91° 51' 56.6

NORTA BET 19-24

TURNED OFF STA

5136.3 BET 19-20

223 ENTER SWAMP

525 LEAVE SWAMP

1924 CREEK FLOWS WEST

5261.2 TURNED EAST 71

90° 7.1' TO STONE

~~5656.8~~~~37.9~~~~18.9~~

5261.2

14.6

5296.6

5623.3

14.6

5637.7

~~OFF SET EAST 3.5~~~~MOUNDED WITH STONE~~

X

EAST BET.
29-35

BEGIN AT STA. 54 798
ON RANDOM BET 30, 31

1010 SWAMP
1175 LEAVE SWAMP
2060 ENTER "
2150 LEAVE "
3470 ENTER "
3640 LEAVE "
3160 ENTER "
3655 LEAVE "
4450 ENTER "
4919.2 TURNED LT.
OFF FORD TANK,
0° 50' 306.5
TO SEC COR POST

SET SEC
CORS

~~21, 22, 27, 28 AS
EVIDENCE BY OLD
ORIGINAL BT STUMP
(BIRCH NE) BLAZE
LINE TO IT~~

~~BUILT A POINT INTO SWAMP
BARGE BARROW PIT ON
NORTH SIDE OF SWAMP
STONE SET 10' SOUTH
IN SWAMP~~

OAK 6" N 77 E 56.8
OAK 7" S 76 E 31.3
OAK 12" N 52 W 46.4

STONE SUBJECT TO FLOODING



TO PURCHASE
~~PIPE FOR RANGE POLE~~
~~SHELL BAG~~
25 shells
~~BIKYLE TIRES~~

TO ORDER
TACKS
BRAYON (WATER PROOF
PENCILS (2H)
FISH LINE

SET $\frac{1}{4}$ STONE
 BET 25-26
 AS EVIDENCED BY
 FENCE CORNERS AND
 TESTIMONY OF FARMER.
 HE POINTED OUT THE
 ORIGINAL BTS WHICH
 WERE NOW TOO ROTEN
 TO RECOGNIZE BUT
 SPECIES AND DISTANCES
 WERE CORRECT

PINE STUMP 40" N 35 E 43.8
 MAPLE 10" N 15 W 105.2

MOUNDEN WITH STONE

