

LINCOLN COUNTY LAND CORNER MONUMENTS

T 35 N, R 4 E

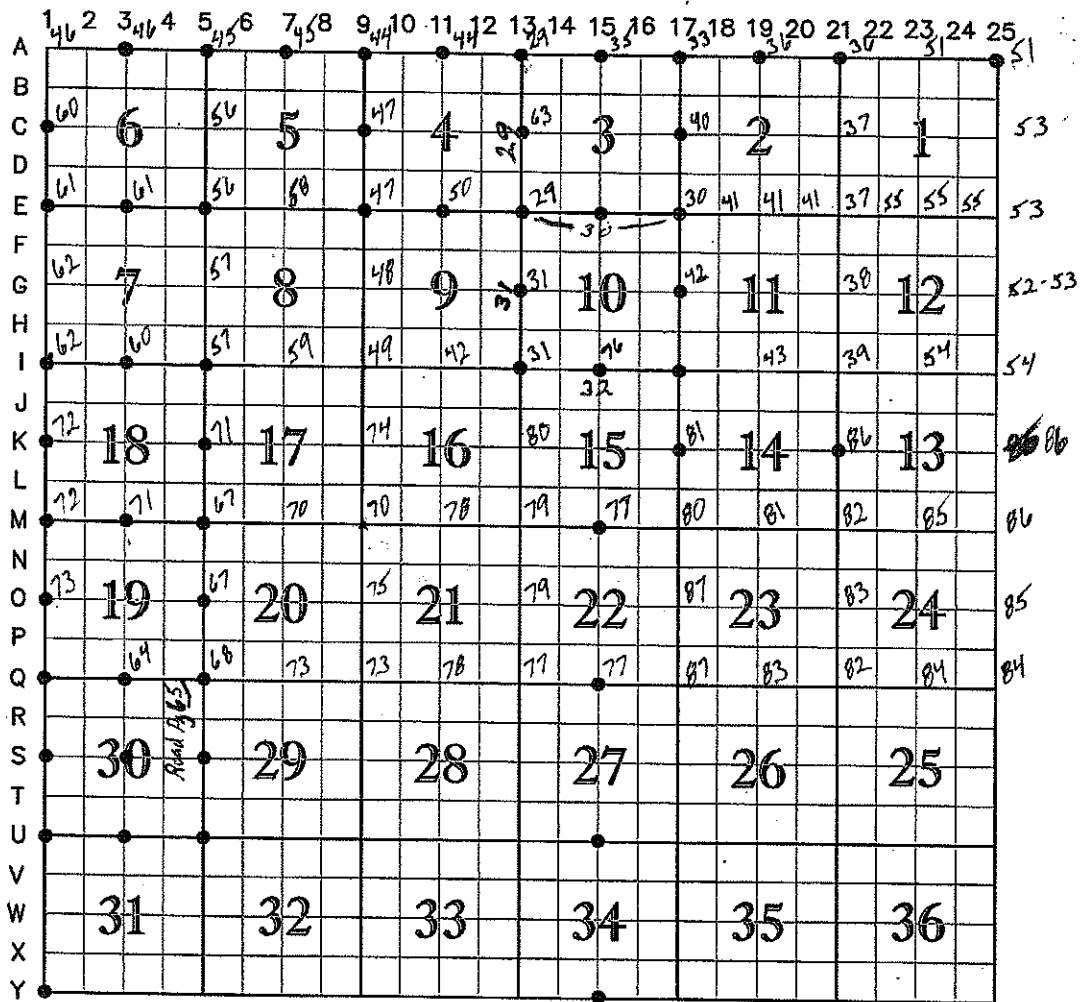

• = Corner monumented and record contained herein.
 Corners such as meander corners which are not located at intersecting lines on the above diagram are identified by reference to adjoining applicable coordinate lines.
 EX: AB-1, QR-19, S-18,19

T 35 N, R 4 E

Field Notes

"
6 A

Town of Somo.
Lincoln County

Gauge at B.S. Island
 6/27/91 = 5.46 6.00 up river = 6.01
 B.S. Main River Gauge 10303
 Water 10.175
 11.200 10.1005
 150 ft. (S.E.) of main B.S. Island
 (only 1/2 island across channel
 B.S. Island)

100 ft. from E. side bridge south
 400 ft. long
 5 ft. from E. side of main
 as bridge runs down bridge

Water readings
 Main River 103.03
 Channel 101.25
 B.S. River 101.78
 4.05
 97.73
 97.65
 97.0850
 104.05
 101.78
 22.27
 107.00
 50.1
 97.95

Survey of Land Leased to
 N. K. Kinnear & Co. (See Map)
 Baynes Mill Camp of C. N. W. Depot
 ground on E. side parallel and
 S. side of bridge across the
 Eastern Channel of the River
 running west across said channel
 along the S. side of said bridge
 to a point ^{over bridge} at the center of the
 unloading track of the Canada
 Co. 46 ft and 3 ft 2" North
 of Section 13 to Cornering
 North between the C. N. W. Depot
 Section (on lots 5-35-29-78)
 along S. W. along the unloading track to
 a point 245 ft ^{from} along S. W.
 along the ^{1st} ^{2nd} ^{3rd} ^{4th} ^{5th} ^{6th} ^{7th} ^{8th} ^{9th} ^{10th} ^{11th} ^{12th} ^{13th} ^{14th} ^{15th} ^{16th} ^{17th} ^{18th} ^{19th} ^{20th} ^{21st} ^{22nd} ^{23rd} ^{24th} ^{25th} ^{26th} ^{27th} ^{28th} ^{29th} ^{30th} ^{31st} ^{32nd} ^{33rd} ^{34th} ^{35th} ^{36th} ^{37th} ^{38th} ^{39th} ^{40th} ^{41st} ^{42nd} ^{43rd} ^{44th} ^{45th} ^{46th} ^{47th} ^{48th} ^{49th} ^{50th} ^{51st} ^{52nd} ^{53rd} ^{54th} ^{55th} ^{56th} ^{57th} ^{58th} ^{59th} ^{60th} ^{61st} ^{62nd} ^{63rd} ^{64th} ^{65th} ^{66th} ^{67th} ^{68th} ^{69th} ^{70th} ^{71st} ^{72nd} ^{73rd} ^{74th} ^{75th} ^{76th} ^{77th} ^{78th} ^{79th} ^{80th} ^{81st} ^{82nd} ^{83rd} ^{84th} ^{85th} ^{86th} ^{87th} ^{88th} ^{89th} ^{90th} ^{91st} ^{92nd} ^{93rd} ^{94th} ^{95th} ^{96th} ^{97th} ^{98th} ^{99th} ^{100th} ^{101st} ^{102nd} ^{103rd} ^{104th} ^{105th} ^{106th} ^{107th} ^{108th} ^{109th} ^{110th} ^{111th} ^{112th} ^{113th} ^{114th} ^{115th} ^{116th} ^{117th} ^{118th} ^{119th} ^{120th} ^{121st} ^{122nd} ^{123rd} ^{124th} ^{125th} ^{126th} ^{127th} ^{128th} ^{129th} ^{130th} ^{131st} ^{132nd} ^{133rd} ^{134th} ^{135th} ^{136th} ^{137th} ^{138th} ^{139th} ^{140th} ^{141st} ^{142nd} ^{143rd} ^{144th} ^{145th} ^{146th} ^{147th} ^{148th} ^{149th} ^{150th} ^{151st} ^{152nd} ^{153rd} ^{154th} ^{155th} ^{156th} ^{157th} ^{158th} ^{159th} ^{160th} ^{161st} ^{162nd} ^{163rd} ^{164th} ^{165th} ^{166th} ^{167th} ^{168th} ^{169th} ^{170th} ^{171st} ^{172nd} ^{173rd} ^{174th} ^{175th} ^{176th} ^{177th} ^{178th} ^{179th} ^{180th} ^{181st} ^{182nd} ^{183rd} ^{184th} ^{185th} ^{186th} ^{187th} ^{188th} ^{189th} ^{190th} ^{191st} ^{192nd} ^{193rd} ^{194th} ^{195th} ^{196th} ^{197th} ^{198th} ^{199th} ^{200th} ^{201st} ^{202nd} ^{203rd} ^{204th} ^{205th} ^{206th} ^{207th} ^{208th} ^{209th} ^{210th} ^{211st} ^{212nd} ^{213rd} ^{214th} ^{215th} ^{216th} ^{217th} ^{218th} ^{219th} ^{220th} ^{221st} ^{222nd} ^{223rd} ^{224th} ^{225th} ^{226th} ^{227th} ^{228th} ^{229th} ^{230th} ^{231st} ^{232nd} ^{233rd} ^{234th} ^{235th} ^{236th} ^{237th} ^{238th} ^{239th} ^{240th} ^{241st} ^{242nd} ^{243rd} ^{244th} ^{245th} ^{246th} ^{247th} ^{248th} ^{249th} ^{250th} ^{251st} ^{252nd} ^{253rd} ^{254th} ^{255th} ^{256th} ^{257th} ^{258th} ^{259th} ^{260th} ^{261st} ^{262nd} ^{263rd} ^{264th} ^{265th} ^{266th} ^{267th} ^{268th} ^{269th} ^{270th} ^{271st} ^{272nd} ^{273rd} ^{274th} ^{275th} ^{276th} ^{277th} ^{278th} ^{279th} ^{280th} ^{281st} ^{282nd} ^{283rd} ^{284th} ^{285th} ^{286th} ^{287th} ^{288th} ^{289th} ^{290th} ^{291st} ^{292nd} ^{293rd} ^{294th} ^{295th} ^{296th} ^{297th} ^{298th} ^{299th} ^{300th} ^{301st} ^{302nd} ^{303rd} ^{304th} ^{305th} ^{306th} ^{307th} ^{308th} ^{309th} ^{310th} ^{311st} ^{312nd} ^{313rd} ^{314th} ^{315th} ^{316th} ^{317th} ^{318th} ^{319th} ^{320th} ^{321st} ^{322nd} ^{323rd} ^{324th} ^{325th} ^{326th} ^{327th} ^{328th} ^{329th} ^{330th} ^{331st} ^{332nd} ^{333rd} ^{334th} ^{335th} ^{336th} ^{337th} ^{338th} ^{339th} ^{340th} ^{341st} ^{342nd} ^{343rd} ^{344th} ^{345th} ^{346th} ^{347th} ^{348th} ^{349th} ^{350th} ^{351st} ^{352nd} ^{353rd} ^{354th} ^{355th} ^{356th} ^{357th} ^{358th} ^{359th} ^{360th} ^{361st} ^{362nd} ^{363rd} ^{364th} ^{365th} ^{366th} ^{367th} ^{368th} ^{369th} ^{370th} ^{371st} ^{372nd} ^{373rd} ^{374th} ^{375th} ^{376th} ^{377th} ^{378th} ^{379th} ^{380th} ^{381st} ^{382nd} ^{383rd} ^{384th} ^{385th} ^{386th} ^{387th} ^{388th} ^{389th} ^{390th} ^{391st} ^{392nd} ^{393rd} ^{394th} ^{395th} ^{396th} ^{397th} ^{398th} ^{399th} ^{400th} ^{401st} ^{402nd} ^{403rd} ^{404th} ^{405th} ^{406th} ^{407th} ^{408th} ^{409th} ^{410th} ^{411st} ^{412nd} ^{413rd} ^{414th} ^{415th} ^{416th} ^{417th} ^{418th} ^{419th} ^{420th} ^{421st} ^{422nd} ^{423rd} ^{424th} ^{425th} ^{426th} ^{427th} ^{428th} ^{429th} ^{430th} ^{431st} ^{432nd} ^{433rd} ^{434th} ^{435th} ^{436th} ^{437th} ^{438th} ^{439th} ^{440th} ^{441st} ^{442nd} ^{443rd} ^{444th} ^{445th} ^{446th} ^{447th} ^{448th} ^{449th} ^{450th} ^{451st} ^{452nd} ^{453rd} ^{454th} ^{455th} ^{456th} ^{457th} ^{458th} ^{459th} ^{460th} ^{461st} ^{462nd} ^{463rd} ^{464th} ^{465th} ^{466th} ^{467th} ^{468th} ^{469th} ^{470th} ^{471st} ^{472nd} ^{473rd} ^{474th} ^{475th} ^{476th} ^{477th} ^{478th} ^{479th} ^{480th} ^{481st} ^{482nd} ^{483rd} ^{484th} ^{485th} ^{486th} ^{487th} ^{488th} ^{489th} ^{490th} ^{491st} ^{492nd} ^{493rd} ^{494th} ^{495th} ^{496th} ^{497th} ^{498th} ^{499th} ^{500th} ^{501st} ^{502nd} ^{503rd} ^{504th} ^{505th} ^{506th} ^{507th} ^{508th} ^{509th} ^{510th} ^{511st} ^{512nd} ^{513rd} ^{514th} ^{515th} ^{516th} ^{517th} ^{518th} ^{519th} ^{520th} ^{521st} ^{522nd} ^{523rd} ^{524th} ^{525th} ^{526th} ^{527th} ^{528th} ^{529th} ^{530th} ^{531st} ^{532nd} ^{533rd} ^{534th} ^{535th} ^{536th} ^{537th} ^{538th} ^{539th} ^{540th} ^{541st} ^{542nd} ^{543rd} ^{544th} ^{545th} ^{546th} ^{547th} ^{548th} ^{549th} ^{550th} ^{551st} ^{552nd} ^{553rd} ^{554th} ^{555th} ^{556th} ^{557th} ^{558th} ^{559th} ^{560th} ^{561st} ^{562nd} ^{563rd} ^{564th} ^{565th} ^{566th} ^{567th} ^{568th} ^{569th} ^{570th} ^{571st} ^{572nd} ^{573rd} ^{574th} ^{575th} ^{576th} ^{577th} ^{578th} ^{579th} ^{580th} ^{581st} ^{582nd} ^{583rd} ^{584th} ^{585th} ^{586th} ^{587th} ^{588th} ^{589th} ^{590th} ^{591st} ^{592nd} ^{593rd} ^{594th} ^{595th} ^{596th} ^{597th} ^{598th} ^{599th} ^{600th} ^{601st} ^{602nd} ^{603rd} ^{604th} ^{605th} ^{606th} ^{607th} ^{608th} ^{609th} ^{610th} ^{611st} ^{612nd} ^{613rd} ^{614th} ^{615th} ^{616th} ^{617th} ^{618th} ^{619th} ^{620th} ^{621st} ^{622nd} ^{623rd} ^{624th} ^{625th} ^{626th} ^{627th} ^{628th} ^{629th} ^{630th} ^{631st} ^{632nd} ^{633rd} ^{634th} ^{635th} ^{636th} ^{637th} ^{638th} ^{639th} ^{640th} ^{641st} ^{642nd} ^{643rd} ^{644th} ^{645th} ^{646th} ^{647th} ^{648th} ^{649th} ^{650th} ^{651st} ^{652nd} ^{653rd} ^{654th} ^{655th} ^{656th} ^{657th} ^{658th} ^{659th} ^{660th} ^{661st} ^{662nd} ^{663rd} ^{664th} ^{665th} ^{666th} ^{667th} ^{668th} ^{669th} ^{670th} ^{671st} ^{672nd} ^{673rd} ^{674th} ^{675th} ^{676th} ^{677th} ^{678th} ^{679th} ^{680th} ^{681st} ^{682nd} ^{683rd} ^{684th} ^{685th} ^{686th} ^{687th} ^{688th} ^{689th} ^{690th} ^{691st} ^{692nd} ^{693rd} ^{694th} ^{695th} ^{696th} ^{697th} ^{698th} ^{699th} ^{700th} ^{701st} ^{702nd} ^{703rd} ^{704th} ^{705th} ^{706th} ^{707th} ^{708th} ^{709th} ^{710th} ^{711st} ^{712nd} ^{713rd} ^{714th} ^{715th} ^{716th} ^{717th} ^{718th} ^{719th} ^{720th} ^{721st} ^{722nd} ^{723rd} ^{724th} ^{725th} ^{726th} ^{727th} ^{728th} ^{729th} ^{730th} ^{731st} ^{732nd} ^{733rd} ^{734th} ^{735th} ^{736th} ^{737th} ^{738th} ^{739th} ^{740th} ^{741st} ^{742nd} ^{743rd} ^{744th} ^{745th} ^{746th} ^{747th} ^{748th} ^{749th} ^{750th} ^{751st} ^{752nd} ^{753rd} ^{754th} ^{755th} ^{756th} ^{757th} ^{758th} ^{759th} ^{760th} ^{761st} ^{762nd} ^{763rd} ^{764th} ^{765th} ^{766th} ^{767th} ^{768th} ^{769th} ^{770th} ^{771st} ^{772nd} ^{773rd} ^{774th} ^{775th} ^{776th} ^{777th} ^{778th} ^{779th} ^{780th} ^{781st} ^{782nd} ^{783rd} ^{784th} ^{785th} ^{786th} ^{787th} ^{788th} ^{789th} ^{790th} ^{791st} ^{792nd} ^{793rd} ^{794th} ^{795th} ^{796th} ^{797th} ^{798th} ^{799th} ^{800th} ^{801st} ^{802nd} ^{803rd} ^{804th} ^{805th} ^{806th} ^{807th} ^{808th} ^{809th} ^{810th} ^{811st} ^{812nd} ^{813rd} ^{814th} ^{815th} ^{816th} ^{817th} ^{818th} ^{819th} ^{820th} ^{821st} ^{822nd} ^{823rd} ^{824th} ^{825th} ^{826th} ^{827th} ^{828th} ^{829th} ^{830th} ^{831st} ^{832nd} ^{833rd} ^{834th} ^{835th} ^{836th} ^{837th} ^{838th} ^{839th} ^{840th} ^{841st} ^{842nd} ^{843rd} ^{844th} ^{845th} ^{846th} ^{847th} ^{848th} ^{849th} ^{850th} ^{851st} ^{852nd} ^{853rd} ^{854th} ^{855th} ^{856th} ^{857th} ^{858th} ^{859th} ^{860th} ^{861st} ^{862nd} ^{863rd} ^{864th} ^{865th} ^{866th} ^{867th} ^{868th} ^{869th} ^{870th} ^{871st} ^{872nd} ^{873rd} ^{874th} ^{875th} ^{876th} ^{877th} ^{878th} ^{879th} ^{880th} ^{881st} ^{882nd} ^{883rd} ^{884th} ^{885th} ^{886th} ^{887th} ^{888th} ^{889th} ^{890th} ^{891st} ^{892nd} ^{893rd} ^{894th} ^{895th} ^{896th} ^{897th} ^{898th} ^{899th} ^{900th} ^{901st} ^{902nd} ^{903rd} ^{904th} ^{905th} ^{906th} ^{907th} ^{908th} ^{909th} ^{910th} ^{911st} ^{912nd} ^{913rd} ^{914th} ^{915th} ^{916th} ^{917th} ^{918th} ^{919th} ^{920th} ^{921st} ^{922nd} ^{923rd} ^{924th} ^{925th} ^{926th} ^{927th} ^{928th} ^{929th} ^{930th} ^{931st} ^{932nd} ^{933rd} ^{934th} ^{935th} ^{936th} ^{937th} ^{938th} ^{939th} ^{940th} ^{941st} ^{942nd} ^{943rd} ^{944th} ^{945th} ^{946th} ^{947th} ^{948th} ^{949th} ^{950th} ^{951st} ^{952nd} ^{953rd} ^{954th} ^{955th} ^{956th} ^{957th} ^{958th} ^{959th} ^{960th} ^{961st} ^{962nd} ^{963rd} ^{964th} ^{965th} ^{966th} ^{967th} ^{968th} ^{969th} ^{970th} ^{971st} ^{972nd} ^{973rd} ^{974th} ^{975th} ^{976th} ^{977th} ^{978th} ^{979th} ^{980th} ^{981st} ^{982nd} ^{983rd} ^{984th} ^{985th} ^{986th} ^{987th} ^{988th} ^{989th} ^{990th} ^{991st} ^{992nd} ^{993rd} ^{994th} ^{995th} ^{996th} ^{997th} ^{998th} ^{999th} ^{1000th}

Water Surveying

Along East side of go 3.1 ft. 8 inches
to the adjacent property line
shown on survey and property line
36.750 + 50 + 50 + 50 + 64.44 = 830.69 ft
to a Gas Pipe 2"

6/25/21 Run levels on Water
Elevations as follows
Low U.S. Gauge at Port Island
elevation is 6.4 ft. 1 inch

Reading S Side Grand Dam	1165
" " " " "	946
Grand Side - Fall -	225

Reading S Side City Well	880
" West Side of Str 5	
near East End RR Bridge	565
	315

add fall at Scale	77.5
below Port Gauge	540
at Harwood and Port	16.0
	613.5

Water Surveying

6/27 Run levels on factious
U.S. Gaug. Gauge at 57.6

Reading at East Bridge Main Run	101.75
" " " near Island	11.200
a Saloon	
Sum	1,025

Reading on New River dam	103.030
minus difference	1.250
Reading on High	101.780

Reading East End RR Bridge	6.85
near Island Saloon	
on S Side City Well	110.90
difference	4.05

101.780	
4.05	
<u>97.730</u>	as compared to

Gauge on New River
103.03

6/27/21 Comparison to 103.83
 " " 101.78

Reading notes concerning
 Delgad Salazar & Mateo in Panama
 Street

Reading of Bottom of Cellar	10.90
Reading at Mateo top at	9.50
R.P. Bridge on Mough's side	
R. Phunt	
Saturn floor below	140
Mateo	101.78
Bottom of Cellar	<u>100.38</u>

Reading Neumann Pond 10.90
 at State is
 at Mough's side

	6.85
	<u>4.05</u>
Bottom of the Cellar above Neumann Pond	140
	<u>258</u>

6/29/21

as to old Boundary Line
 between Plummer & Stewart
 property lot 5-35-29-7
 Set the factory Pavts.
 at point 76 ft W of S. Corner Bridge
 on point S.W. 295' " "
 " " 177' " "
 " " " " " "
 " " " " " "
 at point S.W. 146 " "
 the latter is 31 ft S and 2' "
 S.W. Corner of Plummer's
 N.W. Corner of Plummer's



200
 58.70
 100
 358.70
 100
 458.70
 81.30
 540.00

336
 84
 420

Beginning SW Corner Block 13

running thence North 25¹/₂°
 set stake at the NW Corner of
 Block 13. Thence East 540 ft.
 to the NE Corner of Block 14.
 Thence East to NW Corner of
 Block 2 Thence East to 400 ft to
 the NE corner of Block 2

Law of Commission 002833

Com E. W. Law of Commission 002833
 Stake - 200.00
 " 58.70
 " 358.70
 " 540.00
 " 300.00
 Thence N 90° along center line 256 ft.
 50 ft. thence East 30 ft. to NW Corner
 Thence S 85° N

10 256
130
126

50
80
250

135
30
165
30
195
30

225-
31
256

6/26/27

11

At J. Lewis on N side of
Flume built along West Side of
Blind 2 - 30 ft
" " 30 "
" " 30 - stairs
" " 31 ft to S from Bent

Top of Sand on Blind 2
Rise 4-10' Magnolia Terrace
East.

Blind 2

Taney of connection Case 0139

Running East on N Side of School
 St from S.W. corner of Block 13
 toward old Hospital Bldg
 1st Curve 100 ft
 2nd Curve 114.85 - 114.85

Inst	B.S.	Δ	F.S.	Dist.
#1	A	180°	#2	144.85
#2	#1	48.14 L	NEE. PERSONAGE	114.25
		123.39 L	NW. NEW HOS. NW X	145.3

Vetter Mfg. Co.

Sept. 10th 1922

From Sec. Corner of 34 & 35 on South County line in Range 8 E. ran and measured north on a line random Var. $4^{\circ}45' E.$ at 40.15 Chs. had rained. 60 Chs West of $\frac{1}{4}$ Cor.

Corrected Var. = $3^{\circ}55' E.$

Set $\frac{1}{8}$ Cor. at intermediate point a 20.07 $\frac{1}{2}$ Chs. each way.

From $\frac{1}{8}$ Cor. ran a hand compass course and chained 20 Chains East on $4^{\circ}00' E.$ Var. and set a temporary stake.

(Field Notes) N. Oct 34 & 35, Var $7^{\circ}20' E.$

40.00 Set $\frac{1}{4}$ Cor.

B. Oak 12" S. 66 W. 20

Aspen 8 N. $70^{\circ}30' E$ 12

(Nearest Note = Oct. 28th 1852)

Vetter Mfg. Co.

Stevens
Point,
Wis.Sept. 10th 1922

Trees found on N.E.S.W.

35-26-8

Red	} Top 9"	} 9" (12'	} 30			
1. Oak				} Stump 14"	} 11" (12'	} 40
				950'		

Red.	} Top 11"	} 11" (12'	} 40			
1. Oak				} Stump 15"	} 11" (12'	} 80
				150		

Total $\frac{120}{270}$

E. H. Vetter
Vetter Mfg. Co.
Stevens Point, Wis.

T. 25 & 26 N. Range 8 East.

Field notes for Conestoga River

Bel. Town 25 & 26 N. Range 8 East.

East to Sec 6 & 31.

26.50 Set 1/4 Cr

B. Oak 12 N. 42 W. 51

H. Birch 6 N. 42 E. 83

63.00 Enter Swamp

66.50 Set Corner to 31 & 32 in Swamp

H. Pine 24 N 46 1/2 E. 17

Fam. 20 N. 10 W. 59

East to Sec 5 & 32 Var. 6° 56' E.

2.00 Leave swamp

33.00 Enter Tamar cedar swamp

40.00 Set post for 1/4 Cr

Fam. 12 N. 64 W. 42

" 14 S. 87 W. 33

44.00 Leave Swamp enter Ash swamp

52.00 Leave Ash swamp

72.00 enter Alder "

73.00 Creek 10 N.W.

77.00 Leave swamp

80.00 Set Cor. to 4-5-32-33

Maple 11 N 47 E 47

" 9 N 29 W 40

" 12 S 69 W 39

" 14 S 25 E 25

(Note) Part of Township 26 N. R. 8 E. was surveyed in 1851 and Part of it in 1852. Subdivision made in 1852.

East to Sec 3 & 33 Var 7° 15' E.

13.00 Creek 7 S.W.

40.00 Set for

Maple 8 N 49 E 19

Birch 14 S 2 W 39

80.00 Set Cor. to 3-4-33 & 34

Birch 9 N 86 E 22

" 8 N 10 W 28

B. Oak 14 S 72 W 30

H. Pine 16 S. 10 E 12

East to Sec 3 & 34 Var. 7° 15' E.

40.00 Set 1/4 Cor.

B. Oak 10 N 30 W 18

Maple 11 S 65 E 14

80.00 Set Cor. to 2-3-34-35

Linn 12 N. 70 E 58

Aspen 14 N. 77 W 32

Ash 10 S 4 W 25

Maple 8 S 83 E. 12

Entered July 9th 1851

Note: South Boundary of Town 26 N. R. 8 E. was run and dated at mouth of Pion Aug. 5th 1851.

East bet Sec's 28 & 35 Var. $7^{\circ}25'E$

16.50 Enter Alder Swamp

24.00 Leave " "

40.00 Set $\frac{1}{4}$ Cor.

Birch 12 N 72 W 22

Elm 10 S 21 E 34

56.00 Creek 12, S.

80.00 Set Cor. to 1-2-35-36

B. Oak 10 N. 38 E. 37

" " 11 N. 50 W. 44

" " 11 S 85 W. 36

" " 12 S 37 E 64

East bet 18 & 36, Var. $7^{\circ}35'E$

40.00 Set $\frac{1}{4}$ Cor.

B. Oak 11 N 25 E 36

Aspen 9 S 40 W 34

73.40 Creek 15, S.

80.00 Set Cor. to Townships 25 & 26 N.

Ranges 8 & 9 E of 41st Pinn. Meridian

Birch 10 N. 25 E 4

Aspen 13 N. 42 W 43

W. Pine 16 S. 18 W. 24

Birch 12 S. 53 E. 39

Oct. 26th 1922 Cloudy-foggy.

Ran on 3° Var E.
S.W. X Sec. 4-41-10, found no Birch stake
scrapped up. No bearings shown.

Ran N. bet. 485-41-10.

1700 P edge of marsh N.E. by W.

1720 P Creek 3 P wide West generally

1745 P across Marsh or meadow land.

1800 P Hit mossy low land. Not marshy

1820 P " Edge of high ground

1840 P Hit Sec. Cor. 4-5-41-10 and 32 & 33

42-10. Remains of old bearings plain and
J. Cruisers stake.

--- East on S. side 33-42-10 Var 3° E.

37. 43 P hit old wagon road runs N.W. 33 E.

47. 00 P. $\frac{1}{4}$ cor. at bunch of white birch 8 pieces

87 at E. foot N. line of railroad

97 over highway (N. 60° E.) and to edge of

open meadow to sec. Cor. of 3-4-32-34.

167 hit sec. Cor. stake (Jack Pine) in edge of
open meadow

--- Ran N. bet. 33-34-42-10

27 hit edge of meadow, N. side.

27 20 P intersect old Transit line N. 85 W.

37 28 P. " " E Highway (N. 60° E.)

67 25 P. " Marsh N. 56 W.

87. in open swamp.

Note, This marsh is loaded with cranberries

Oct. 30 cont. N. bet 33 & 34-42-10

AT PSS, hit high ground

12 T 60 P, marsh around lake. Offset W 1/4

15 T 100 P. found old stake and fence corner

--- Run N. bet 27 & 28-42-10 Var 0° E.

~~AT 95 P N. creek 5 P wide 5. 1/4 = Hay Meadow~~

East R.R. fence is 66 P West of above corner.

At 1 T, 97 P = R.R. Track

At 8 T found tall J.P. stake for 1/4 Cor. Run North

87 P intersect old road bears E & W, at little

J.P. with blaze on E side.

12 T intersect fence E & W. (continued East to R.R. R. W. and West 1/4's.

16 T could find no corner. Land back.

Land West of corner covered with thick growth of young

J.P., East of corner slopes gently to West, open and

thickly strewn with J.P. stumps totally out. Old road:

Run North Var 3° E. bet 21 & 22-42-10

2 T, 14 P. intersect fence line

3 T 30 P old road N.E. & S.W.

4 T s. edge of ravine

14 T 80 P = L bank Wis. river E & W 20 P wide

could not x Wis. river. Went back to 1/4 Cor.

--- Trip East,

At 80 P intersect old road

Oct. 31 1932. Near & Warm.

At 2 T hit marsh along Hay Meadow Creek

" 4 T was 30 P East of creek and 105 P E.

of R.R. Track

6 T 28 P intersect R.R. Track

8 T 0 P hit 4" iron pipe for 1/4 Cor. on E side

of 28-42-10 and was 113 P West of R.R.

12 T hit 8" Fence Post for 1/4 Cor.

16 T found no mark; set J.P. stake.

--- Trip East from Cor. 27-28-21-22

Var 0°. 2 T 100 P hit marsh, Offset South 75 P

West 4 T, Cor in marsh.

4 T 100 P R.R. Track.

6 T 68 P Highway N 63° E.

8 T 00 P thru J.P. Thicket A up old stub

12 T 00 P " " " B " 4" J.P. Tree

--- From above corner ran West 2 T.

and then N. thru middle of forties to

E & W 1/4 line, stony and rough.

D. S. Burnett's Civil Engr

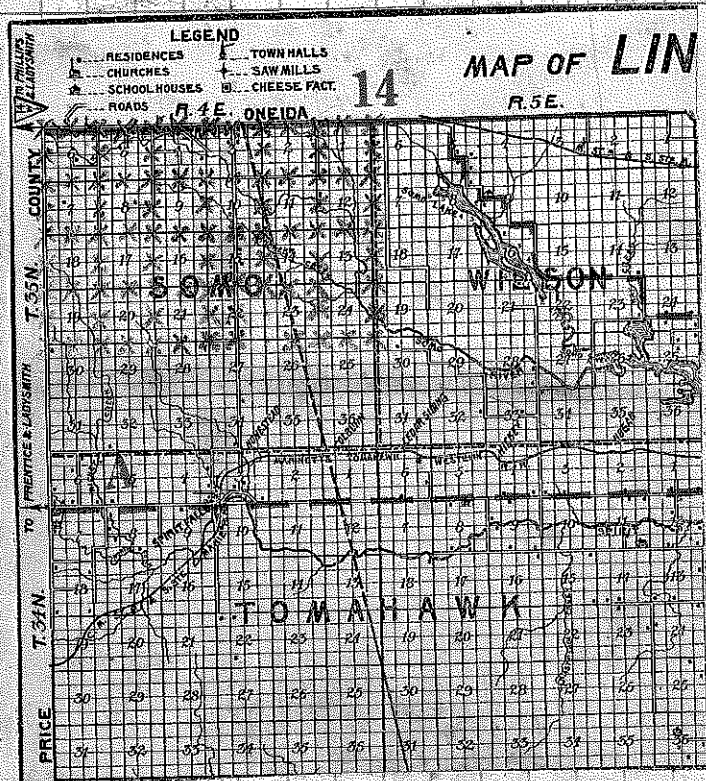

Survey of Part of T. 35 N., R. 4 E.

Sept. 12th P.M. Cold windy Spitting snow.

Identified x. to 37 & 33 & 34. at
 Town Line Bet. 35 & 36 N. R. 4 E.,
 by one orig. cont. B.T.
 W. Pine 24" N. 38° E. 48 lks
 Near, W. Pine 16" N. 16° 15' W. 21 lks
 from above x, S. 76° 5' E.
 48.75 Sub division stake set by same
 unknown party and made on a
 cedar stump. It is marked with
 stake handle of dispart of its left
 from the cor. as compared to water
 43.75, near West of wooden stake
 32.00 Chs. same river, S.
 33.00 " " " "
 33.75 turned 90° Left (East) 1.890
 Continued South, -
 35.00 Chs. sec. 3-4-9-10 identify
 by stake and two birch orig. B.T.
 Birch 14" N. 30° E. 8 lks } Orig.
 " 12" S. 50° E. 27 lks. }
 N. Maple 7" N. 65° W. 39 1/2 lks
 N. Maple 8" S. 32° W. 42 lks
 Cor. V. = 6° 16' E.

TO PRENTICE & ADAMS COUNTY
T. 35 N.
T. 32 N.
PRICE

see Oct. 4" Work, Page 63

Sept. 13"

Cloudy, Cold, Windy.

Set 1/4 Cor. on line

44.40 S. of T. Line
40.60 N. " " to 3-4-9810

From Sec. X. 3-4-9-10, E. $\frac{1}{2}$ 530' E.
 36.43 Chs. W. edge Samoa River
 37.38 " E. " " "
 38.46 " had for. Set Smith's 1/4 Cor. 79 lks
 38.70 " " " S. of Thomas' " " 60"
 41.21 " & Traveled track of highway
 77.29 " for. S. 1.55 Chs.

Identified cor. of 2-3-10-11
 by 2"x2" steel bar and B.T.

S. M. 16" N 59° 30' W. 4 1/2 lks.

Nat. Tan. of Cor. = .02 = 1° 09'

Cor. Var. = 6° 39'

Set Monument no other trees to mark.

Sept. 14" Clear Warm. A.M.

From Cor. to 3-4-9-10, S. $\frac{1}{2}$ 5° 45' E
 40.03 Chs. had var. E. of 1/4 Cor. 2.63 Chs.

Identified by stake and Orig. B.T.

Cedar 7" S. 25° E. 12 lks. (Down)

Nat. Tan. of Cor. = .0657 = 3° 45'

Cor. V. = 3° 15' E

(At 40.00, B. sight on back line,
 needle read 7° 00' E. at 1:30 P.M.)

Marked New B.T.s.

Birch 12" N. 87° E. 33 1/4 lks

Birch 10" N. 86° W. 26 1/2 "

Hem. 8" S. 48° E. 24 "

From 1/4 Cor. above named S. $\frac{1}{2}$ 3° 15' E.

39.13 had var. W. 103 Chs. from

Cor. to 2-10-15 816

Identified Cor. by Orig. B.T. & Stake

Hem. 10" S. 18° W. 35 lks.

Marked new B.T.s.

S. Maple 9" S 62° 30' E 38 lks

Birch 20" S. 22° 15' W. 34 lks

B. Ash 12" N. 31° 00' W. 36 lks

Nat. Tan. of Cor. = .0263

Cor. Var. = 4° 45' E

Sept. 15" Cloudy Warm

From Sec. X 9-10-15 & 16, E.

V. $4^{\circ}00'$ E.37.31 Chs. Offset Left. $2.15\frac{1}{2}$ Chs.44.00 " " Right $.65\frac{1}{2}$ "77.37 " Was $58\frac{1}{2}$ lks N. of X.
to 10-11-14-15Carried distance = $9\frac{1}{2}$ lksNat. Tan. of Cor. = .01183 = $0^{\circ}40'$ Corrected Var. = $4^{\circ}40'$

Identified cor. by Orig. B.T.

Horn 8" N. 32° E. 31 lks.Field notes gave this bearing as
S. 32° E. but tree faced wrong way
so assumed bearing was given from
tree to stake instead of the reverse)

Set iron mark accordingly.

1/4 Cor. sworn in. See Page 76

Set 1/4 Cor. on straight line and
at intermediate distance of 38.685
Chs. each way.

1/4 Cor. is 1.18 Chs. E. of County Trunk '17'

" " " 161 Chs. S. of Road to F. Matt's
= (E. & W. Road.)

Sept. 19" (Wednesday) Clear Warm

From Cor. of 3-4-33 & 34, E.,
V. $2^{\circ}56'$ E.

57 Chs. offset N. 54 lks. ✓

78 " " " 80 lks. ✓

85 " " S. 52 lks.

116 " " N. $20\frac{1}{2}$ lks.

125 " " N. 26 lks.

149 " " N. 36 "

159.27 1/2 " " Set hub in line and
made a prolonged search for
evidence of Sec. Cor. Could find
nothing.9/21" After searching in vain over two
miles of line for different corners
I went to Rhineland, (Sept. 20" 1923)
and got field notes of D. H. Vaughan
who set the corner for sections
2-3-34 & 35 - to 35 & 36 N., R. 4 E.
on May 21" 1919 and recorded in
his field book # 8 on Page 141.

His new bearing set at that time

W. Pine Stump 30° N. $34\frac{1}{2}$ W. 126 lks.

Void

Sept 15th P.M. Clear Windy

From Sec. Corn 10-11-14 & 15 N. 21.3° E. to run in old line, offset 13.115 West on start.

Tried Daugherty's course and distance and found that the distance would not bring me into such a position that a line drawn East from the Corner would touch the creek at all.

Tore up planks in bridge and found a notch in an old pine log used as a back log for bridge; this notch was said to be the point where the old stake stood. Could not set monument in old bridge because high water and ice would be likely to wash out same. Consequently I set monument $19\frac{1}{2}$ links directly East of notch in old back log. This position conforms to the $\frac{1}{4}$ of Roads to N.-S.-& West and also to the East.

Sept. 21st 1923 Clear & Warm.

Marked new bearings to the point where the monument sets.

W. Pine Sp. 36" N. 37° W. 1.55 Chs.

S. Elm (crooked at stump)

S. 41° E. 1.61 Chs.

Found distance bet. the Corners of 3-4-33 & 34 and 2-3-34 & 35 to be 79.72 Chs. and had marked 79.75 South.

Nat. Tan. of Cor. 0099 = $34\frac{1}{2}$

Cor. Var. = $3^\circ 24'$

Went back and set $\frac{1}{4}$ Cor. at equidistance or 39.86 Each way

Marked new bearings.

N. end of East Wing wall of culvert across the road running South, is -

S. 38° E. $41\frac{1}{2}$

Birch Stub 36" N. 13° W. $1.4\frac{1}{2}$

N. end of W. Wing wall, -

S. 38° W. $44\frac{1}{2}$

Sept. 21" 1923

At Cor. to 1-2-35 & 36 found stake
offsetted $37\frac{1}{2}$ lbs N. of Cor. for road
purposes; set back into line and set
monument. Nothing to mark as Witness.

$79.55\frac{1}{2}$ Chs East of Cor. to 2-3-34 & 35.

Backed up and set $\frac{1}{4}$ Cor. on line
and equidistant, or; $39.77\frac{3}{4}$ Chs

Marked new bearings.

Tel. Pole $12''$ S. 43° W. $4\frac{1}{2}$

Not. Tan. of Cor. = .0136 = $47'$

Cor. $2/36 = 3^\circ 00'$ E.

Sept. 21" 1923

At $\frac{1}{4}$ Cor bet 1-2, T. 35 N., R. 4 E.
found old break stem, (from flat Cor.)
set for $\frac{1}{4}$ Cor.

Set monument and marked new
Bearings.

H. Maple $16''$ N. $55^\circ 40'$ W. 73 lbs.

S. Elm $12''$ N. $53^\circ 45'$ E. 1.38 Chs

At sec. Cor. of 1-2-11-12 found
 $2 \times 2 \times 18''$ iron pin and two bearings
marked as follows

Hem. Stp. $10''$ N. $65^\circ 15'$ W. 35 lbs

Birch $12''$ S. 53° E. 63 "

Set monument and made new
bearings.

Birch $16''$ N. $45^\circ 30'$ E. $70\frac{3}{4}$ lbs

Sept. 21" 1923

Ht. $\frac{1}{4}$ Cor. bet. Secs 11 & 12
found old gov't B.T. viz.

W. Pine 8" N. 33° E. 50 lks.

Marks very faint but by the use of
a reading glass marks were easily
discernable.

Set monument and made new
bearings.

S. Maple 14" S. 70° W. 4 lks.

S. Maple 16" N. 45° W. 48½ lks

S. Elm 18 S. 70° E. 51 lks

Orig Pine Stp. N. 38° E. 50 lks.

Sept. 21" 1923

Ht. Sec. Cor. of 11-12-13 & 14 found
Orig Gov't B.T. viz 8. 4"x4" Cedar Stake.

" Torn 6" S. 61° E. 31 lks.

" Spruce 4" N. 45° W. 10 "

Also a Torn 10" S. 30° W. 37 " which
was apparently marked by Gov't but
no record made.

Set iron monument and marked

New B.Ts.

Spruce 7" S. 87° W. 32½ lks

Birch 7" N. 45° 00' W. 28 "

Birch 7" N. 5° 00' E. 49½ "

Sept. 22nd 1923, Clear & Warm.

At $\frac{1}{4}$ Cor. bet. 2 & 3, found both Orig. B.T.s.; Hem. 8" N. 51° W. down and body burned but marks still visible.

Hem. 6" S. 22° E. down but marks very plain. Fixed point from these Orig. Gov't B.T.s. and set monument.

Marked up new B.T.s.

H. Maple 12" S. 82° E. 51 lbs

Birch Stp. 22" N. 33° W. 30 1/2 "

Hem Stp. 26" N. 77° W. 51 "

Sept. 22nd

From Sec. Cor. 2-3-10-11, East. $\frac{1}{4}$ 3° 50' E., Set stakes for correction at 20.00 & 40.00 Chs.

79.41 Chs had cor. S. 0.42 Chs

At 39.70 1/2 Chs. set $\frac{1}{4}$ Cor. in Cor. line and in open field; nothing to mark as bearings.

Nat. Tan. of Cor. = .00529 = 0° 18'

Cor. $\frac{1}{4}$ = 4° 08' E.

$\frac{1}{8}$ Cor. at 19.85 1/4 = Cor. 10 1/2 lbs N.

$\frac{1}{4}$ " " 39.70 1/2 = Cor. 21 lbs N.

$\frac{1}{8}$ " " 59.55 3/4 = Cor. 31 lbs N.

Sept 22" 1923

At $\frac{1}{4}$ Cor. Bet. 10 & 11 found one
Orig. B.T. viz. Hem. 11" S. 45° W. 6 lbs
Set monument and renewed
marks on old tree and marked
one new bearing.

Hem. Stk. 18" S. 86° E. 18 lbs.

Sept. 23" (Sunday) Clear & Warm.

At $\frac{1}{4}$ Cor. bet. 9 & 16 found
marked stake and spruce
stk. 7" N. 84° E. 16 lbs that
checked with field notes also
no marks were visible as the
tree had been cut very low.
Set monument and marked
new bearings.

Tam. 12" N. 14° W. 96 lbs

Spruce 4" S. 76° W. 2 1/2 "

Tam 5" S. 27° E. 22 1/2 "

Sept. 23"

At $\frac{1}{4}$ Cor. bet. N & 14 found a
scribed stake and the stk. of
one of the Orig. Gov't. trees.
viz. Spruce 6" N. 14° E. 20 lbs.
also two other trees scribed
to which I took bearings.
Spruce 7" N. 76° W. 2 1/2 lbs
Tam 12" S. 56° E. 30 lbs
Set monument.

Sept. 24, Cloudy, Foggy

From Sec. Cor. 3-4-32-33, W. $N. 4^{\circ} 20' E$ At 39.64 Chs. found bearings established by D. Deaghan for $\frac{1}{2}$ Cor. on N. side Sec. 4.

Pine Stp. 36" North 57 lbs.

Tel. Pole S. $4^{\circ} E$ 35 $\frac{1}{4}$ lbs.

Dug and found Iron Monument.

Set new Monument.

Nothing new to mark.

From $\frac{1}{4}$ Cor. bet 4 & 33 West. $N. 4^{\circ} 15' E$.

39.99 Chs. found bearings all gone but 2'x2'x18" iron monument at intersections of highways in place. Set Monument for Cor. to 4-5-32 & 33 and took bearings to the following.

East face of North wing wall of Culvert $N. 86^{\circ} 10' W. 1.42 \frac{1}{4}$ Chs.

N.W. Cor. of foundation under main building of Town Hall.

 $S. 27^{\circ} 35' E. 1.27$ Chs.

Sept. 24"

From Sec. Cor. of 4-5-32 & 33.

West along Town Line $N. 4^{\circ} 20' E$.39.89 Chs. found stp. of Orig. Govt bearing. - Birch 10" S. $S^{\circ} W. 26$ lbs.

(Shown me and sworn to by Cavanaugh, & P. Isacson)

Set monument and took bearings.

to Pine Stp. $N. 44^{\circ} E. 50 \frac{1}{2}$ lbs.Tel. Pole S. $4^{\circ} E. 24$ lbs.Pine Stp. $N. 25^{\circ} W. 95 \frac{1}{2}$ lbs.79.95 Chs. found Pine Stp. marked by Dorr. & Pine Stp. $24' N. 72 \frac{3}{4} W. 1.44$ Chs.

Set monument. Took bearings.

N.W. corner of Bridge over S. road.

 $S. 45^{\circ} W. - 33$ lbs.

N.E. Corner of Bridge over S. road

 $S. 45^{\circ} 15' E 34$ lbs.

Sept 24"

From Sec. Cor. of 5-6-31 & 32

West $4^{\circ}26' E$ 39.84 Chs. found $\frac{1}{4}$ Cor. in center of Town Line road (on old stake).Set monument and took bearings:
Horn 12" S. $47^{\circ} W$. 1.1 $\frac{1}{2}$ Chs.

80.84 Chs. Sec. Cor. of

1-6-31 & 36;

Township Cor. bet. 35 & 36 N.

Ranges 3 & 4 E.

Found Orig. Govt B.T. viz.

Birch 12" S. $20^{\circ} E$. 19 lks.

Set monument by Orig. B.T. and took one new bearing.

S. Elm 36" N. W. 91 $\frac{1}{2}$ lks

Notes: found a 6" Cedar post set, no marks on it, bearings to Orig.

B.T. = S. $20^{\circ} E$ 41 $\frac{1}{2}$ lks and itseems this Cedar Post has been used as the $\frac{1}{4}$ Corner, but I disregarded it.

Sept 25" Clear & Warm

From Sec. Cor. of 4-5-32-33

South on a line $4^{\circ}45' E$.43.45 $\frac{5}{8}$ set $\frac{1}{4}$ Cor. by measurement.

Marked new B.T.

Birch 10" S. $52^{\circ} E$. 64 $\frac{1}{4}$ lks

83.65, Sec. Cor. of 4-5-8-9

Identified by 2"x2"x18" iron stake

Orig. B.T.s all blown out.

Set monument and took new bearings.

Pine Stk. 18" N. $54^{\circ} W$. 39 lksTown " " 18 $\frac{1}{2}$ S. $18^{\circ} E$. 63 $\frac{1}{2}$

Sept. 25"

From Cor. of 4-5-8 & 9

South of B. 2nd cor.

Chs. 1/4 Cor. was set in
evidence of J. B. Rucker who
is an old freeholder adjoining
this corner.

Set monument and made
new bearings.

Birch 12" N. 21° W. 76 lbs.

Hem. Spr 12" S. 65° E. 43 1/2 lbs.

Sept. 25"

At Cor. of 8-9-16-17 found a
scribed stake, but after a pro-
longed search I could find
no trace of any of the B. Ts.
so accepted the stake as the
best evidence of the old
corner obtainable and set
monument accordingly.
Marked new bearings.

Cedar 16" N. 78° W. 29

Hem 8" N. 47° E. 54 1/2

Cedar 12" N. 52° W. 30 3/4

Twin Birch 12" S. 62° E. 6 1/2

Sept. 25

At 1/4 Cor. bet 4 & 9
 found scribed stake and little
 stakes marking position of Orig
 B.Ts. and a tree scribed up
 Hem. 16" S. 49° E. 26
 Set monument and marked
 up new tree.
 Birch 16" S. 25° W. 41 lbs

Sept. 26, 1923, Clear & Warm.

At Township Corner of 35 & 36 N.
 of Ranges 4 & 5 E., found scribed
 stake offsetted 40 lbs South.

Tom. 12" S. 45° E. 16 lbs } Orig B.Ts.
 " 18" S. 89° W. 85 " }

The size, kind, & direction of
 these trees, (in relation to the
 stake or "Corner") checked with
 the Govt notes, but the distance
 was three links long to the S. W.
 and four links long to the S. E.
 Could not recognize this as the Cor.
 and set monument by offsetted stake
 Distance East of Corner to 1-2-
 35 & 36 is 79.81 Chs., N. 4° 45' E.
 Nst. Tam. of Cor. = .00626 =
 Cor. var. =

Backed up and set 1/4 Cor. on
 straight line and at equidistance or
 39.90 1/2 Chs. each way
 Nothing to mark for bearings.

Sept. 26

From Township Corner of 35th & 36th N. of
Ranges 4 & 5 E., South on Random 14° 20' E
43.40 found stake set for 1/4 Cor. but
as I could not check it with Orig. B.T.s,
ran on.

80.40 found stake set 6' to the East
of my Random for Cor. to 1-6-7 & 12
but here also I could find no trace
of Gov't B.T.s.

83.50 set temporary hub for cor-
rection purposes and continued South
on same line the next morning at,

Sept. 27th Heavy Fog; Warm, A.M.
with chaining commenced at 0 at last
above given hub running South on
continuation of above line.

40.00 Chs. found 1/4 Cor. Var. W. 25' 1/2 lbs
Identified by Orig. Gov't B.T. via.)
W. Pine 12" S. 65° W. 40 lbs.

(Tree had been cut down and fallen
with marks down in water and mud.
Cut off 5 ft. length and set up near
stump. Marks plain.)

Sept. 27. (Not as Well! 12° 20' N.C.)

(Continued)

Stake sets in a small very deep, ^{round}
mud hole about 6 ins. in diameter,
Mud about 5' deep.

Made and set cedar stake 4" x 4"
8', and marked two new B.T.s.

Cedar 18" N. 70° E. 9 1/2 lbs ^{Sp. edge of}
" 10" N. 65° W. 6 1/2 lbs ^{side of}

Corrected line back to the North.

Set 1/4 bet. 1 & 6 at 43.40 Chs. S. of
Township Cor. and on straight line.

Marked new B.T.s.

W. Pine 7" S. 37° E. 70 lbs.

Paplar 6" N. 48° E. 20 lbs.

Set Cor. to Secs. 1-6-7-12 at
83.40 Chs. S. of Township Cor. and on
straight line.

Marked new B.T.s.

Hem. 12" S. 24° E. 60 lbs.

H. Maple 10" N. 28° E. 20 1/2 lbs

Net Tan. of correction = .00206

Cor. Var. =

(Note: The above distances are a good
check on the Township Corner)

Sept. 28th Clear and Warm

At $\frac{1}{4}$ Cor. bet. 12 & 13 found a
scribed stake and one Orig. B.T.
Hem 9" N. 70° E. 7 lks.
Set monument and marked
Hem Stp. 16" N. 59° E. 49 1/2 lks
Hem Stp 14" N. 38° W. 55 lks

At Section Corner of 12-13-7 & 14
on Range line bet. R. 4 & 5, in
Town 35 N., found stake and
two stps Orig B.Ts. 26 1/2

Hem 7" S. 37° E. 4 lks
" 12" N. 52° E. 22 lks.

Set monument and marked
new bearings.

Pine Stp 22" N. 87° E. 33 3/4 lks

x² Large Grey Boulder N. 42° W. 35 1/2 "

Lot. 79.55

Sept 29th Clear & Warm

From S.W. Cor. of Sec. 1-35-4
East $\frac{1}{4}$ 5° E.
39.37 1/4 set hub for correction
purposes. (Found there was strong
local attraction at starting point)
79.55 intersected Range line
9.30 Chs. North of the S. E.
Corner of Sec. 1-35-4.

Corrected up line and set $\frac{1}{4}$ Cor.
at intermediate distance or
39.77 1/2 Chs each way.

Marked Bearings.

Poplar 7" N. 60° E. 23 lks
Poplar 8" S. 35° W. 12 1/2 lks

Also set $\frac{1}{8}$ Corners in both $\frac{1}{4}$ s
at 19.88 3/4 Chs

B.Ts. for E. $\frac{1}{8}$ Cor.
Hem. 20" N. 78° W. 45 1/2
W. Pine 8" N. 23° E. 58

B.Ts. for W. $\frac{1}{8}$ Cor.

Service 6" S. 60° W. 31 lks
" 8" EAST 5 "

1/4 section mark

October 2nd 1923 Clear & Warm.

From N. W. Cor. of Sec. 5,
South 41° E.
44.50 chs. dug up roots of Birch
tree, shown me by Aug Johnson
& free holder in Sec. 5, that was the
Orig. Gov't B.T.. Set monument accordingly.
No trees or stumps to mark, for
1/4 Cor. bet 5 & 6.

84.03 chs. was shown the stump
of the original Gov't B.T.
(Horn. 12" S. 47° E. 25 lbs) by
Kavanaugh; set monument and
renewed marks on old stump and
marked one new bearing.

Horn. Stk. 14" N. 65° W. 42 lbs

Oct. 2nd

83.85 Chs. = Total dist from 1/4 to 1/4 N. W. Cor.

At 1/4 Cor. bet. 7 & 8 found stake
offsetted to the East, and by
proofs offered by J. F. Kavanaugh
set monument in middle of
N. & S. highway. Marked B.T.s.
Birch 7" N. 75° E. 61 lbs.
H. Maple 7" S. 28° W. 85 1/2 lbs

At Sec. Cor. 7-8-17-18 Could
find no evidence of B.T.s. but by
evidence of Kavanaugh who runs
lines to the West from here some
years ago set monument at inter-
section of roads and marked up
bearings.

Hard Maple 12" N. 9° E. 79 3/4 lbs
Horn. 12" N. 86° E. 47 "

Oct. 3" Clear & Warm

At the $\frac{1}{4}$ Cor. bet. 5 & 8
 Identified by Orig. Galt. B.T.s & Stake.
 Cedar, 6" N. 15° W. 24 lbs (down)
 Birch, (rotten stp) 12" S. 60° E. 35 lbs.
 Set monument and marked
 new B.T.s.

Birch 7" N. 80° W. 54 lbs

" 10" S. 84° E. 56 "

Balsam 7" S. 18° W. 37 1/2 "

Oct. 3" 1923

At the $\frac{1}{4}$ cor. bet. 5 & 17 I could not
 locate the Orig. Galt. B.T.s and was
 informed by Havermugh that to his
 certain knowledge the B.T.s were
 willfully & purposely destroyed but
 by his own personal marks he had
 preserved the location of the corner.

These marks are now on a Hem.
 stub about 8' high and 12" in dia.
 and has been recognized by many
 woodsmen who have registered here
 viz, Robert Posey 5/19/17

H. Cole 4/25/1918

Ed. Lemay June 10"/1916

T. Kilroe June 19" '05

Set monument at this point and marked
 new bearings. viz.

Hem. ^{8 1/2} 14" N. 40° W. 24 lbs

Tall Hem. stp. 40" S. 82° E. 50 lbs.

Oct. 3rd 1923

At the $\frac{1}{4}$ Cor. bet. 7 & 18, identified
by both Gov't B.Ts.

Tam. 8" N. 15 W. 13 lks. (now stub)

Hem. 11" S. 35° E. 16 " (down)

set monument and marked new B.Ts.

Cedar 10" Due North. 24½ lks

Birch 10" S. 57° W. 40½ lks

At $\frac{1}{4}$ Cor. bet. 1 & 6, Tis. 3 & 4 E.
found wooden stake in highway and
stump of Orig. Gov't B.T. viz.

Hem. 18" S. 65° W. 26 lks.

Set monument but no trees to
mark up.

Oct. 3rd

At Sec. Cor. of 1-6-7 & 12, on
Range Line bet. 3 & 4 E, found
stumps of Orig. Gov't B.Ts viz

Hem. 12" N. 18° E. 19 lks (Plain)

" 10" S. 70° E. 21 lks (rotten)

Set monument accordingly and
marked up new bearings.

Birch 18" S. 40° E. 62½ lks

" 10" West. 70 lks.

At $\frac{1}{4}$ Post bet. 6 & 7, found stake
and stub of Orig. Gov't B.T. viz.

Birch 11" N. 35° E. 10 lks.

Set monument accordingly.

Nothing to mark as Bearings.

Oct. 3rd 1923

At the Corner of 7-12-13-18
found one Orig. B.T. 217.
Birch 18" S. 48° W 49 lks.
Set monument accordingly.
Nothing to mark as Bearings.

At 1/4 Cor. bet. 7 & 12 was shown
where the orig. trees had stood
and where a stake had stood for
many years until late this summer
and upon the evidence of
Frank Pajunen, a freeholder
in Section 1-35 N. R. 3 E., I set
the monument on the East
side of the road bed.
Marked new bearings
Hem. 8" S. 34° E. 76 lks.
H. Maple 7" N. 72° E. 56 lks.

Oct 4th 1923 Clear Cool.

After having questioned many
freeholders, viz, Stolle,
John Green, Chas. Johnson,
Otto Mattson I changed my
mind on the class of this Corner.
I now believe this to be only
an obliterated Corner and have
treated it accordingly.

Therefore Mag. Var. from the
North is 5° E. and distance is
No Chs., Bearings

Cedar Str 16" N. 70° W. 14 1/4 lks
Variation South = 7° 25' E.
distance to S.E. Corner of Sec 4
= 45.00 Chs.

Mag. Var. of Cor. from 1/4 Cor. South = 7° 25' E.

Oct. 4"

At $\frac{1}{4}$ Cor. bet 19-30-35-4 found
scribed stake; Orig B, T, gone.

Marked new Bearings.

Elm 16' N. 30 W. 65 lks

Birch 24' N. 46 E. 65 "

Set Monument 11/27/24

Oct. 4" 1923 P.M.

A line for the $\frac{1}{2}$ of a highway
in the town of Samo.

From the Section Corner of
19-20-29 & 30, T 35 N, R. 4 E.
West along the Section line
between 19 & 30, -

1.10 Chs. Creek, S. E. -

1.26 " Over creek.

3.23 $\frac{1}{2}$ " to point of beginning. -

Thence by an included ΔR of $72^{\circ} 05'$
5.42 Chs.; thence by an external Δ of $8^{\circ} 30'$

4.76 Chs., Thence by an external
angle R of $17^{\circ} 41'$, 5.58 Chs., to
its intersection with the N. & S.

Section Line and having an
external ΔR of $3^{\circ} 27'$, to hit
~~the $\frac{1}{4}$ Past bet. sec's 31 & 32~~

The above described line is for a
high way 3 rds. wide and is
the center line there-of.

Oct. 4th 1923

5.27/2
2 1/2
1.15

1/4 Sec. 21
1/4 Sec. 22
1/4 Sec. 23
1/4 Sec. 24
1/4 Sec. 25
1/4 Sec. 26
1/4 Sec. 27
1/4 Sec. 28
1/4 Sec. 29
1/4 Sec. 30

Road for
Town of Somo.

HENOS

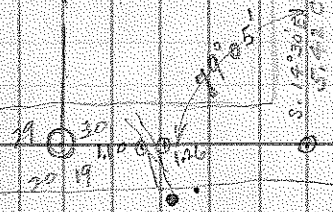

Oct. 5th Clear & Cold

A Line for the ϕ of a Highway
in Town of Somo.

At the Corner of 19-20-17 & 18 found
old stake and one B.T. (Orig) viz.

Cedar 12" S. 16° E. 33 lbs.

Set 4x4 Cedar Stake and marked
new B.Ts. (Set Monument 11/26/24)

Birch 16" N 28° 30' E. 101 lbs

" 7" N. 34° 30' W. 61 lbs

" 12" S. 40° 45' E. 66 lbs

S. 21° 4' E., at 37.64 Chs. var. 2.64 Chs. E.

of 1/4 Cor. bet. 19 & 20 which I identified
by one of the Orig B.Ts. viz & scribed stake

Tan 7" N 45° W. 16 lbs. (Plain)

Birch B.T. gone entirely.

Set new stake and marked bearings:

Birch 10" N. 79° W. 5 1/2 lbs

Cedar stake 10" S. 32° 30' W. 40 1/2 "

SPRUCE 12" S. 84° 15' E. 75 1/2 "

Not Tan. of correction = .0661 = 3° 47'

Corrected V.B. = 0° 13' E.

11/26/24
Set Monument

Oct. 5th P.M.

Road Line Continued.

From Va Post bet. 19 & 20, South-
 21, $6^{\circ} 00' E.$ at 39.98 chs., 25th E. 65 chs.

Nat. Tan of Correction .0164

Cor. 23rd = $5^{\circ} 04' E.$

Marked up new bearings.

W. Pine 24th N $64^{\circ} E.$ 185 chs.

Elm 4th N $58^{\circ} 45' N.$ 65 "

Corrected stakes to line.

Set Monument (11/27/24)

Exp. to 19-20-29 830

Oct. 6th 1923

Clear, cold.

Highway Line in

Town of Somo, by order and
 authority of Board of Suppl's

From the N. E. Corner of
 the N. W. S. W. Sec. 14, -35-4,
 North along the $\frac{1}{8}$ Line 22 chs
 to a point of beginning.

Thence in a South Easterly
 direction 58 chs to an
 intersection with the E. & W.
 $\frac{1}{4}$ Line in said section,
 Town & Range.

The above described line
 is to be the $\frac{1}{2}$ of a high-
 way three chs in width.

Resumed Work

Nov. 25th 1924

Clear & Cold

Nov. 26th 1924

At 1/4 Sec. Cor. bet. 17 & 20

Identified by good stake and one

Orig. B.T. = Elm 4" N. 15° E. 7

Set monument and marked new B.Ts.

Birch 12" N. 24° 00' W. 57 1/2

Maple 8" S. 40° 00' W. 15 1/4

" 10" S. 53° 00' E. 23

Nov. 26th 1924

At Sec. Cor. of 16-17-20-21

Identified by good scribed stake

but orig B.T. were taken out of logging

R.F. bed. Set Monument and marked

B.Ts.

Hem 10" N. 74° 00' W. 68

Maple 10" N. 64° 00' E. 65

" 9" S. 17° 00' W. 26

At 1/4 Cor. bet 18 & 19 found
stake properly scribed and one B.T.
(of later survey) set Monument

Marked B.Ts.

S. Elm 14" S. 80° 00' E. 15 1/2

S. Elm Stump 14" S. 45° 00' W. 47 "

For 1/4 Cor. bet 17 & 18 chained
distance bet Sec. Cor's and found
70.33 chs to be total distance.Set 1/4 Cor. on line and at
intermediate distance.

Marked B.Ts.

S. Elm Stump 20" S. 86° E. 41

H. Maple N. 17° E. 97 1/2

Thanksgiving Day

Spitting snow

Nov. 27th 1924

At 1/4 Sec. Cor. on West line of
Sec. 18, identified by one of
the Orig Gov't trees.

Hem. 12" N. 71° E. 41 1/2

Set monument and marked

B.T. = Birch 35" N. 47° E. 39 1/2

At Sec. Cor. of 18-19-13-24
identified by scribed stake

Set monument and marked

stake B.T.'s.

Birch 14" S. 83° W. 38 1/2

Maple 12" S. 51° 30' W. 84

At 1/4 Corner N. side of Sec.
19, identified Cor. by stumps of
Orig Gov't B.T's. viz

Y. Birch 10' N. 12° E. 6

Pir 10" S. 15° E. 32

Set monument and marked
new B.T's.

Maple 10" S. 59' W. 84

B. Birch 14" N. 52° E. 32

At 1/4 Cor. bet 20-29, identified
by stake of resurvey, set monument
and marked B.T's.

Hem. 14" S. 10° E. 24 1/2

" 18" S. 83° W. 17 1/2

At Sec. Cor. of 28-29-20-21, found scribed
stake and one B.T. of later survey, set
monument, and marked B.T's.

Birch Stump 16" N. 45° W. 15

" Tree 18" S. 71° W. 66

" " 18" N. 65° W. 52 1/2

74

Lat.	Dep.
2/76.61	2/1.38
38.30	.69

Cold & Spitting snow

Nov. 28th 1924

From Sec. Cor. of 8-9-16-17,
S. on Random, Var 1°00' E.
76.61 feet 1.38 West of Cor. to
16-17-18-19.

Cor. Var =

Net. Tan. of Cor. =

Set 1/4 Cor. equidistant on wire
marked B.T.s.

B. Birch 6" N. 71° E. 15 Mts.

S. Elm 14" S. 35° E. 71 Mts.

Y. Birch 16" S. 6°30' E. 54 Mts.

75

Lat.	Dep.
2/57.87	112.2
2593.5	2593.5
46.5	

Nov. 29th 1924

Snowing & dark.

From Sec. Cor. of 16-17-20-21
S. on Random, Var 3°00' E.
5187 feet fall 112.2 feet West of
Cor. to 20-21-28 & 29.

Cor. Var. = 2°02' E.

Net. Tan. of Cor. = .018 = 1°02'

Set monument 8 5/8" Cedar Stake
marked B.T.s as below

B.T.s.

Birch 12" S 16° E. 2.5 ft.

Maple 8" S 48° E. 5.0 ft.

Dec. 1 1924

Affidavit of H. H. Stolle

I, H. H. Stolle, Chairman of Town of Soma, Lincoln County, Wis., certify that the position and location of the $\frac{1}{4}$ Sec. Corner between Sections Ten (10) and Fifteen (15) in T. 35 N. of R. 4 E. is known to me and I have pointed out the approximate point and, Burnett, Surveyor, has set monument accordingly which is correct in fact according to my best judgment and belief.

H. H. Stolle
Chairman

Dec. 11 1924

Clear & Cold

At $\frac{1}{4}$ Cor. bet 15 & 22 set monument in middle of road. Bruyette's South $\frac{1}{4}$ Cor. 3rd shown me by him, marked B.T. the only one to be had.

Basswood 14' N. 47° W. 6 2/2

At $\frac{1}{4}$ Cor. bet 22 & 27 set monument at intersection of roads. No trees.

At Sec. Cor. of 21-22-27 & 28 found crooked s. Maple with old scribe marks but not noted in field notes.

Set monument and took bearings

S. Maple.	S. 32° E.	10 1/2
S. "	S. 85° E.	4 1/2
E. "	N. 22° E.	14 1/2

Dec. 1st 1924

At $\frac{1}{4}$ Cor. bet 21 & 28, identified
by stumps of both Orig B.Ts.

viz Hem. 12" N. 65° E. 32

" 10 S. 27 W. 11

Set monument and marked near
B.Ts.

Hem. N. 10° E. 81

" S. 46° W. 55 1/2

Birch N. 64° W. 34

Dec. 2nd 1924

At $\frac{1}{4}$ Cor bet 16 & 21 identified
by good scribed stake and one B.T.

Marked near B.T.

S. Elm 14" N. 58° E. 42 lbs

B. Ash 9" N. 19° W. 33 "

Old Cedar 10" North 23 lbs

Dec. 2nd 1924

At Sec. Cor. of 15-16-21 & 22

Identified by scribed stake and
two stumps of Orig B.Ts. viz

Tam 12" N. 35° W. 19 lbs

Fir 8" S. 20 W. 14 "

Set monument and marked near
B.Ts.

Dead Tamarac 14" N. 84° W. 7 1/2 lbs

Tam. Stump 16" S. 6° N. 2 3/4

At $\frac{1}{4}$ Cor bet 21 & 22 found good
scribed stake; of 18-survey

Set monument and took B.Ts.

Hem. Stump 24" S. 20° W. 30

" " 12" N. 25° W. 19

" " 10" N. 35° E. 21

Dec. 2nd 1924

At $\frac{1}{4}$ Cor bet 15 & 16, found
scribed stake and one B.T.
Set Monument and was no trees
to mark in cedar and Tom swamp
little dead Tom & Spruce.

Took bearing to old tree
Tom 5" S. 38° E. 3 1/2 kts.

Dec. 3rd 1924

At Cor of 14 & 15 - 22 & 23 identified
same by all four Orig B.Ts.

Cedar 6" N. 15° W. 10

" 4" N. 65° E. 15

" 4" S. 43° E. 18

" 5" S. 82° W. 8

Set monument and marked new
B.Ts.

Hem 7" S. 41° E. 24

Cedar 7" S. 5° E. 15 1/2

Hem 7" N. 76° E. 39 1/2

Dec. 3rd 1924

At $\frac{1}{4}$ Cor. bet 14-15 identified
by one Orig B.T. viz.

Cedar 4" N. 55° W. 7 kts.

Set monument and marked B.Ts.

Cedar 6" N. 82° W. 31 1/2

" 5" S. 50° W. 33

" 5" S. 35° E. 29

At $\frac{1}{4}$ Cor. bet 14 & 23, identified
by scribed stake and Orig. B.T. viz.

W. Pine (stump) 24" N. 46° W. 41 kts.

Set monument and took new Bearings

W. Birch 20" N. 64° W. 36 kts.

S. Maple 16" N. 16° E. 38 "

Dec. 3rd 1924

At sec. Cor. of 13-14-23 & 24
 identified by good scribed stake &
 one Orig. Galt B.T.

Hem 16' S, 21 W, 144 lks

Set monument and scribed two
 new Bearings.

Hem 14" S, 77° N, 75 lks.

W. Pine Stp 22" N, 22° E, 74 "

Clear, Cold = Dec. 4th 1924

At Sec. Cor. of 23-24-25 & 26
 identified by good stake and
 three Orig B.Ts.

Hem 10" N, 24 W, 9

" 6" S, 44 E, 12

Elm 12" S, 73 W, 18

Set monument but marked no new
 trees because old ones were good.

23.93
 1.96

281.43
 40.71

Dec. 4th 1924

From Sec. Cor. of 13-14-23 & 24 South
 Var. 1° 20' E. 1/4 Cor. Lost.

81.43 Chs. had carried E. 3.93 Chs.

Cor. Var. = 1° 26' W.

Lat. tan. of Cor. = .0482 = 2° 46'

Set monument for 1/4 Cor. at
 intermediate distance on true line
 and marked E.T.

W. Pine Stp 16" N, 60° E, 12 "

Y. Birch 16" N, 42° W, 52 "

At 1/4 Cor. bet 23 & 26 found stake
 and B.T. of resurvey. Set iron
 monument and stake and marked
 Bearings.

Tan. 10" N, 26° E, 31

" 10" S, 73° E, 20 1/2

At 1/4 Post bet 24825 identified
by two Orig. B.Ts.

Plow Hem. 12" N. 27 W. 7 lbs

Tree Birch 14" S. 65 E. 9 "

Marked new B.T.

S. Maple 10" S. 84° W. 28.

H " 14" N. 64 E. 23

At 19-24-25 & 30, Ranges 4 & 5
East, identified by stake set by
Vaughan; Set Monument and
Marked new B.Ts.

Y. Birch 14" S. 47° W. 61 lbs.

H. Maple 12" S. 84° E. 38 1/2 lbs.

Dec. 4" 1926

At 1/4 Post bet 19824, R's 4 & 5 E.

identified by stake set by Vaughan

Set monument, marked B.T.

Hem. Stp 18" S. 15° W. 32 lbs.

Dec. 5" 1926 Cloudy, Dark, Snowing.

At 1/4 Cor bet 19824, identified by
stake and Orig B.T. 2/2.

Hem 4" N. 50 W. 7 lbs.

Set monument and marked

B.Ts.

Birch 12" N. 48° W. 70 lbs

Hem 12" N. 47 E. 79 "

Dec. 5" 1924.

R. 4 & 5 E.

At Sec. Cor. bet. 13-18-19 & 20
E. identified by stake of re-
survey; Set monument and
marked new B.Ts.

Balsam 5" N. 25° E. 34
Hem. 12" S. 10° E. 72

At 1/4 Cor. bet. 13 & 18, R. 4 & 5 E.
Identified by good stake and
Orig. B.T. Hem. stp 10" S. 22° W. 14 1/2
Set monument in burning notches
to mark.

At 1/4 Cor. bet. 13-14, identified by
stump of Orig. B.T.

Cedar 12" N. 23° E. 11 1/2
Set monument and marked
B.Ts.

Spruce Stp. 14" S. 50° W. 52
Cedar 10" N. 45° E. 24

From Sec. Cor. of 14-15-22 & 23
S. on Random, Var. 0° 00'
80.64 Varied E. 4. 81 Chs.
Identified cor. of 22-23-26 & 27 by
stake and two B.Ts. of resurvey.
Set monument and marked new
B.Ts.

New Old	Spruce 6"	S. 67° N. 3 1/2
		N. 63° E. 6 1/2
	" 5"	N. 85° E. 70
	" 5"	S. 30° W. 33
" 4"	N. 57° W. 26 1/2	

Set 1/4 Cor. bet. Sec's
at intermediate distance and
marked new B.Ts. set 4x4" cedar
Cedar Stp. 16" S. 24° E. 54
" " 10" S. 78° W. 21

Nat. Var. of Cor. = .05965 = 3° 25'

Cor. Var. = 3° 25' W.

Time and Expense on

Work for Town of Gomo

Sept 1923

Surveying North 12 Sections, 35-4

1	2	3	4	5	6	7	8	9	10	11	12	13	14	15
								S	M	T	W	T	F	S

16	17	18	19	20	21	22	23	24	25	26	27	28	29	30
S	M	T	W	T	F	S	S	M	T	W	T	F	S	S

1 1 1 1

0 0 0 1 1 1 1 1 1 1 1 1 1 1

Bill for work up to and including Sept. 29th
 15 days @ \$10.00 \$ 150.00
 Auto service 42.00
 Paid in Full \$192.00

Drew \$50.00 on 30th

Drew \$42.00

October 1923

M	T	W	T	F	S	S
1	1	1	1	1	1	1

6 days @ \$10.00 60.00
 Auto Service 19.00
 Paid in full 79.00

Fiskiman & Star
vs. Stet & Bissel Lbr Co

C. W. Pippenger
Tripoli, Wis.

fr Pajunen