

INDEX OF SHEETS

- SHEET NO. 1 TITLE
- SHEET NO. 2 TYPICAL CROSS SECTIONS
- SHEET NO. 3 ESTIMATE OF QUANTITIES
- SHEET NO. 3A MISCELLANEOUS QUANTITIES
- SHEET NO. - RIGHT OF WAY PLAT
- SHEET NO. 4-16 PLAN AND PROFILE STA. 334+90 TO STA. 1002+99.7
- SHEET NO. 17-19 STANDARD DETAILS
- SHEET NO. - DRAINAGE STRUCTURES
- SHEET NO. - CROSS SECTIONS

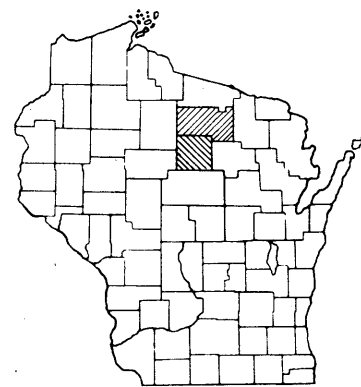

STATE OF WISCONSIN
STATE HIGHWAY COMMISSION OF WISCONSIN

FED. ROAD DIST. NO.	STATE	PROJ.	SHEET NO.	TOTAL SHEETS
4	WIS.		1	

COUNTY AND HIGHWAY	ROUTE AND SECTION	CLASS AND AGREEMENT		FEDERAL DIVISION OFFICE	SHEET NUMBER	TOTAL SHEETS
		STATE	FEDERAL			
35.1	21.2		11.22	WIS.	1	19
43.1	21.2		11.34	5 N		

PLAN AND PROFILE OF PROPOSED
PRENTICE - CLIFFORD - MC CORD - RHINELANDER ROAD
CLIFFORD - MC CORD ROAD
LINCOLN AND ONEIDA COUNTIES

PROJ. F021-2(22)

PROJ. F021-2(34)

BEGINNING AT A POINT 520 FEET SOUTH OF NW CORNER OF SECTION 6, T35N, R4E, AND EXTENDING EASTERLY TO A POINT 1752 FEET EAST OF THE N.W. CORNER OF SECTION 2 T 35N, R 5E.

BEGINNING AT A POINT 1752' EAST OF THE N.W. CORNER OF SECTION 2, T 35N, R5E AND EXTENDING EASTERLY TO A POINT 360' WEST OF THE N.E. CORNER OF SEC. 6, T35N, R5E.

PLAN 1 IN. = 100 FT.
PROFILE HOR. 1 IN. = 100 FT. VERT. 1 IN. = 10 FT.
CROSS SECTIONS HOR. 1 IN. = 5 FT. VERT. 1 IN. = 5 FT.

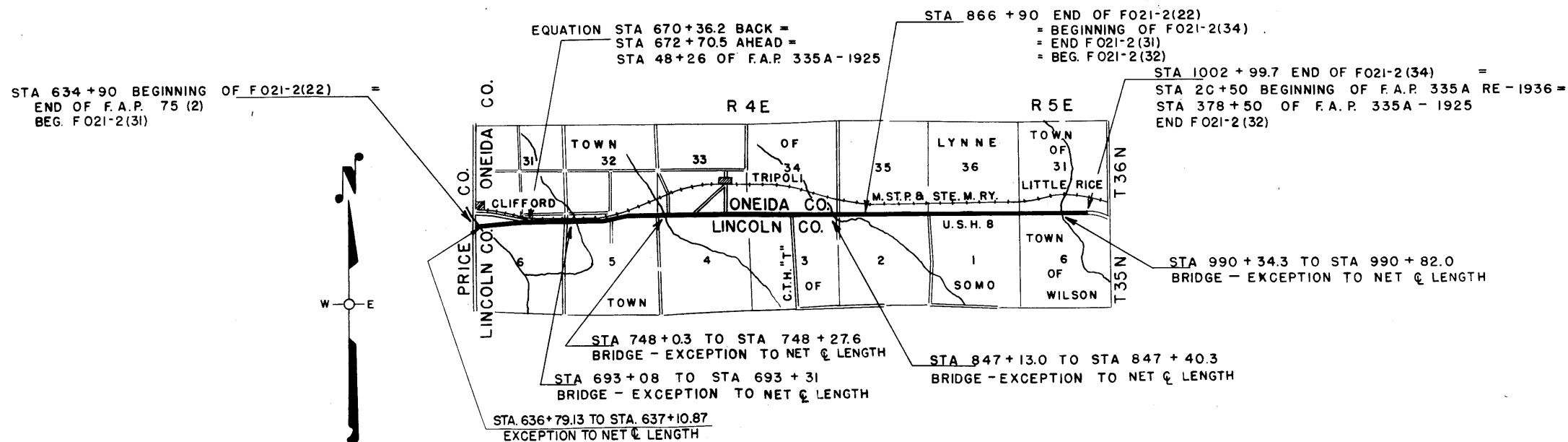

CONVENTIONAL SIGNS

- | | | | |
|---------------------------|-------|-------------------------------|------------------|
| STATE LINE | ----- | CULVERTS IN PLACE | ----- |
| COUNTY LINE | ----- | CULVERTS REQUIRED | ----- |
| TOWNSHIP OR RANGE LINE | ----- | DROP INLET | ----- |
| SECTION LINE | ----- | POWER POLE | ----- |
| NEW RIGHT OF WAY LINE | ----- | TELEPHONE OR TELEGRAPH POLE | ----- |
| PRESENT RIGHT OF WAY LINE | ----- | RIGHT OF WAY MARKERS | ----- |
| WIRE FENCE { WOVEN | ----- | REFERENCE STAKE FOR HUBS ONLY | ----- |
| { BARBED | ----- | MARSH | ----- |
| LOT LINE | ----- | HEDGE | ----- |
| CORPORATE OR CITY LIMITS | ----- | TREES | ----- |
| PROPERTY LINE | ----- | GROUND ELEVATION | DATUM LINE 73.9 |
| TRAVELED WAY OR P.E. | ----- | GRADE ELEVATION | DATUM LINE 73.16 |
| RAILROADS | ----- | | |
| BASE OR SURVEY LINE | ----- | | |

LAYOUT

SCALE 1 MILE

TOTAL NET LENGTH OF CENTERLINE = 6.897 MI.
 " " " " = 4.329 " PROJ. F021-2(22)
 " " " " = 2.568 " PROJ. F021-2(34)

STATE HIGHWAY COMMISSION OF WISCONSIN MADISON, WIS.	FEDERAL WORKS AGENCY PUBLIC ROADS ADMINISTRATION
SURVEYOR <u>W.P.K.</u> NOTE BOOK <u>7586-KEY</u>	RECOMMENDED FOR APPROVAL DATE
DIVISION COMPUTER	DISTRICT ENGINEER
DIVISION CHECKER	PUBLIC ROADS ADMINISTRATION
CORRECT:	FEDERAL WORKS AGENCY
DATE <u>3/9/49</u> <u>S.L. Kazan</u>	APPROVED DATE
RECOMMENDED FOR APPROVAL DATE <u>3/12/49</u>	
DESIGN ENGINEER	DIVISION ENGINEER
CONSTRUCTION ENGINEER	PUBLIC WORKS ADMINISTRATION
APPROVED: <u>E.L. Reardon</u>	FEDERAL WORKS AGENCY
STATE HIGHWAY ENGINEER	

FIELD INVESTIGATED BY: E.C.E. & S.A.K. 06-10-1948
A.T.P. & S.A.K. MAY 3-1948