

Sheet Number	Total Sheets
1	8

STATE OF WISCONSIN  
 DEPARTMENT OF TRANSPORTATION  
 DIVISION OF HIGHWAYS

PLAN AND PROFILE OF PROPOSED

C.T.H. "YY" - C.T.H. "CC"  
 U.S.H. 8  
 LINCOLN COUNTY  
 PROJECT T 021-2(24)

Scales  
 Profile Hor. lin. = 100 ft. Vert. lin. = 10 ft.  
 Cross Sections Hor. lin. = Vert. lin. =

Index of Sheets

Sheet No.	1	Title
Sheet No.	2	Typical Cross Sections
Sheet No.	2	Estimate of Quantities
Sheet No.	—	Miscellaneous Quantities
Sheet No.	—	Right of Way Plat
Sheet No.	3-7	Plan and Profile Sta.
Sheet No.	8-8.4	Standard Details
Sheet No.	—	Drainage Structures
Sheet No.	—	Cross Sections

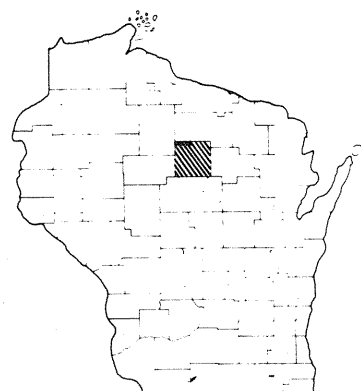

Design Designation

A.D.T.	1968	=	1,200
A.D.T.	1988	=	3,000
D.H.V.		=	360
D.		=	65%
T.		=	15%
V.		=	70 M. P. H.

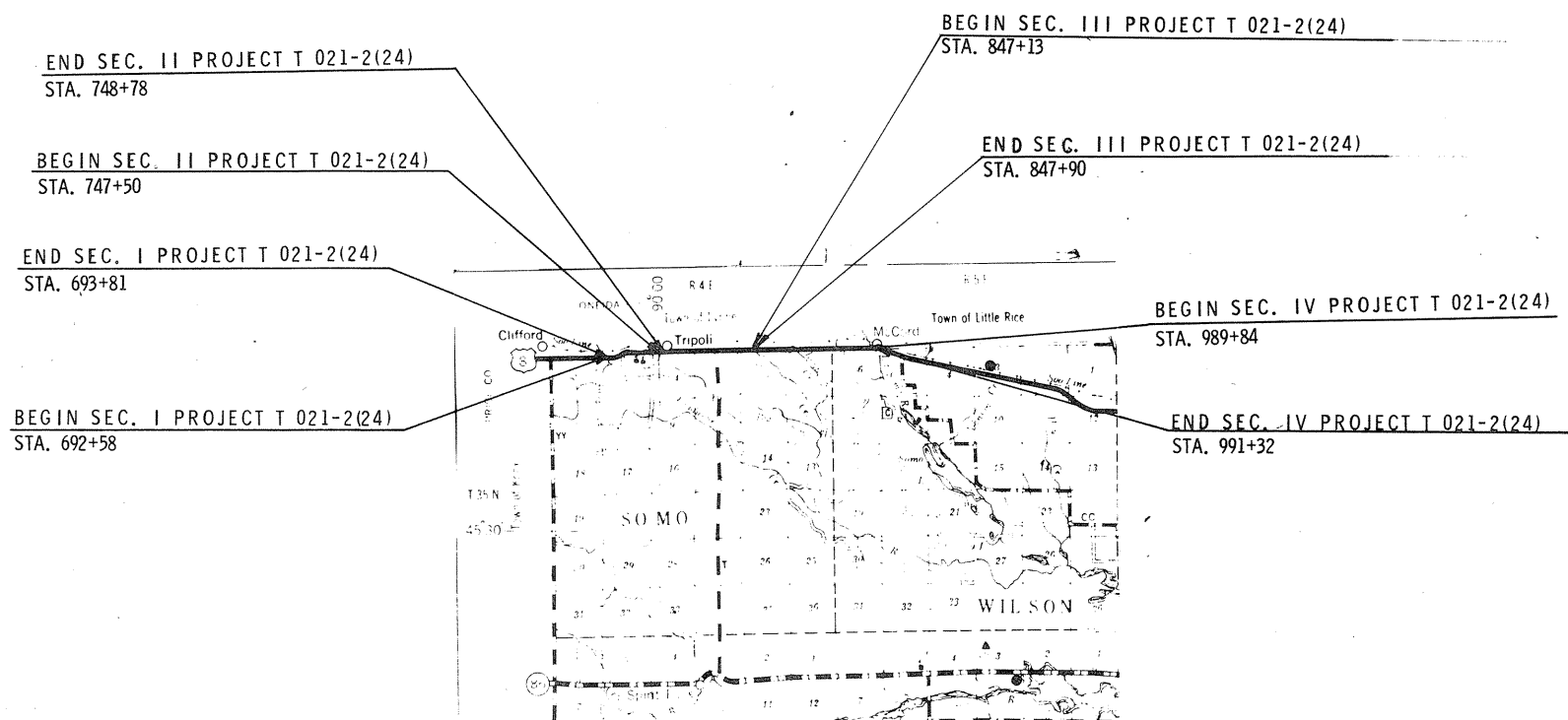

Conventional Signs

State Line	-----	Culverts in Place	—
County Line	-----	Drop Inlet	—
Township or Range Line	-----	Power Pole	—
Section Line	-----	Telephone or Telegraph Line	—
New Right of Way Line	-----	Right of Way Boundary	—
Present Right of Way Line	-----	Ground Elevation	—
Wire Fence	{ Woven Barbed	Grade Elevation	—
Lot Line	-----		
Corporate or City Limits	-----		
Property Line	-----		
Traveled Way or P.E.	-----		
Railroads	-----		
Base of Survey Line	-----		

Layout

1" = 2 MI.

Total Net Length of Centerline = 0.090 Mi.

STATE OF WISCONSIN DEPARTMENT OF TRANSPORTATION DIVISION OF HIGHWAYS	
Surveyor <b>T. SONNENBERG</b>	Note Book <b>335</b>
District Computer <b>E. SEIDLER</b>	M.O. Checker <b>W. H. B.</b>
District Checker <b>G. WINAT</b>	Correct
Correct:	
Date <b>4/12/68</b>	<i>Max Smith</i> District Engineer
Recommended for Approval:	
Date <b>4/25/68</b>	<i>E.J. Byrd</i> Chief Design Engineer
Approved:	
Date <b>4/25/68</b>	<i>A. Burmeister</i> State Highway Engineer
DEPARTMENT OF TRANSPORTATION FEDERAL HIGHWAY ADMINISTRATION BUREAU OF PUBLIC ROADS WISCONSIN DIVISION	
Approved:	
Date _____ Division Engineer	