

FED. ROAD DIST. NO.	STATE	FED. AID PROJ. NO.	SHEET NO.	TOTAL SHEETS
4	WIS.	335A-RE & 335D-18.2 WITH 335B	4	59

DIVISION JOB NO. 7966  
REVISED

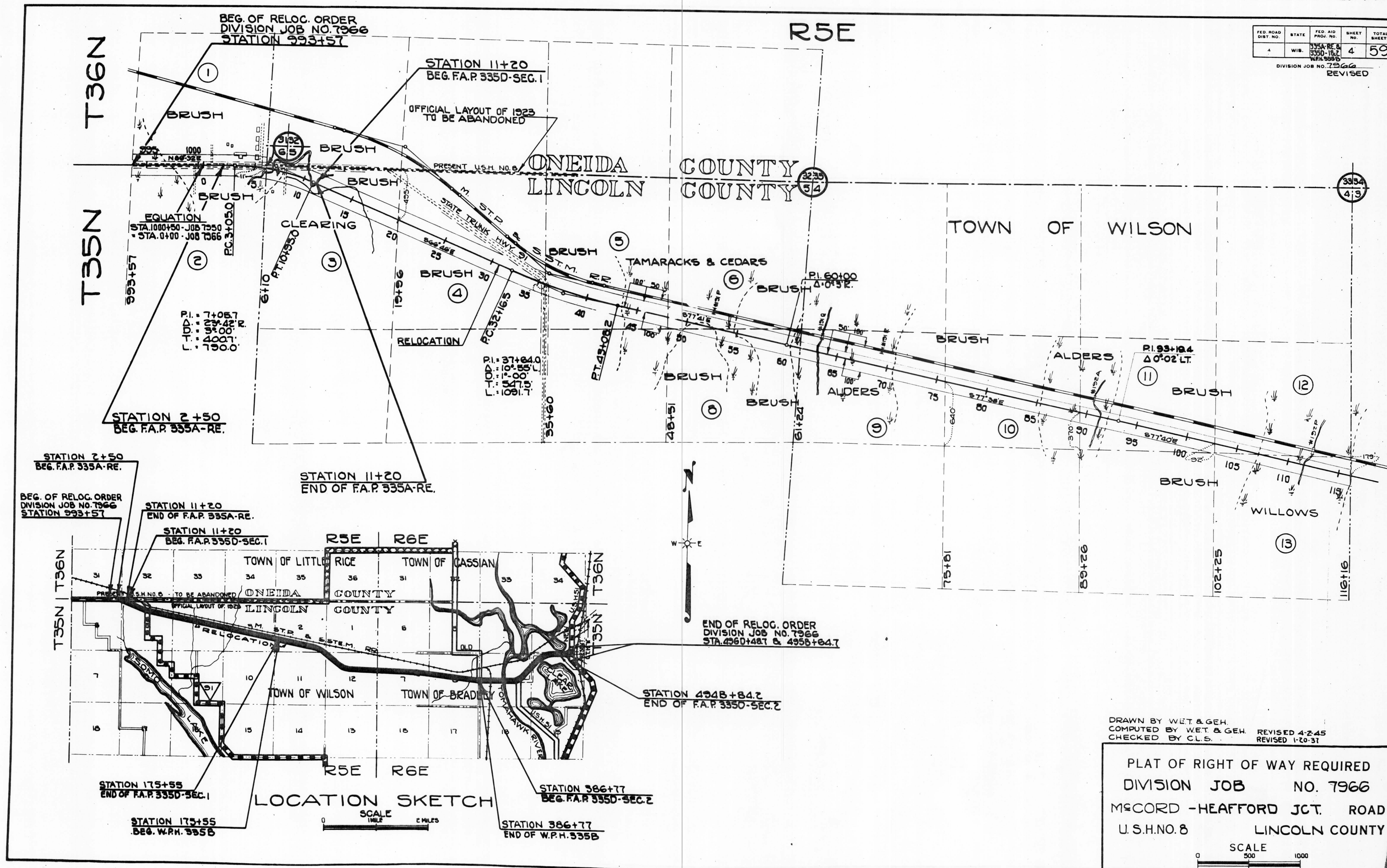

DRAWN BY WET & GEH.  
COMPUTED BY WET & GEH.  
CHECKED BY C.L.S.

REVISED 4-2-45  
REVISED 1-20-37

**PLAT OF RIGHT OF WAY REQUIRED**  
**DIVISION JOB NO. 7966**  
**MCCORD - HEAFFORD JCT. ROAD**  
**U.S.H.NO. 8 LINCOLN COUNTY**

**SCALE**  
0 500 1000