

Index of Sheets

Sheet No.	1	Title
Sheet No.	2-2.8	Typical Sections and Details
Sheet No.	3-3.2	Estimate of Quantities
Sheet No.	3A-3B	Miscellaneous Quantities
Sheet No.	4-4.3	Right of Way Plat
Sheet No.	5-5.10	Plan and Profile
Sheet No.	6-6.12	Standard Detail Drawings
Sheet No.	—	Sign Plates
Sheet No.	—	Structure Plans
Sheet No.	—	Computer Earthwork Data
Sheet No.	9-9.27	Cross Sections

TOTAL SHEETS = 74

STATE OF WISCONSIN DEPARTMENT OF TRANSPORTATION

PLAN OF PROPOSED IMPROVEMENT

BRADLEY-RHINELANDER TOMAHAWK-MINOCQUA

HEAFFORD JCT. OVERHEAD HEAFFORD JCT. INTERSECTION TOMAHAWK-NORTH COUNTY LINE

U.S.H. 8, LINCOLN COUNTY U.S.H. 51, LINCOLN COUNTY

STATE PROJECT	FEDERAL PROJECT	
	PROJECT	CONTRACT
1174-04-70	RS 1332(2)	I
1595-00-74	BRF 021(42)	I
1595-00-75	F 021(43)	I

STATE PROJECT NUMBER 1595-00-74	STATE PROJECT NUMBER 1595-00-75	STATE PROJECT NUMBER 1174-04-70
---	---	---

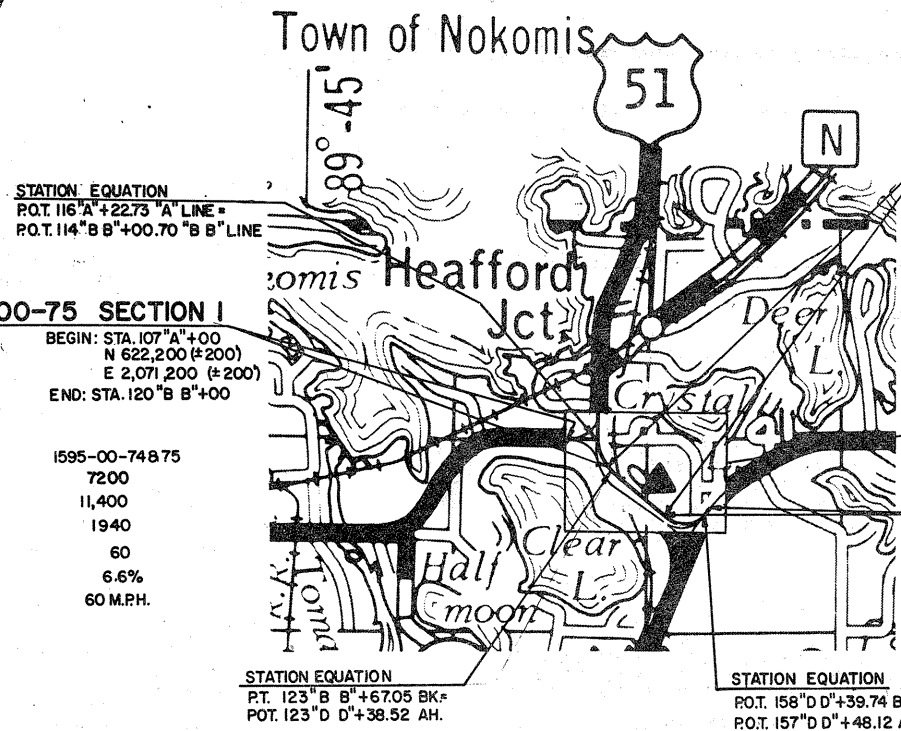
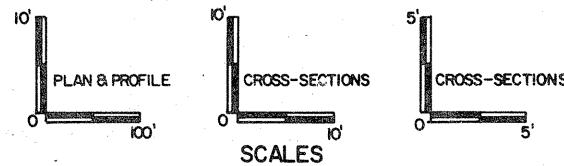
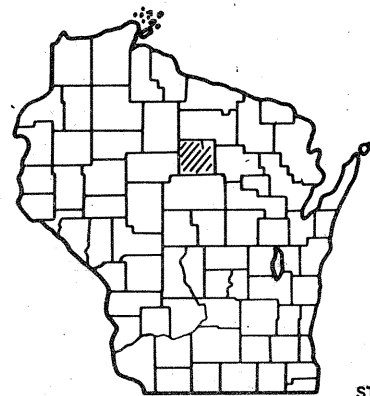

PROJECT 1595-00-74
 BEGIN: STA. 120^B+00
 N 621,600 (±200')
 E 2,072,300 (±200')
 END: STA. 138^D+00

STATION EQUATION
 P.O.T. 109^B+00 BK =
 P.O.T. 255+44 AH.

PROJECT 1595-00-75 SECTION 2
 BEGIN: STA. 138^D+00
 END: STA. 167^D+00

PROJECT 1174-04-70 SECTION 1
 BEGIN: STA. 496+70
 N 597,300 (±200')
 E 2,069,400 (±200')
 END: STA. 19^C+56.88

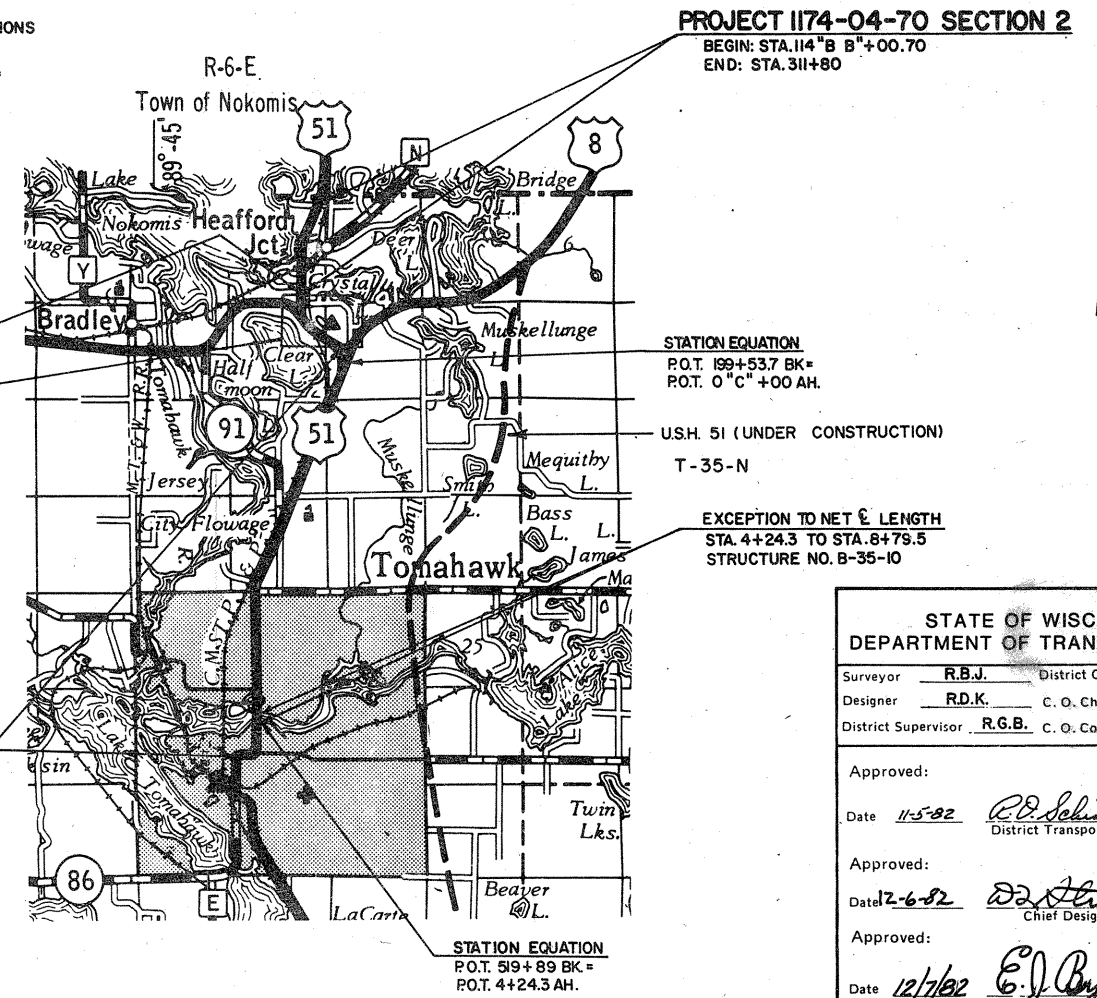

Design Designation

	1174-04-70	1595-00-74&75
A.D.T.	1983 = 7900	7200
A.D.T.	2003 = 12,200	11,400
D.H.V.	= 2070	1940
D.	= 60	60
T.	= 6.6%	6.6%
V.	= 60 M.P.H.	60 M.P.H.

Conventional Signs

County Line	-----	Caution Symbol	Combustible fluids under pressure	
Township or Range Line	-----	Railroads		
Section Line	-----	Fence		
Corporate or City Limits	-----	Culverts in Place		
Property line	-----	Culverts Required		
Lot Line	-----	Power Pole		
Existing Right of Way Line	-----	Telephone or Telegraph Pole		
New Right of Way Line	-----	Right of Way Markers		
Base or Survey Line	-----	Marsh		
Slope Intercept	-----	Wooded Area		
Existing Roadway or Private Entrance	-----	Grade Elevation		

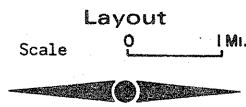

Total Net Length of Centerline = PROJECT 1174-04-70, 5.584 MI.
 PROJECT 1595-00-74, 0.346 MI.
 PROJECT 1595-00-75, 0.855 MI.
 TOTAL 6.785 Miles

COORDINATES SCALED FROM U.S.G.S. TOPOGRAPHIC MAPS
 CENTRAL ZONE TOMAHAWK, WISCONSIN AND HEAFFORD
 JUNCTION, WISCONSIN QUADRANGLES FOR IDENTIFICATION ONLY

**STATE OF WISCONSIN
DEPARTMENT OF TRANSPORTATION**

Surveyor R.B.J. District Checker F.V.S.
 Designer R.D.K. C. O. Checker BUE
 District Supervisor R.G.B. C. O. Coordinator _____

Approved: _____
 Date 11-5-82 R.D. Schindler
 District Transportation Director

Approved: _____
 Date 12-6-82 D.D. Strand
 Chief Design Engineer

Approved: _____
 Date 12/7/82 E.J. Boyte
 Director of Development

U. S. DEPARTMENT OF TRANSPORTATION
 FEDERAL HIGHWAY ADMINISTRATION
 REGION 5 WISCONSIN DIVISION

Approved: _____
 Date _____
 Division Administrator