

CURVE 9
 PI STA 615+90.198 (A)
 DELTA= 4°39'48.99" L.L.
 D= 1° 0' 0.00"
 T=233.309
 L=466.361
 R=5729.578
 PC STA 613+56.889 (A)
 PT STA 618+23.250 (A)
 S.E.=0.027%
 R.O.=175'

CURVE 10
 PI STA 630+98.479 (A)
 DELTA= 5°57'48.08" L.L.
 D= 1° 0' 0.00"
 T=298.437
 L=596.356
 R=5723.578
 PC STA 627+90.041 (A)
 PT STA 633+86.377 (A)
 S.E.=0.027%
 R.O.=175'

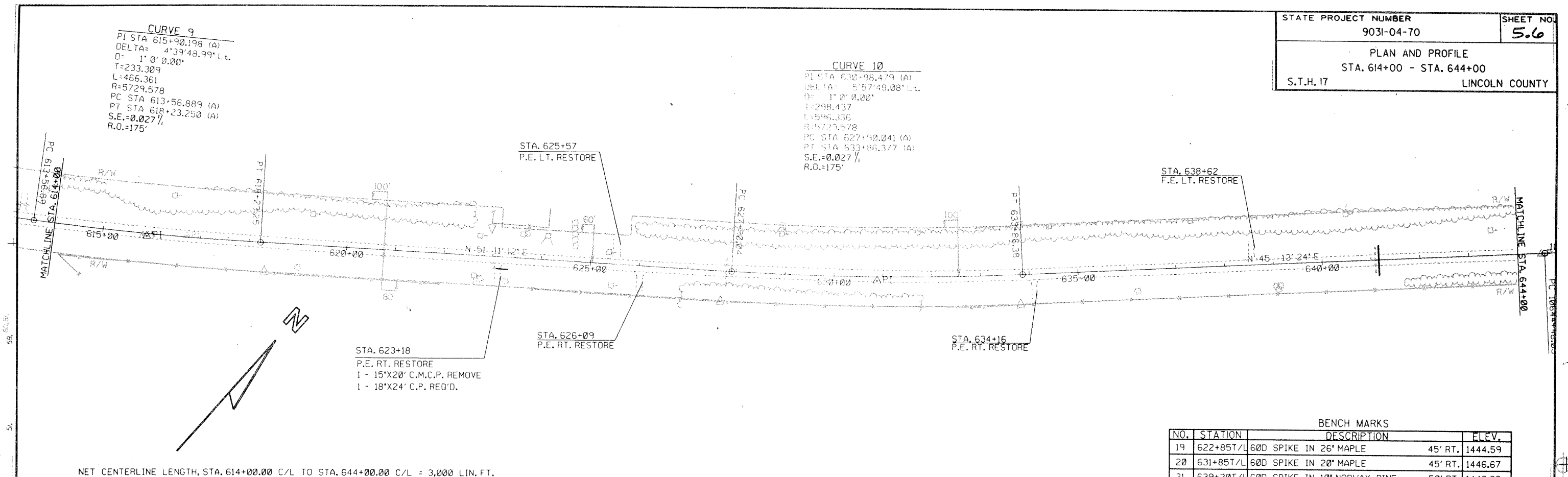

BENCH MARKS

NO.	STATION	DESCRIPTION	ELEV.
19	622+85T/L	600 SPIKE IN 26' MAPLE	45' RT. 1444.59
20	631+85T/L	600 SPIKE IN 20' MAPLE	45' RT. 1446.67
21	639+20T/L	600 SPIKE IN 10' NORWAY PINE	50' RT. 1446.38

