

**CURVE 5**  
 PI STA 548+62.298 (A)  
 DELTA= 13°47'44.06" L.t.  
 D= 2° 0' 0.00"  
 T=346.565  
 L=689.779  
 R=2864.789  
 PC STA 545+15.733 (A)  
 PT STA 552+05.512 (A)  
 S.E.=0.045 1/4  
 R.O.=175'

**CURVE 6**  
 PI STA 566+84.377 (A)  
 DELTA= 24°37'26.92" L.t.  
 D= 4°29'59.99"  
 T=277.892  
 L=547.203  
 R=1273.240  
 PC STA 564+06.484 (A)  
 PT STA 569+53.688 (A)  
 S.E.=SEE X-SECTIONS

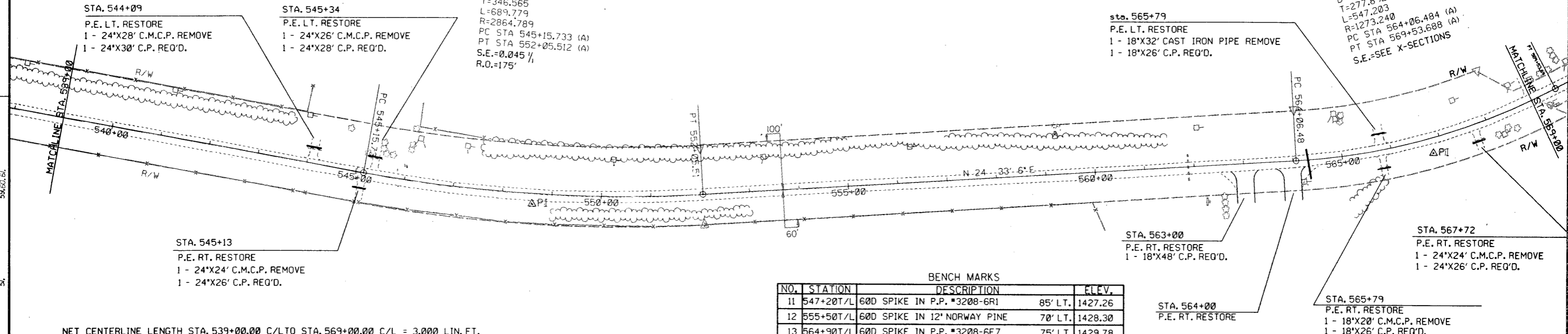

BENCH MARKS			
NO.	STATION	DESCRIPTION	ELEV.
11	547+20T/L	60D SPIKE IN P.P. #3208-6R1	85' LT. 1427.26
12	555+50T/L	60D SPIKE IN 12" NORWAY PINE	70' LT. 1428.30
13	564+90T/L	60D SPIKE IN P.P. #3208-6E7	75' LT. 1429.78

NET CENTERLINE LENGTH STA. 539+00.00 C/L TO STA. 569+00.00 C/L = 3,000 LIN. FT.

