

STATE PROJECT NUMBER	SHEET NO
9031-3-71	5.2
PLAN & PROFILE STA. 570+00 - STA. 600+00 FOR LANGLADE, ONEIDA & LINCOLN COUNTIES	
S.T.H. 17	

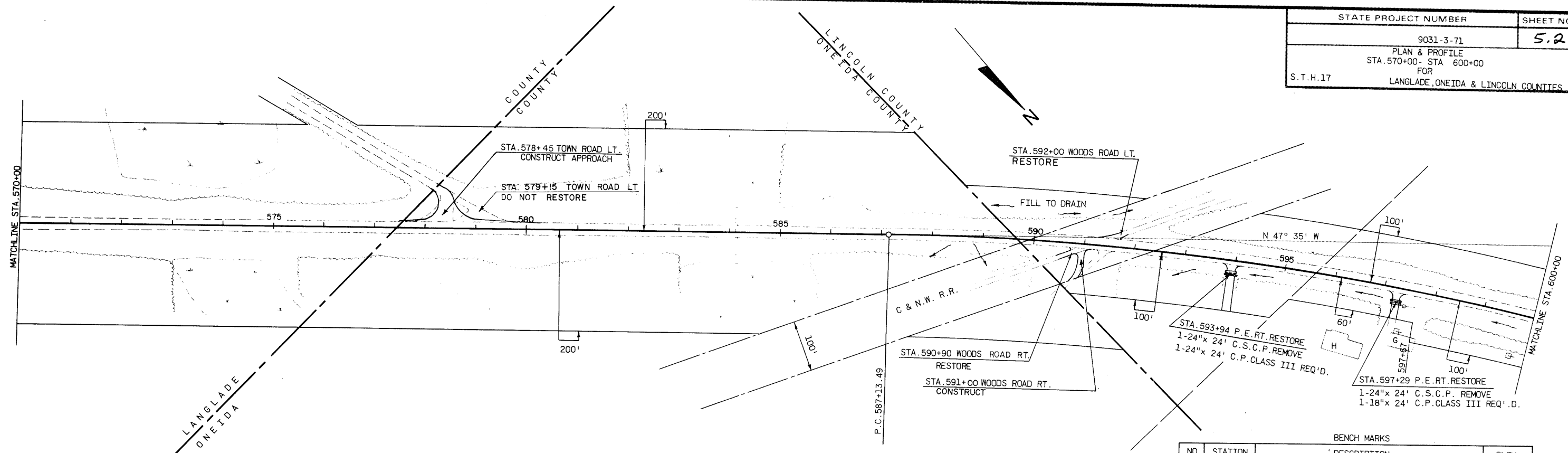

NET CENTER LINE LENGTH STA. 570+00 - STA. 600+00 = 3,000.00 LIN. FT.

BENCH MARKS

NO.	STATION	DESCRIPTION	ELEV.
15	577+00	BOLT IN 10" WHITE BIRCH	57' RT. 1678.58
16	588+00	BOLT IN 12" ASPEN	60' LT. 1677.35
17	597+70	BOLT IN 9" WHITE BIRCH	56' RT. 1696.53

UNCL.	2149	CU. YD.
FILL	5999	CU. YD.
SHG.	25%	
BORROW	5350	CU. YD.

