

COUNTY AND HIGHWAY	ROUTE AND SECTION	CLASS AND AGREEMENT		B. P. R. REGION DIVISION	SHEET NUMBER	TOTAL SHEETS
		STATE	FEDERAL			
35 2	189.0	21.9		4 WIS.	4	
CONST. PROJECT						

BEGIN RELOCATION ORDER
 PROJECT T 0189 (9), STA. 97 + 00
 385.9' N. and 260.2' W. of the S. 1/4 cor.,
 Sec. 5, T 31 N., R 7 E

END RELOCATION ORDER
 PROJECT T 0189 (9), STA. 105 + 03.5
 1125.4' N. and 29.8' E. of the S. 1/4 cor.,
 Sec. 5, T 31 N., R 7 E

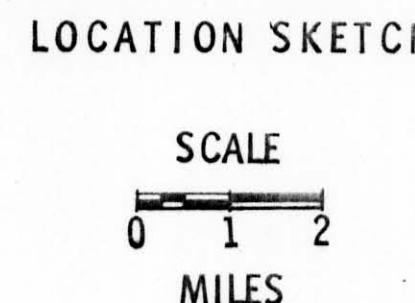
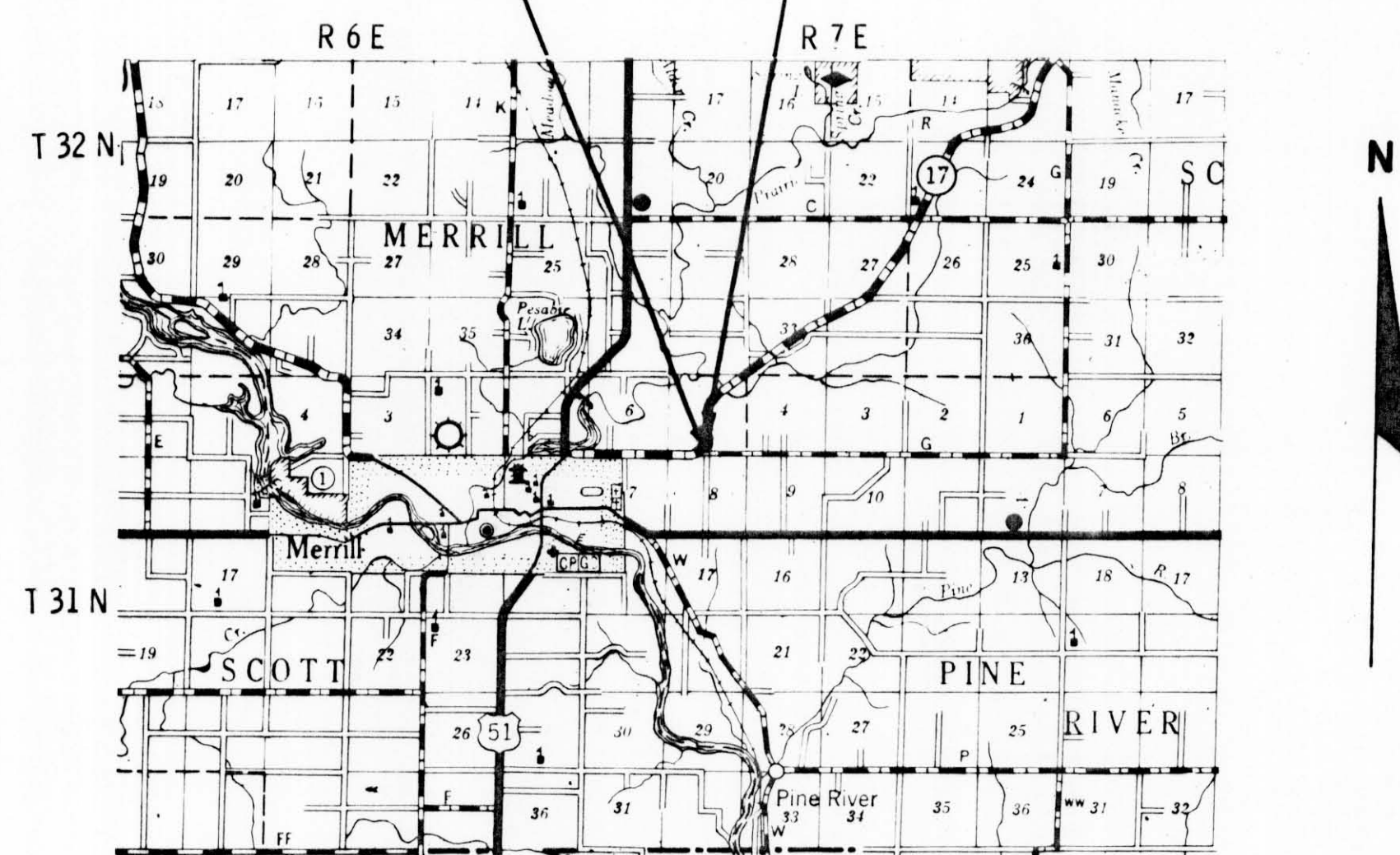

SCHEDULE OF LANDS AND INTERESTS REQUIRED				
PARCEL NUMBER	SHEET NUMBER	OWNER	INTERESTS REQUIRED	ACRES
1.	4.1	WALTER R. PREY	FEE	0.34

- STANDARD ABBREVIATIONS
- AC. ACRES
 - CONST. CONSTRUCTION
 - COR. CORNER
 - C.T.H. COUNTY TRUNK HIGHWAY
 - D. DEGREE OF CURVE
 - E. EXTERNAL DISTANCE
 - H. HOUSE
 - L. LENGTH OF CURVE
 - NE NORTHEAST
 - NW NORTHWEST
 - P. PAGE
 - P.C. POINT OF CURVATURE
 - P.I. POINT OF INTERSECTION
 - P.T. POINT OF TANGENCY
 - PROJ. PROJECT
 - SEC. SECTION
 - SE SOUTHEAST
 - SW SOUTHWEST
 - S.T.H. STATE TRUNK HIGHWAY
 - STA. STATION
 - T. TANGENT LENGTH OF CURVE
 - V. VOLUME

REVISION DATE	

STATE HIGHWAY COMMISSION OF WISCONSIN
PLAT OF RIGHT OF WAY REQUIRED
 PROJECT T 0189 (9)
 MERRILL - DUDLEY ROAD
 S.T.H. 17 LINCOLN COUNTY

SCALE
 0 100 200
 FEET

LENGTH 0.042 MILES DATED Feb. 24, 1966