

PAR. NO.	OWNER
101	GUSTAV GROSS BERTHA (H.W.)
DESCRIPTION	
NW-NW SEC. 1, T.35N.,	
ACRES REQUIRE	
0.34	

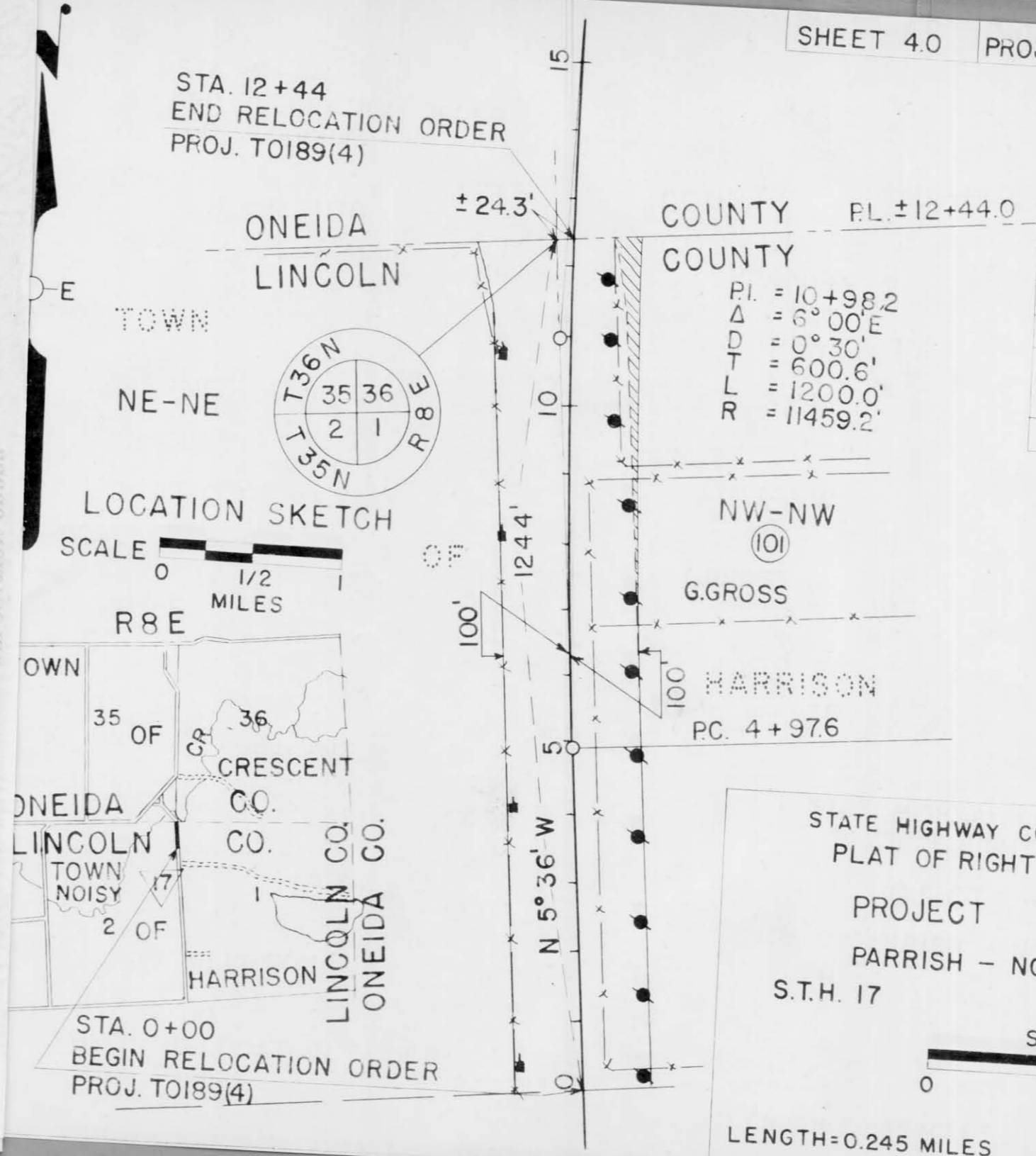

STATE HIGHWAY COMMISSION OF WISCONSIN
 PLAT OF RIGHT OF WAY REQUIRED
 PROJECT TO189(4)
 PARRISH - NO. CO. LINE ROAD
 S.T.H. 17
 LINCOLN COUNTY
 SCALE
 0 200' 400'
 LENGTH=0.245 MILES
 DATE MAR. 4,

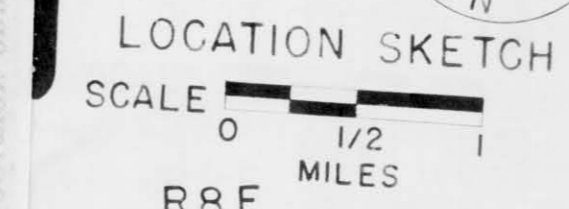

BY STATE HIGHWAY COMMISSION OF WISCONSIN
 RELOCATION ORDER
 ONEIDA COUNTY
 LINCOLN COUNTY
 TOWN NOISY
 CRESCENT CO.
 LINCOLN CO.
 ONEIDA CO.

STA. 12+44
 END RELOCATION ORDER
 PROJ. TO189(4)

STA. 0+00
 BEGIN RELOCATION ORDER
 PROJ. TO189(4)

THE STATE HIGHWAY COMMISSION OF WISCONSIN
 RELOCATION ORDER
 ONEIDA COUNTY
 LINCOLN COUNTY
 TOWN NOISY
 CRESCENT CO.
 LINCOLN CO.
 ONEIDA CO.

THE STATE HIGHWAY COMMISSION OF WISCONSIN
 RELOCATION ORDER
 ONEIDA COUNTY
 LINCOLN COUNTY
 TOWN NOISY
 CRESCENT CO.
 LINCOLN CO.
 ONEIDA CO.

THE STATE HIGHWAY COMMISSION OF WISCONSIN
 RELOCATION ORDER
 ONEIDA COUNTY
 LINCOLN COUNTY
 TOWN NOISY
 CRESCENT CO.
 LINCOLN CO.
 ONEIDA CO.