

STANDARD ABBREVIATIONS

ABND.	MAILING ADDRESS	#0000
ABS.	MANHOLE	M.H.
A.P.	MANUFACTURING	MFG.
AC.	MAXIMUM	MAX.
ADD.	MEASURED	(M)
AGRI.	MILE	MI.
AH.	MILK ROOM	M.R.
ET. AL.	MINIMUM	MIN.
ET. UX.	MONUMENT	MON.
APT.	MOTEL	MO.
(A)	MUNICIPAL	MCPL.
A. &	NORTHEAST	NE
AVE.	NORTHWEST	NW
BK.	NUMBER	NO.
B.	OUTLOT	O.L.
B	PARALLEL	P.L.
B. L. C.	PAVEMENT	PAVT.
BIT.	PERMANENT	PERM.
BLK.	POINT OF CURVATURE	P.C.
BLVD.	POINT OF INTERSECTION	P.I.
BRK.	POINT OF TANGENCY	P.T.
BLDGS.	POINT OF COMPOUND CURVE	P.C.C.
C. B.	POINT OF REVERSE CURVE	P.R.C.
CEM.	POINT ON CURVE	P.O.C.
€	PRIVATE DRIVE	P.D.
Δ	PROJECT	PROJ.
CH.	PROPERTY LINE	P.L.
CH. CH.	QUIT CLAIM DEED	Q.C.D.
C.H.	RADIUS	R
COMM.	RAILROAD	RR.
COM.	RAILWAY	RY.
(C)	REFERENCE LINE	R
CONC.	RELOCATED	REL.
CONST.	REQUIRED	REQ'D.
C. C.	RESIDENTIAL	RES.
COR.	RESTAURANT	REST.
CORP.	RIGHT	RT.
CORR.	RIGHT OF WAY	R/W
CO.	ROAD	RD.
C. T. H.	ROADWAY	RDWY.
CR.	SANITARY	SAN.
CULV.	SCALED	(S)
(D)	SCHOOL	SCH.
D	SECTION	SEC.
DISP.	SERVICE STATION	S.S.
DIST.	SEPTIC TANK	SEP.
DR.	SIDEWALK	SWK.
DWY.	SHED	S.
EST.	SOUTHEAST	SE
EX.	SOUTHWEST	SW
E	SPECIAL CROSSING	S.C.
FACT.	SPECIAL DRIVE	S.D.
F. A. P.	SQUARE	SQ.
F.E.	STANDARD	STD.
F.H.	STATE TRUNK HIGHWAY	S.T.H.
FT.	STATION	STA.
FDN.	STORY	STY.
FR.	STREET	ST.
G.	SUBDIVISION	SUBD.
GOV'T.	SURVEY	(S)
G.H.	TANGENT	TAN.
HWY.	TANGENT LENGTH OF CURVE	T
HO.	TAPER	TAP.
H.	TAVERN	TAV.
H.T.	TEMPORARY	TEMP.
IN.	TRANSIT LINE	T
INC.	TRANSMISSION TOWER	T.T.
INCL.	UNITED STATES COAST & GEODETIC SURVEY	U.S.C. & G.S.
I.	UNITED STATES GEOLOGICAL SURVEY	U.S.G.S.
I.H.	UNITED STATE HIGHWAY	U.S. Highway
I.P.	VENDEE	VDE.
IS.	VENDOR	VDR.
LT.	VITRIFIED	VDR.
L	WAREHOUSE	WH.
LSE.	WATER TOWER	W.T.
LSR.	WELL	W.
L.H.E.	WINDMILL	WM.
M.S.	WOOD	WD.
MAG.	LAND CONTRACT	L.C.

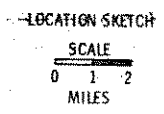
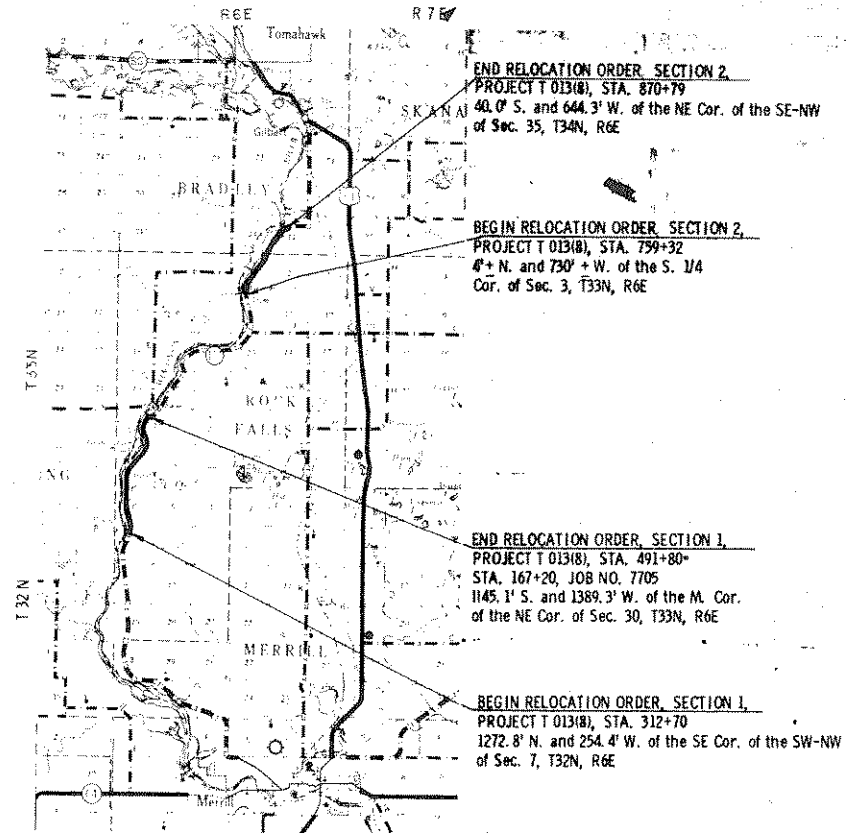

CONVENTIONAL SIGNS

STATE LINE	-----	CEMETERY	Cem.	HIGHWAY HIGHWAY SEPARATION	=====
COUNTY LINE	-----	FOUNDATION	Fdn.	HIGHWAY OVERPASS	=====
TOWNSHIP AND RANGE LINES	-----	GAS PUMP ISLAND	Gas Pump	RAIL LINE OVERPASS	=====
SECTION LINE	-----	BUILDING	Type	ALL OTHER BRIDGES	=====
QUARTER LINE	-----	IRON PIN	I.P.	STREAM OR RIVER	=====
SIXTEENTH LINE	-----	POWER POLE	•	LAKE	(name)
NEW CENTERLINE	-----	TELEPHONE POLE	•	CATTLE PASS	=====
NEW R/W LINE	-----	RAIL LINE	=====	€ RELOCATED STREAM OR RIVER	=====
OLD R/W LINE	-----	TRANSMISSION TOWER AND LINE	-----	TRAVELED WAY (Shown only in area of Frontage Roads, Interchanges or Dual Lanes)	=====
PROPERTY LINE	P.L. +00.0	UNDERGROUND CABLE MARKER	-----		
CORPORATE LIMITS	NAME slope intercept	WELL	•		
SLOPE INTERCEPTS	-----	STONE MONUMENT	•		
LOT, TIE AND OTHER MINOR DASHED LINES	-----	SEPTIC TANK	•		
UNDERGROUND FACILITY (POWER, TELEPHONE, TELEGRAPH, GAS, ETC.)	(Name or Type)	WINDMILL	•		
NO ACCESS	=====				
LIMITED HIGHWAY EASEMENT	=====				

COUNTY AND HIGHWAY	ROUTE AND SECTION	CLASS AND AGREEMENT STATE FEDERAL	B. F. R. REGION DIVISION	SHEET NUMBER	TOTAL SHEETS
35.2	13.0	21.8	4 WIS.	4	
CONST. PROJECT					
9305-2-21					

SCHEDULE OF LANDS AND INTERESTS REQUIRED

PARCEL NUMBER	SHEET NUMBER	OWNER	INTERESTS REQUIRED	ACRES
1	4.1 to 4.7	WISCONSIN PUBLIC SERVICE CORPORATION	SCENIC STRIP (FEE)	66.9
2				
3				
4	4.6	CLIFFORD HENKE	SCENIC STRIP (FEE)	0.4
5	4.7	EDWARD KAUFMAN	SCENIC EASEMENT	0.5
6	4.8 & 4.9	OWENS ILLINOIS GLASS COMPANY	SCENIC STRIP (FEE)	18.15
7	4.10	CAROL ROSE THIELMAN	SCENIC EASEMENT	4.3
8	4.10	CARL A. REEVES	SCENIC STRIP (FEE)	3.5
9	4.11	STANLEY RZEPA		
10	4.11 & 4.12	HELEN SYROKA	SCENIC STRIP (FEE)	1.2
11		CHRISTINE DRYDEN DOTTER	SCENIC STRIP (FEE)	7.6
12	4.12	BERTHA SCHIELD	SCENIC STRIP (FEE)	2.4
13				
14				
15				
16	4.7	W. R. TEUTEMACHER ET AL.	SCENIC EASEMENT	0.1
17	4.7	RHODA J. COOKE	SCENIC EASEMENT	0.1
18	4.7	LAWRENCE BROWN	SCENIC EASEMENT	0.1
19	4.10	FRANK V. JANNUSCH		
20		L. C. ROBERT D. MONROE	SCENIC EASEMENT	0.6

NOTE: BEARINGS SHOWN ON THIS PLAT ARE THE TRUE BEARINGS OF EACH TANGENT TO THE NEAREST MINUTE.

REVISION	DATE
1	5/20/65
2	6/18/65
3	6/28/65
4	8/21/65

STATE HIGHWAY COMMISSION OF WISCONSIN
PLAT OF RIGHT OF WAY REQUIRED
 PROJECT T 0131(8)
 MERRILL - GILBERT ROAD
 S. T. H. 107
 LINCOLN COUNTY
 LENGTH 5.503 MILES
 SCALE 1" = 200 FEET
 DATED JUNE 23, 1965