

Index of Sheets

|                 |                          |
|-----------------|--------------------------|
| Sheet No. 1     | Title                    |
| Sheet No. 2-2.1 | Typical Cross Sections   |
| Sheet No. 3     | Estimate of Quantities   |
| Sheet No. 3A    | Miscellaneous Quantities |
| Sheet No. 4-4.1 | Right of Way Plat        |
| Sheet No. 5-5.1 | Plan and Profile         |
| Sheet No. 6-6.5 | Standard Details         |
| Sheet No. —     | Structure Plans          |
| Sheet No. —     | Computer Earthwork Data  |
| Sheet No. 8-8.8 | Cross Sections           |

TOTAL SHEETS = 24



Design Designation

|             |       |
|-------------|-------|
| A.D.T. 1975 | = 185 |
| A.D.T. 1985 | = 215 |
| D.H.V.      | = 39  |
| D.          | = 60  |
| T.          | = 10  |
| V.          | = 55  |

Conventional Signs

|  |       |                               |       |
|--|-------|-------------------------------|-------|
| County Line  | ----- | Conduits in Place             | ----- |
| Township or Range Line                                   | ----- | Conduits Required             | ----- |
| Section Line   | ----- | Drop Inlet                    | ----- |
| New Right of Way Line                                    | ----- | Power Pole                    | ----- |
| Present Right of Way Line                                | ----- | Telephone or Telegraph Pole   | ----- |
| Wire Fence   | ----- | Right of Way Markers          | ----- |
| Corporate or City Limits                                 | ----- | Reference Stake for Hubs Only | ----- |
| Property Line  | ----- | Mars                          | ----- |
| Traveled Way or P.E.                                     | ----- | Hedge                         | ----- |
| Railroads  | ----- | Trees                         | ----- |
| Base or Survey Line                                      | ----- | Ground Elevation              | ----- |
| Caution Symbol<br>(combustible fluids<br>under pressure) |       | Grade Elevation               | ----- |

STATE OF WISCONSIN  
DEPARTMENT OF TRANSPORTATION  
DIVISION OF HIGHWAYS

PLAN AND PROFILE OF PROPOSED

C.T.H. "J" - U.S.H. 51  
S.T.H. 107  
LINCOLN COUNTY

STATE PROJECT NUMBER  
9305-3-70

Scales  
Plan 1 in = 100 ft  
Profile Hor. 1 in = 100 ft Vert 1 in = 10 ft  
Cross Sections Hor 1 in = 5' Vert 1 in = 5'

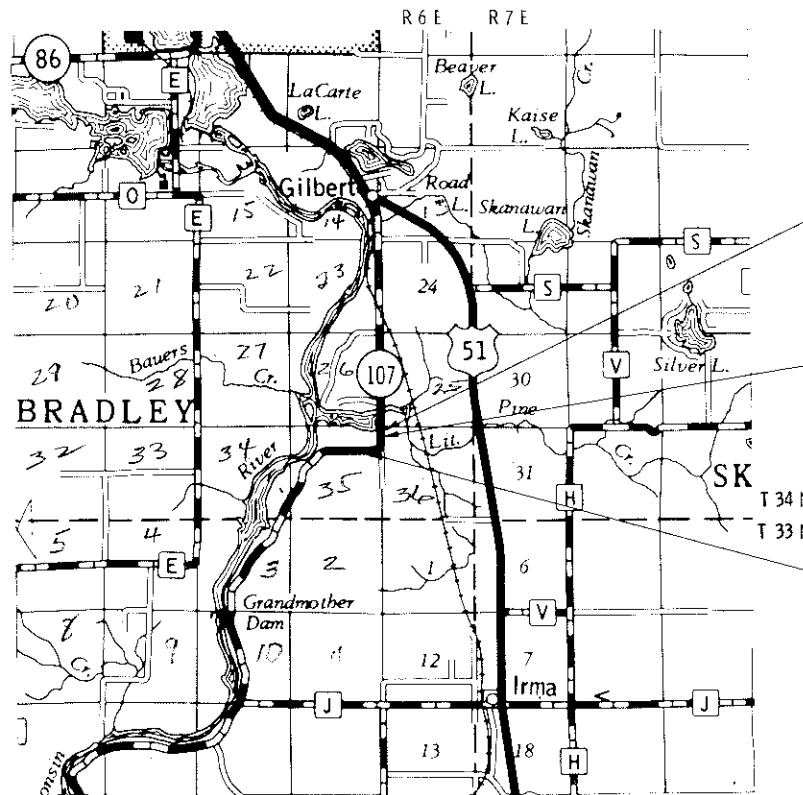

END PROJECT 9305-3-70  
STATION 237+50  
\* N 569,583.33 (±200')  
\* E 2,079,010.42 (±200')  
65.95' N. OF THE NE. COR.  
OF SEC. 35, T 34N, R 6E

STATION EQUATION - STA. 229+27.41 BK =  
STA. 233+80.82 AH.

BEGIN PROJECT 9305-3-70  
STATION 211+00  
\* N 568,281.25 (±200')  
\* E 2,077,968.75 (±200')  
1361.49' S AND 1114.17' W  
OF THE NE. COR. OF SEC.  
35, T 34N, R 6E

\* SCALED FROM U.S.G.S. TOPOGRAPHIC MAP, TOMAHAWK, WISCONSIN, QUADRANGLE FOR IDENTIFICATION ONLY.

Layout  
Scale 1" = 1 MILE  
Total Net Length of Centerline = 0.416 Mi.

ALL CO-ORDINATES SHOWN ON THIS PLAN  
ARE REFERENCED TO THE WISCONSIN  
CO-ORDINATE SYSTEM CENTRAL ZONE

|               |                 |          |
|---------------|-----------------|----------|
| STATE PROJECT | FEDERAL PROJECT |          |
| 9305-3-70     | PROJECT         | CONTRACT |
|               | HHS 013(1)      | 1        |

STATE OF WISCONSIN  
DEPARTMENT OF TRANSPORTATION  
DIVISION OF HIGHWAYS

Surveyor: E.O.D. District Checker: G.S.W.  
Designer: H.C.K. C.O. Checker: I.C.J.

Correct:

Date: 3/5/75 *R.D. Schindler*  
District Engineer

Recommended for Approval:

Date: 6/3/75 *J.O. Hennard*  
Chief of Facilities Development

Approved:

Date: 6/3/75 *H.J. Juedler*  
District Highway Engineer

U.S. DEPARTMENT OF TRANSPORTATION  
FEDERAL HIGHWAY ADMINISTRATION  
REGION 5 WISCONSIN DIVISION

Approved:

Date:

Division Engineer