

NOTE: EXISTING CONDITIONS MAY VARY FROM THIS PLAN DUE TO SANITARY SEWER AND WATER CONSTRUCTION BY THE CITY OF MERRILL ALONG BUS. 51.

STATE PROJECT NUMBER 9675-10-70 SHEET NO. 5.3
 PLAN AND PROFILE SHEET
 STA. 515+00 - STA. 521+00
 U.S.H. 51 LINCOLN COUNTY

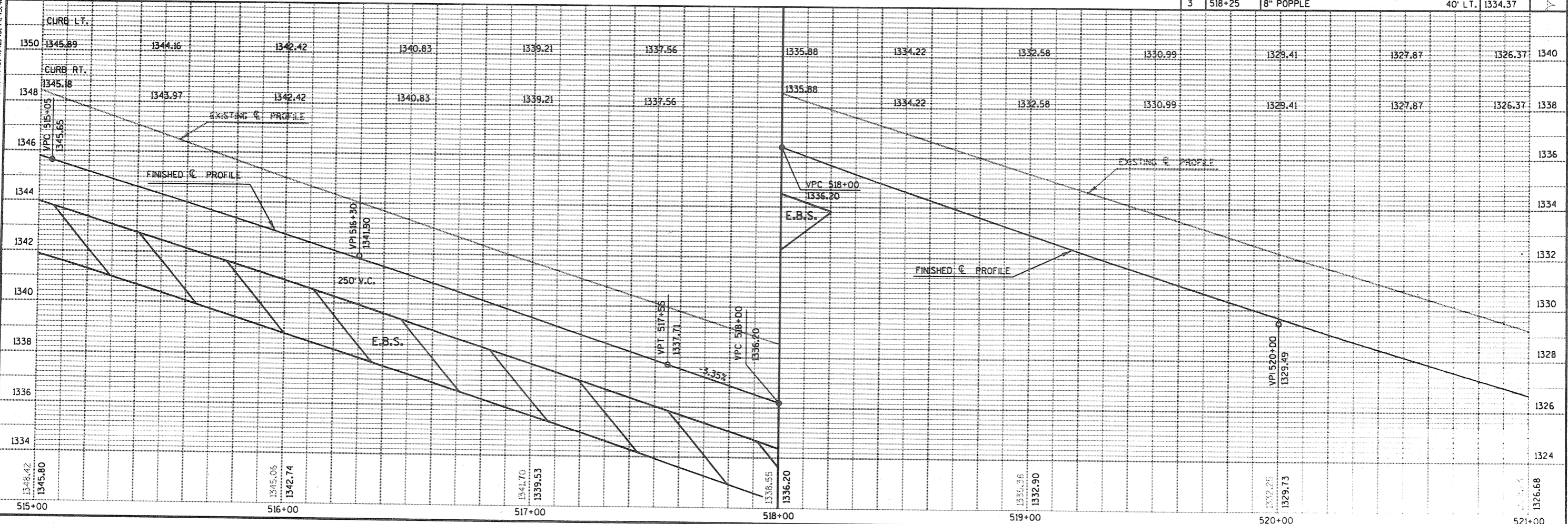
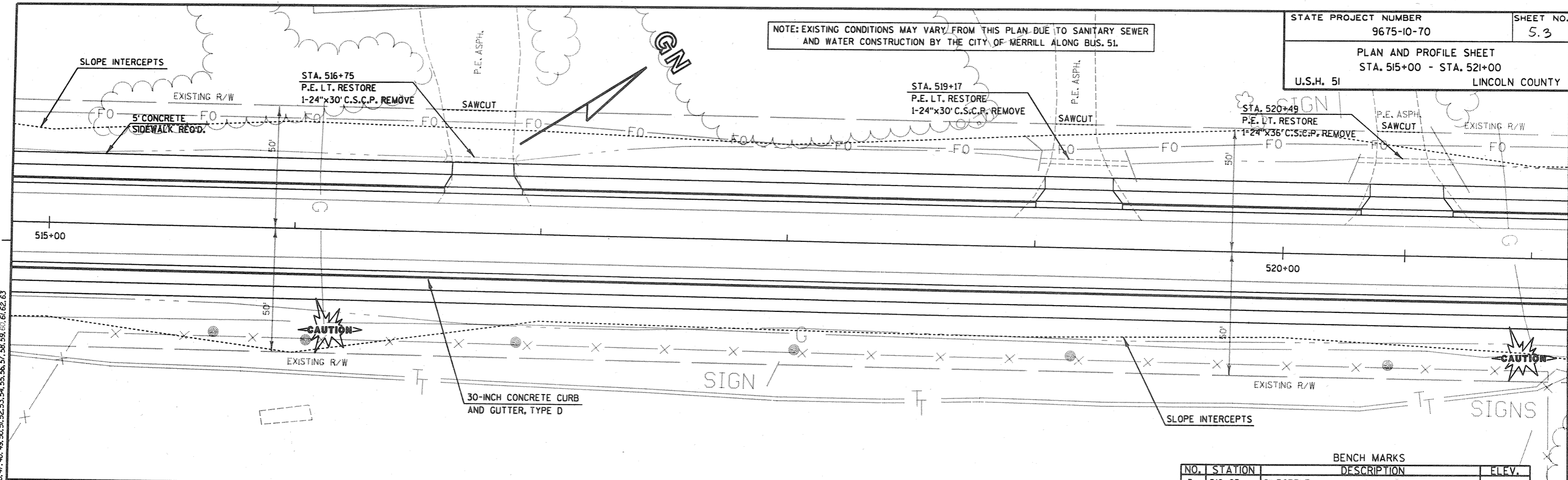

BENCH MARKS			
NO.	STATION	DESCRIPTION	ELEV.
3	518+25	8" POPPLE 40' LT.	1334.37

LEVELS ON - 1, 2, 3, 4, 5, 6, 7, 8, 9, 10, 11, 12, 13, 14, 15, 16, 17, 18, 19, 20, 21, 22, 23, 24, 25, 26, 27, 28, 29, 30, 31, 32, 33, 34, 35, 36, 37, 38, 39, 40, 41, 42, 43, 44, 45, 46, 47, 48, 49, 50, 51, 52, 53, 54, 55, 56, 57, 58, 59, 60, 61, 62, 63

PLOT NAME: PLOT SCALE: