

WATER SYSTEM IMPROVEMENTS

TOMAHAWK, WISCONSIN

CONTRACT D

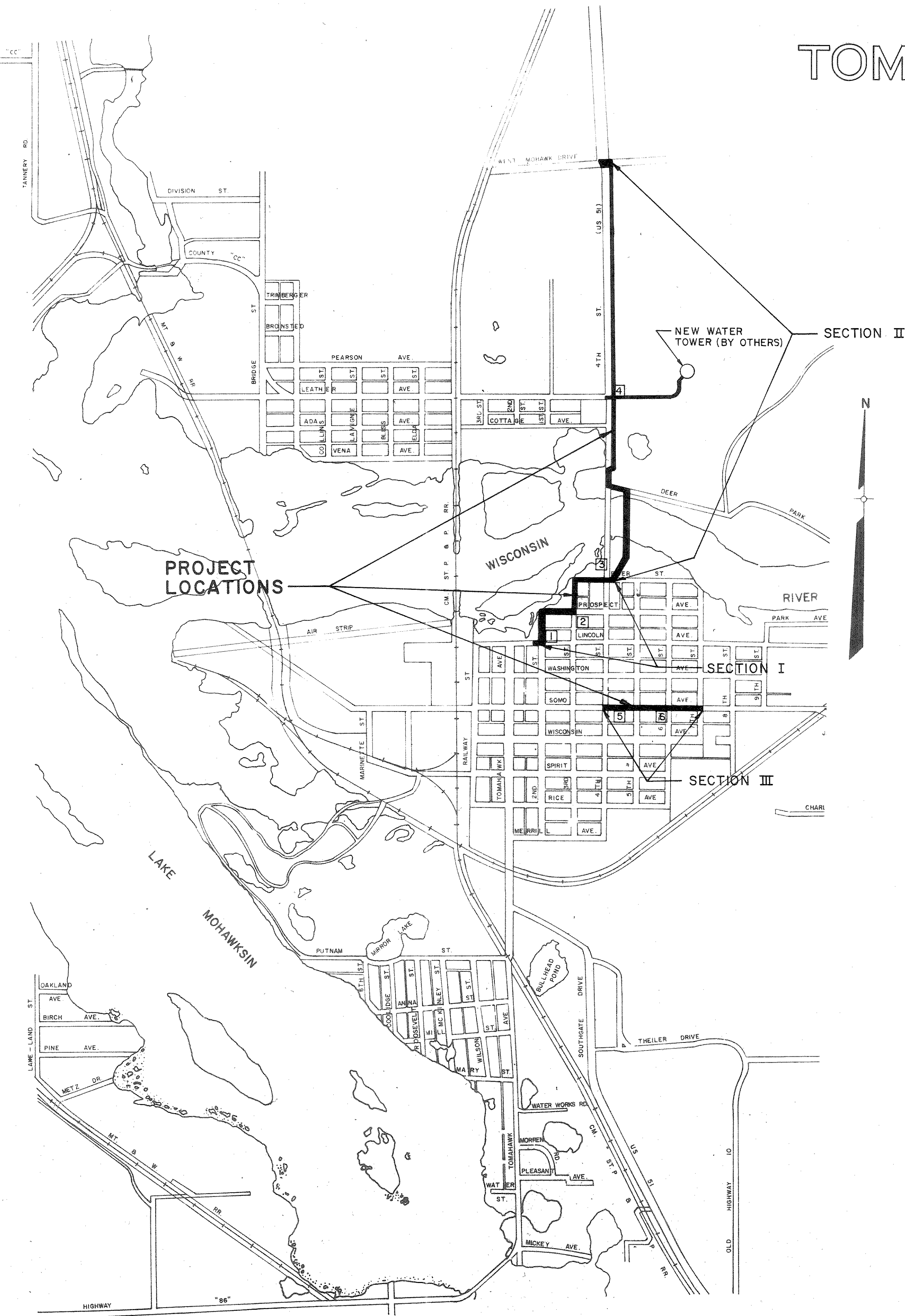

LOCALITY MAP



DESIGNER CSH	DRAWN BY CTR
CHECKED	APPROVED
DATE AUG., 1980	
SCALE 0' 500'	



WATER SYSTEM IMPROVEMENTS
 LOCALITY MAP, INDEX, LEGEND & BENCH MARKS
 TOMAHAWK, WISCONSIN

PROJECT NO. 10410.200
FILE NO. SK-10610
SHEET NO. 1 OF 11

INDEX

SHEET NO.	DESCRIPTION	FILE NO.
1.	LOCALITY MAP, INDEX, LEGEND & BENCH MARKS.....	SK-10610
SECTION I		
2.	2ND STREET FROM LINCOLN AVE. TO PROSPECT AVE. & PROSPECT AVENUE FROM 2ND ST. TO 3RD ST.....	SK-10609
3.	3RD STREET FROM PROSPECT AVE. TO RIVER ST. & RIVER STREET FROM 3RD ST. TO 4TH ST.....	SK-10608
SECTION II		
4.	4TH STREET - U.S.H. 51 FROM RIVER ST. TO DEER PARK RD. (STA. 70+00).....	SK-10607
5.	4TH STREET - U.S.H. 51 FROM STA. 70+00 TO LEATHER AVE. (STA. 81+00).....	SK-10606
6.	4TH STREET - U.S.H. 51 FROM STA. 81+00 TO STA. 92+00.....	SK-10605
7.	4TH STREET - U.S.H. 51 FROM STA. 92+00 TO STA. 102+00.....	SK-10604
8.	4TH STREET - U.S.H. 51 FROM STA. 102+00 TO W. MOHAWK DR.....	SK-10603
9.	WATER TOWER DRIVE FROM 4TH ST. TO WATER TOWER.....	SK-10602
SECTION III		
10.	SOMO AVENUE FROM 4TH ST. TO 7TH ST.....	SK-10601
DETAILS		
11.	THRUST BLOCKS & RESTRAINT DETAILS.....	SK-10600

BENCH MARKS

NUMBER	DESCRIPTION	U.S.G.S. ELEV.
1.	N.W. CORNER AT STOOP ON W. SIDE OF HSE 128, LINCOLN AVE.....	1449.98
2.	N.W. CORNER OF 1ST STEP OF CONC. PORCH, HSE @ S.E. CORNER PROSPECT AVE. & 3RD ST.....	1451.81
3.	STATE HIGHWAY B.M., 3" BRASS DISK IN 4"x4" CONC. POST, 150' N. OF RIVER ST. & 80' W OF C 4TH ST. (U.S.H. 51).....	1446.94
4.	SPIKE IN POWER POLE, N.E. CORNER LEATHER AVE. (C.T.H. CC) & 4TH ST. (U.S.H. 51)...	1443.03
5.	N.W. CORNER 1ST STEP AT HSE 20 SOMO AVE..	1449.09
6.	N.W. CORNER 1ST STEP AT HSE 128 SOMO AVE.	1450.46

LEGEND

	EXISTING FORCE MAIN
	NEW FORCE MAIN
	EXISTING SANITARY SEWER & MANHOLE - 48" & LARGER DOUBLE LINE
	NEW SANITARY SEWER & MANHOLE - 48" & LARGER DOUBLE LINE
	EXISTING STORM SEWER & MANHOLE - 48" & LARGER DOUBLE LINE
	NEW STORM SEWER & MANHOLE - 48" & LARGER DOUBLE LINE
	EXISTING WATER MAIN, HYDRANT, VALVE & HYDRANT WITH VALVE
	NEW WATER MAIN, HYDRANT, VALVE & HYDRANT WITH VALVE
	EXISTING GAS MAIN & VALVE
	EXISTING UNDERGROUND TELEPHONE CABLE, MANHOLE & VAULT
	EXISTING UNDERGROUND ELECTRIC CABLE, MANHOLE & VAULT
	UTILITIES TO BE ABANDONED
	ABANDONED UTILITIES
	STREET CENTERLINE & SURVEY CENTERLINE COMBINED
	FUTURE STREET OR RIGHT-OF-WAY LINE
	STREET OR RIGHT-OF-WAY LINE
	PROPERTY LINE
	SECTION LINE
	QUARTER SECTION LINE
	CONSTRUCTION LICENSE LIMITS
	EASEMENT
	CITY OR VILLAGE LIMITS
	MATCH LINE & BREAK LINE
	DITCH
	EDGE OF WATER
	TOE OF BANK
	TOP OF BANK
	EDGE OF DIRT
	EDGE OF GRAVEL
	EDGE OF CONCRETE
	EDGE OF BITUMINOUS PAVEMENT
	EXISTING CURB
	NEW STANDARD CURB & GUTTER
	NEW INTEGRAL CURB
	FUTURE CURB
	FENCE
	RAILROAD TRACKS
	CULVERTS
	EXISTING GRADE IN PROFILE
	ESTABLISHED GRADE IN PROFILE

- 1" IRON STAKE
- 2" IRON STAKE
- ▲ RIGHT-OF-WAY POST
- CONCRETE MONUMENT
- POWER POLE
- POWER & TELEPHONE POLE
- TELEPHONE POLE
- LAMP POLE
- GUY WIRE & GUY POLE
- MAIL BOX
- TELEPHONE BOOTH
- ROAD SIGN
- TELEPHONE PEDESTAL
- R/R CROSSING SIGNAL
- TRAFFIC SIGNAL
- SEPTIC TANK VENT
- ▲ SURVEY TRAVERSE POINT
- BENCH MARK NUMBER

- BUSH
- TREE (DECIDUOUS)
- TREE (CONIFEROUS)
- TREE STUMP
- WOODED AREA
- HEDGE
- TREE REMOVAL
- WOODED AREA REMOVAL
- MARSH
- BLOCK WALL
- STONE WALL
- BUILDINGS
- TELEPHONE CABLE MARKER
- GAS LINE MARKER
- EXISTING INLET BASIN
- NEW INLET BASIN
- WELL CASING CAP

AUG 5 1980
DONOHUE & ASSOC. INC.