

# LINCOLN COUNTY HIGHWAY DEPARTMENT VEHICLE STORAGE GARAGE ADDITION

MERRILL, WISCONSIN  
Project No. - 1999.029

JULY 2000

prepared for  
LINCOLN COUNTY HIGHWAY DEPARTMENT  
100 COOPER STREET  
MERRILL, WI

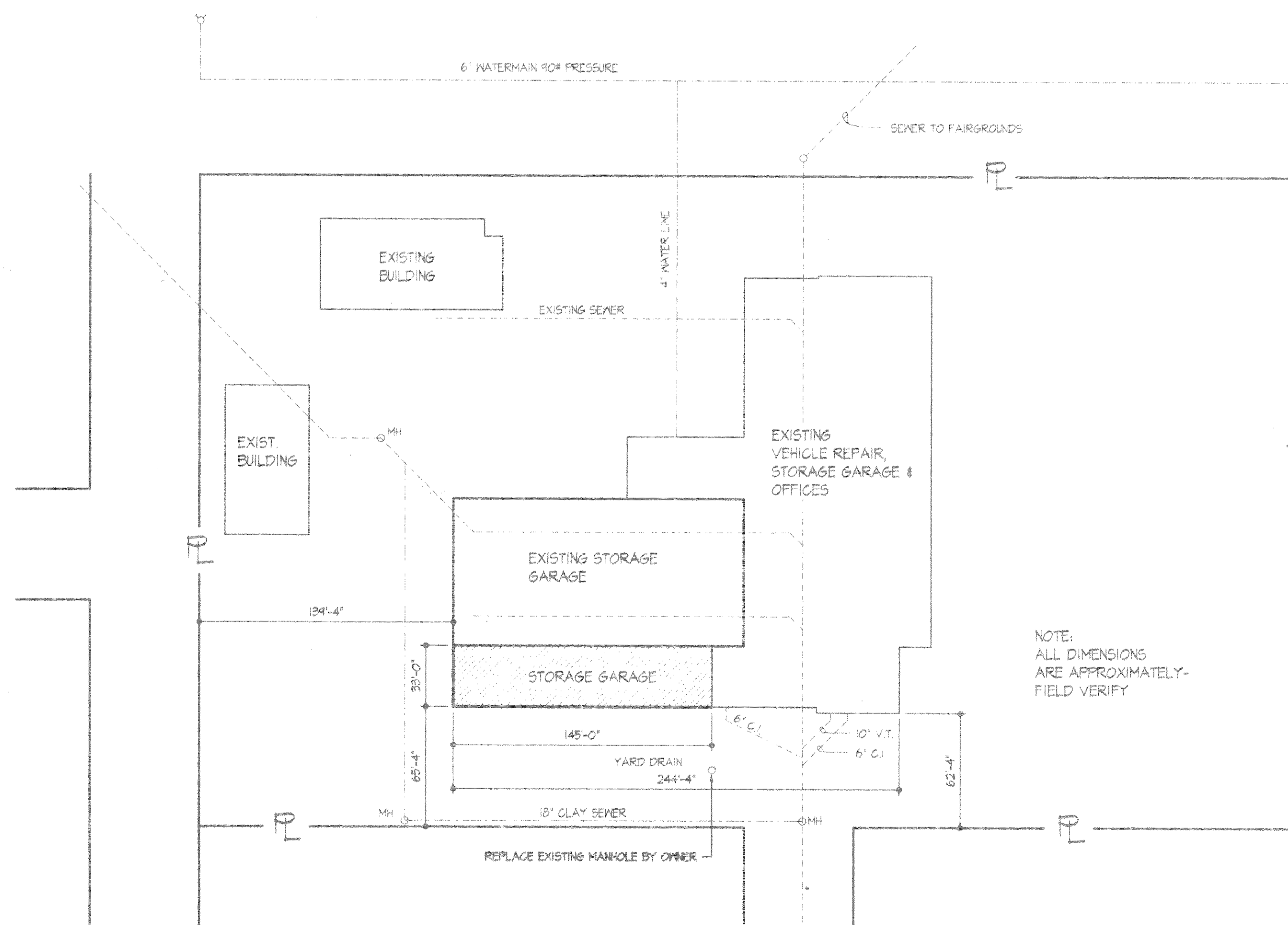
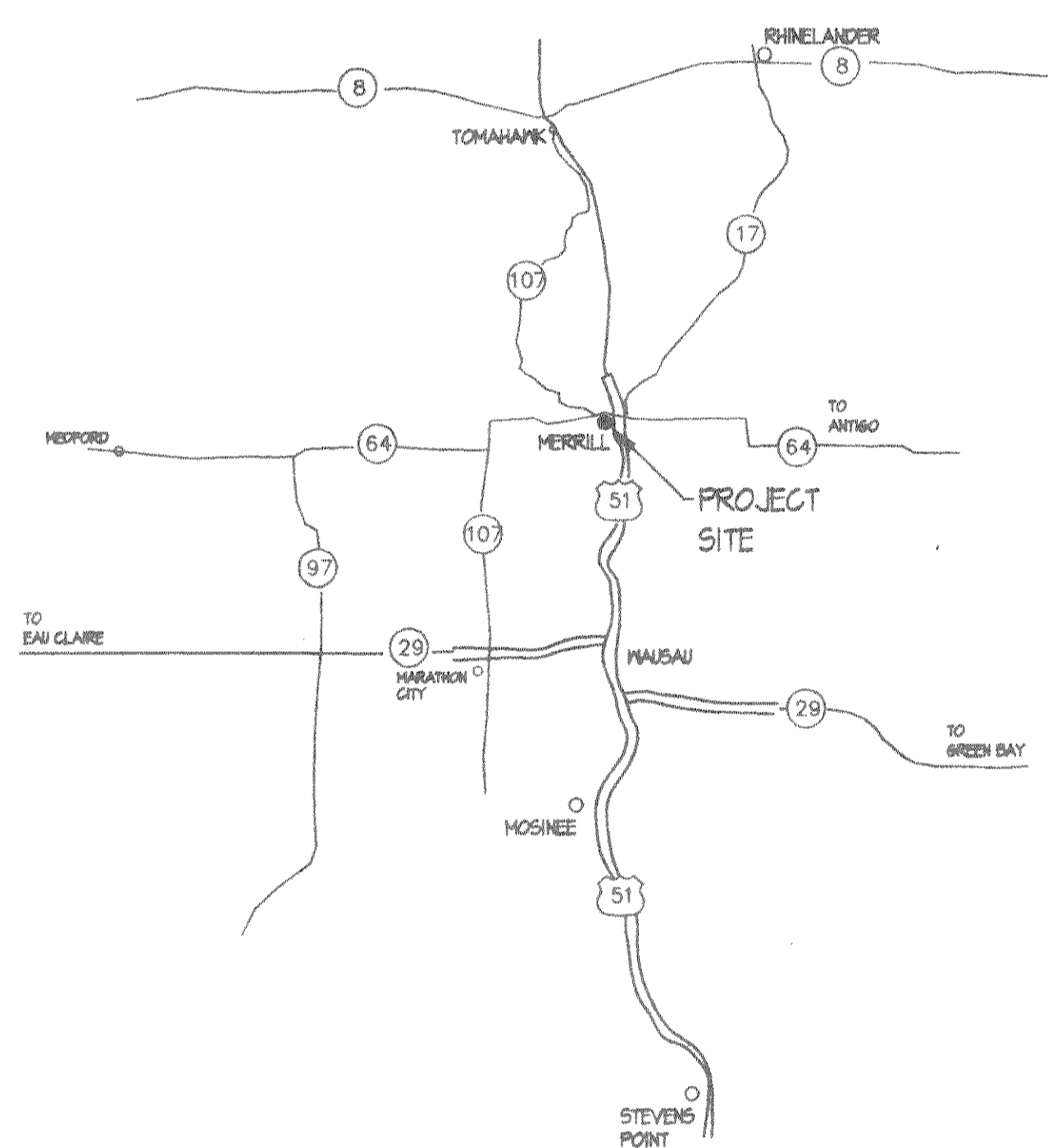

**SITE PLAN**  
SCALE: 1" = 50'-0"

DRAWING INDEX		
NO.	SHEET NO.	DESCRIPTION
1	G001	TITLE, INDEX & SITE PLAN
2	A100	OVERALL PLAN & FLOOR PLAN
3	A120	ENLARGED DETAILS & DOOR SCHEDULE
4	A200	ELEVATIONS
5	A220	SECTIONS & ENLARGED DETAILS
6	A240	ENLARGED DETAILS
7	S100	STRUCTURAL FOUNDATION PLAN
8	S101	STRUCTURAL FRAMING PLAN
9	H100	HVAC PLANS, DEMOLITION & SECTIONS
10	H101	HVAC SCHEDULES
11	E101	ELECTRICAL PLANS
12	E102	ELECTRICAL DETAILS AND SCHEDULES

ABBREVIATIONS			
AB	ANCHOR BOLT	GB	GENERAL CONTRACTOR GYPSUM BOARD
ADD	ADDITION	HSTAT	HEIGHT
ABF	ABOVE FINISH FLOOR	INS / INSUL	INSULATION
AL / ALUM	ALUMINUM	INT	INTERIOR
BIT	BITUMINOUS	MAX	MAXIMUM
BLDG	BUILDING	MET / MTL	METAL
BLK	BLOCK	MFR	MANUFACTURER
BRG	BRIDGE	MIN	MINIMUM
CL	CENTER LINE	MO	MASONRY OPENING
CLS	CEILING	NC	NOT IN CONTRACT
CMU	CONC. MASONRY UNIT (STANDARD FACE)	O.C.	ON CENTER
COL	COLUMN	O.D.	OUTSIDE DIAMETER
CONC	CONCRETE	OPNS	OPENING
CONT	CONTINUOUS	PC	PRECAST
DETDL	DETAIL	PL	PLATE
EA	EACH	REQD	REQUIRED
ELEC	ELECTRICAL	SECT	SECTION
EQ	EQUAL	SM	SIMILAR
EQUIP	EQUIPMENT	SPEC	SPECIFICATION
EXIST	EXISTING	TYP	TYPICAL
EXT	EXTERIOR	W/O	WITHOUT
		WD	WOOD
		WIF	WELDED WIRE FABRIC

INDEX OF MATERIALS					
[Symbol]	EARTH	[Symbol]	PLYWOOD	[Symbol]	BATT INSULATION
[Symbol]	CMU BLOCK	[Symbol]	PARTICLE BOARD	[Symbol]	RIGID INSULATION
[Symbol]	STEEL	[Symbol]	GYPSUM BOARD	[Symbol]	CONCRETE

**ARCHITECT - CONSULTANTS**

**BIA**

BECHER - HOPPE ASSOCIATES, INC.  
330 FOURTH STREET - P.O. BOX 8000  
HAUSAU WISCONSIN 54402 - 8000  
TELEPHONE (715) 845 - 8000  
FAX (715) 845 - 8008

PROJECT ARCHITECT - DAVID OEBERBECK, AIA

**BIA**

BAARS MECHANICAL DESIGN  
4202 KINLET CIRCLE  
HAUSAU WI 54401  
PH: 715-354-9151 FAX: 715-355-1263  
HVAC DESIGNER - DON BAARS

**BIA**

LANG ASSOCIATES, INC.  
908 S. 17TH AVENUE  
HAUSAU WI 54401  
PH: 715-845-8333 FAX: 715-840-4156  
ELECTRICAL ENGINEER - DEAN WHITLEY

© Copyright 2000, Becher-Hoppe Assoc. Inc.

**DRAWN BY:** M. HAMLIN

**CHK'D BY:**

**DATE:** 12 JULY 2000

**SCALE:**

**REVISIONS:**

NO.	DESCRIPTION	DATE

**NOTES:**

**BIA**

**BECHER-HOPPE ASSOCIATES, INC.**  
ENGINEERS ARCHITECTS SCIENTISTS  
130 Fourth Street - P.O. Box 8000 - Hausau, WI - 54402-8000  
Tel: 715-845-8000 • Fax: 715-845-8008 • www.bhassoc.com

**SUBCONSULTANTS:**

**PROJECT:**  
**LINCOLN COUNTY  
VEHICLE STORAGE  
GARAGE ADDITION**

**OWNER:**  
LINCOLN COUNTY HIGHWAY DEPARTMENT

**SHEET TITLE:**  
**TITLE, INDEX  
& SITE PLAN**

**PROJECT NUMBER:** 99029

**DWG. FILE NAME:** TITLESHEET

**G001**

**SHEET NUMBER** 1 **OF** 12

**SET NO 01**