

Sheet Number	Total Sheets
1	11

Index of Sheets

Sheet No. 1	Title
Sheet No. 2	Typical Cross Sections
Sheet No. 2	Estimate of Quantities
Sheet No. 2A	Miscellaneous Quantities
Sheet No. —	Right of Way Plat
Sheet No. 3-4	Plan and Profile STA. 22+60 TO STA. 36+47
Sheet No. 5-5.3	Standard Details
Sheet No. 6	Earthwork Estimates
Sheet No. 7-11	Cross Sections

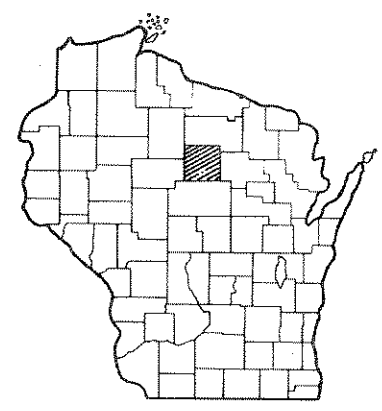

STATE OF WISCONSIN
DEPARTMENT OF TRANSPORTATION
DIVISION OF HIGHWAYS

PLAN AND PROFILE OF PROPOSED

PIER STREET, CITY OF MERRILL
 C.T.H. "K"
 LINCOLN COUNTY

PROJECT IDENTIFICATION NUMBER	FEDERAL PROJECT DESIGNATION
9420-3-70	SU 0568(5)

Scales
 Plan 1 in. = 100 ft.
 Profile Hor. 1 in. = 100 ft. Vert. 1 in. = 10 ft.
 Cross Sections Hor. 1 in. = 5' Vert. 1 in. = 5'

Design Designation

A. D. T.	1971 = 1325
A. D. T.	1991 = 2530
D. H. V.	= 380
D.	= 65%
T.	= 8%
V.	= 50 M. P. H.

END OF PROJECT SU 0568(5)/9420-3-70
 STA. 36+47 = BEGIN PROJ. SU 0568(3)
 N. - 495,505 (± 200') *
 E. - 2,079,100 (± 200') *
 00.0° S. & 0.5° W. OF NE COR.
 OF SEC. 11, T 31 N, R 6 E.

BEGIN PROJECT SU 0568(5)/9420-3-70
 STA. 22+60 = STA. 22+60 END OF
 PROJECT SU 0568(4)
 N. - 494,120 (± 200') *
 E. - 2,079,100 (± 200') *
 1,387' S. & 2.4' E. OF NE. COR.
 OF SEC. 11, T 31 N, R 6 E.

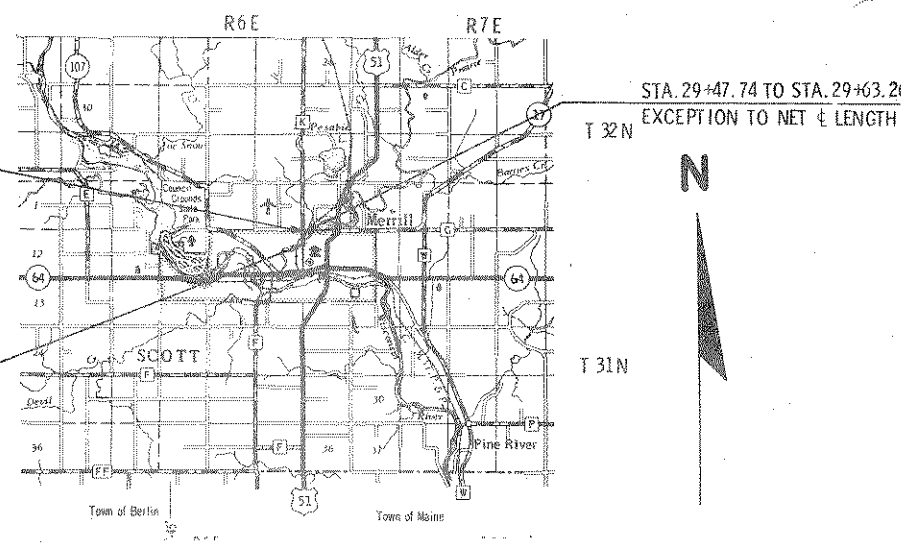

* SCALED FROM U.S.G.S. TOPOGRAPHIC MAP, MERRILL, WISCONSIN, QUADRANGLE FOR IDENTIFICATION ONLY.

Conventional Signs

State Line	Culverts in Place
County Line	Culverts Required
Township or Range Line	Drop Inlet
Section Line	Power Pole
New Right of Way Line	Telephone or Telegraph Pole
Present Right of Way Line	Right of Way Markers
Wire Fence { Woven	Reference Stake for Hubs Only
Barbed	Marsh
Lot Line	Hedge
Corporate or City Limits	Trees
Property Line	Ground Elevation	Datum Line 76.16
Traveled Way or P.E.	Grade Elevation	Datum Line 76.16
Railroads		
Base or Survey Line		

Layout
 Scale 0 1 2 MI.

Total Net Length of Centerline = 0.260 Mi.

APPROVED FOR CITY OF MERRILL BY CITY OF MERRILL	
DATE: _____	MAYOR
STATE OF WISCONSIN DEPARTMENT OF TRANSPORTATION DIVISION OF HIGHWAYS	
Surveyor: <u>D.J.</u>	District Checker: <u>G.W.</u>
Designer: <u>R.H.</u>	C.O. Checker: <u>J.L.H.</u>
Correct:	
Date: <u>2/23/71</u>	<u>R.D. Schindler</u> District Engineer
Date: <u>2/25/71</u>	<u>E.J. Byski</u> Chief Design Engineer
Date: <u>2/26/71</u>	<u>W.J. Burmeister</u> State Highway Engineer
U.S. DEPARTMENT OF TRANSPORTATION FEDERAL HIGHWAY ADMINISTRATION BUREAU OF PUBLIC ROADS REGION 4 WISCONSIN DIVISION	
Approved: _____	
Date: _____	
Division Engineer	

911 0568(5)