

35.6-569.0-3.16

Sheet Number	4
Total Sheets	

STATE OF WISCONSIN  
**DEPARTMENT OF TRANSPORTATION**  
**DIVISION OF HIGHWAYS**

PLAT OF RIGHT OF WAY REQUIRED FOR  
**PINE RIVER - C.T.H. "WW"**  
 C.T.H. "P"  
 LINCOLN COUNTY

PROJECT IDENTIFICATION NUMBER	FEDERAL PROJECT DESIGNATION
<b>9424 1 21</b>	<b>E 0569(16)</b>

Index of Sheets

- Sheet No. 4.0 TITLE
- Sheet No. 4.1 SCHEDULE OF LANDS & INTERESTS REQUIRED
- Sheet No. 4.2 - 4.5 PLAN & PARCEL SHEETS

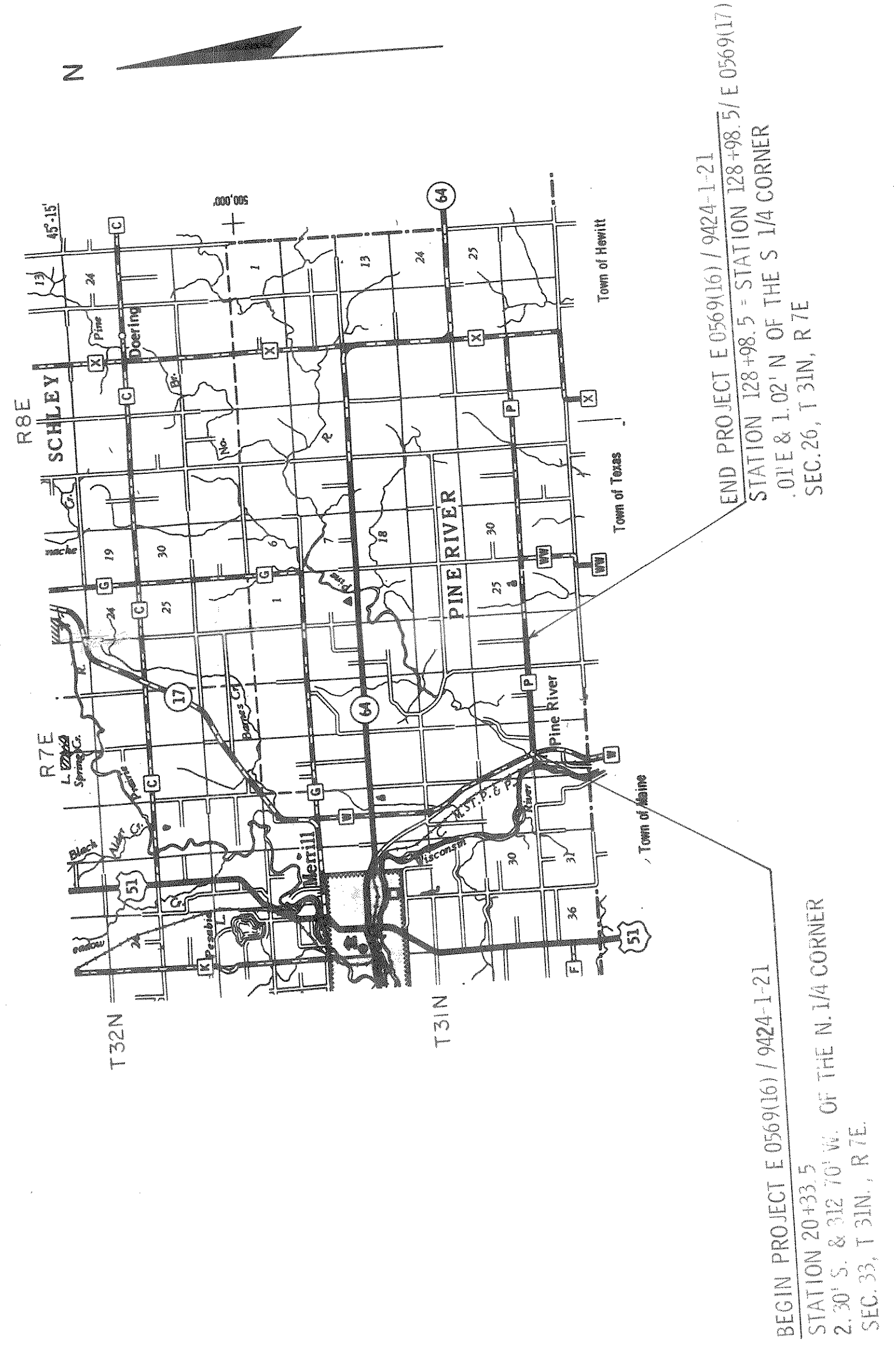
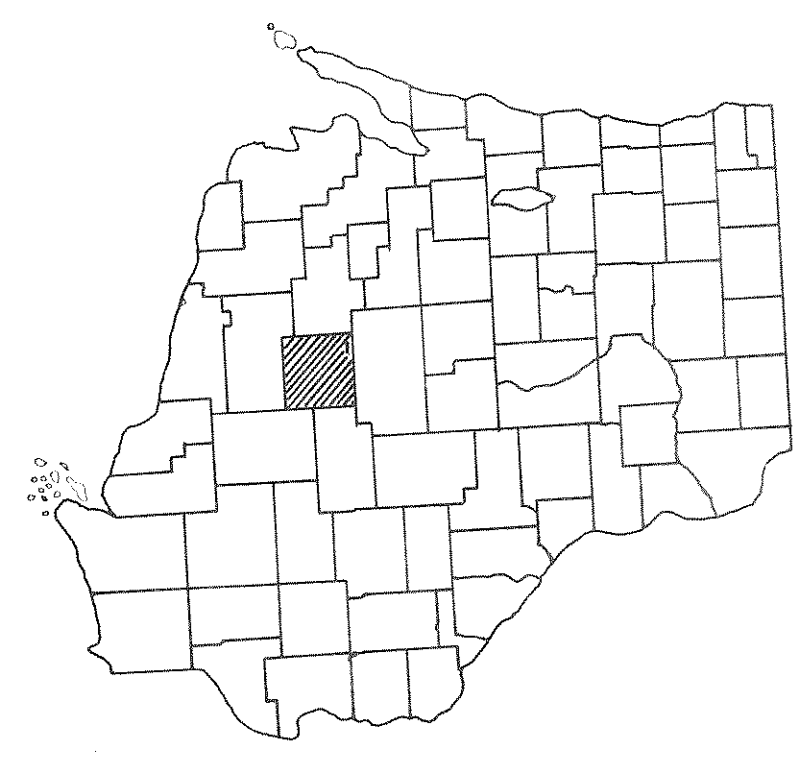

REVISION DATE	NC	STATE OF WISCONSIN DEPARTMENT OF TRANSPORTATION DIVISION OF HIGHWAYS
9/23/70	NC	
4/19/71	NC	
4/28/71	NC	
Recommended for Approval:		
Date	3/25/70	<i>K. Schmeidler</i> District Engineer
Date		Chief Design Engineer
Approved:		
Date		Director, Bureau of Right of Way
U.S. DEPARTMENT OF TRANSPORTATION FEDERAL HIGHWAY ADMINISTRATION BUREAU OF PUBLIC ROADS WISCONSIN DIVISION		
Approved:		
Date		Division Engineer