

PLAN	SURVEYED	DATE
	PLOTTED	BY
NOTE BOOK NO.	ALIGNMENT CHECKED	
	RT. OF WAY CHECKED	

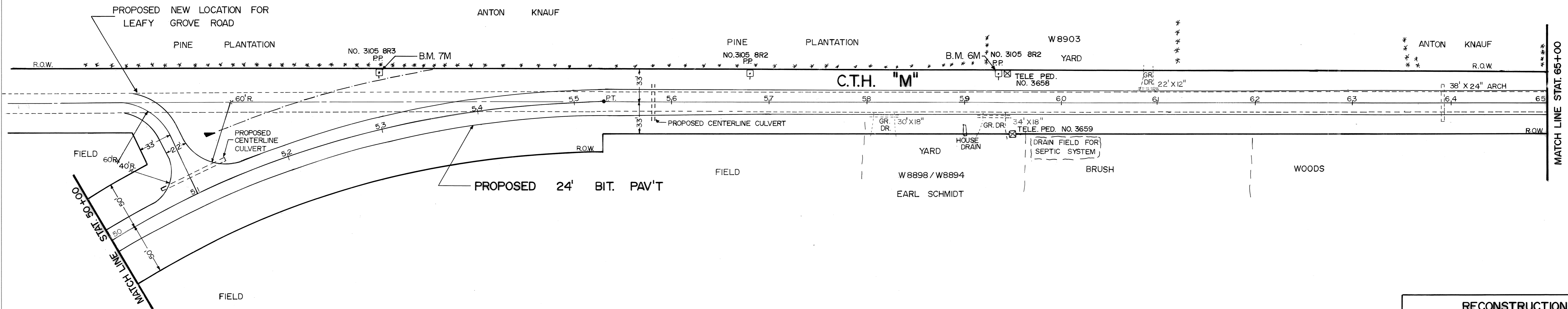

PROFILE	SURVEYED	DATE
	GRADES CHECKED	BY
NOTE BOOK NO.	ANNEALED	
	STRUCTURE NOTATIONS CHKD	

BENCHMARKS

NO.	DESCRIPTION	ELEV.
6M	NAIL IN P.P. NO. 3105 8R1 30' LEFT, STAT. 59+25	1383.26
7M	NAIL IN P.P. NO. 3105 8R3 40' LEFT, STAT. 53+15	1392.53

RECONSTRUCTION	
C.T.H. "M"	EAST 1.5 MILES FROM THE S. FORK OF THE COPPER RIVER BRIDGE
DRAWN BY:	JES.
SCALE:	HORIZONTAL 1" = 50' VERTICAL 1" = 2'
DATE:	DECEMBER 15TH, 1993

