

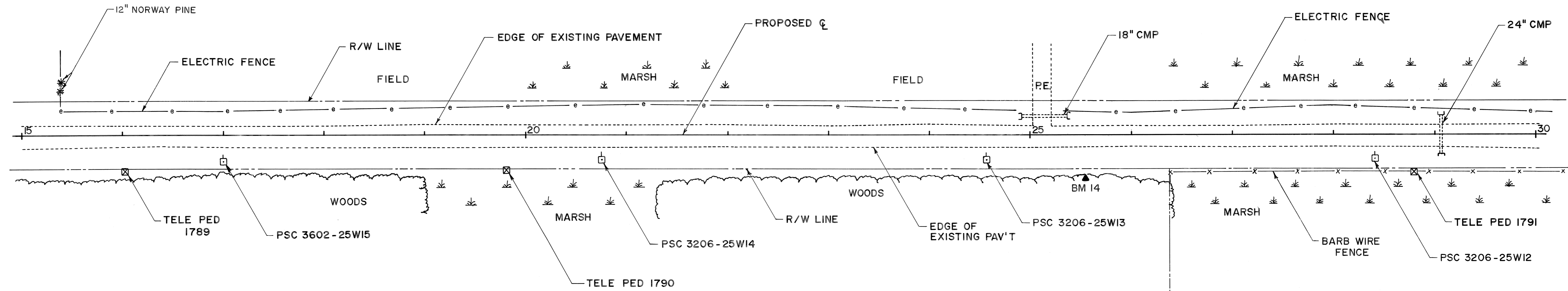

ARVEY CORP.



BENCHMARKS

14	3" SPIKE W/ORANGE TAB 18" OFF THE GROUND ON WEST FACE OF A 10" WHITE BIRCH 42' EAST OF CL AT STA. 25+54. ELEVATION = 1332.87.
----	---

LEO & EDITH BORELLI

ANGELO & CLARA RICCI

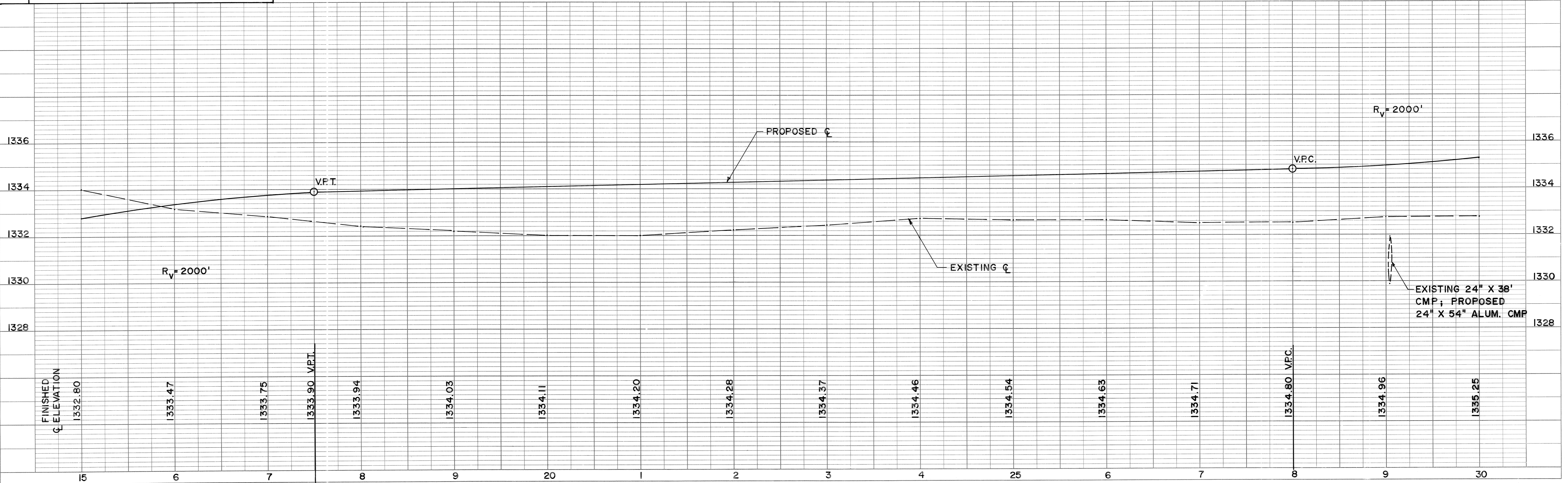

PLAN

DATE	
BY	
SURVEYED	
PLOTTED	
GRADES CHECKED	
STRUCTURE NOTATIONS CHKD	
NOTE BOOK NO.	

PROFILE

DATE	
BY	
SURVEYED	
PLOTTED	
GRADES CHECKED	
STRUCTURE NOTATIONS CHKD	
NOTE BOOK NO.	