

B.P.R. DIVISION	PROJECT	SHEET NUMBER	TOTAL SHEETS
4	S 0570(3)	7	42



STA. 338+50 PE. LT.
1-18" X 38' PIPE CULV. REQD.

STA. 340+52 TN. RD. LT.
1-18" X 42' PIPE CULV. REQD.

STA. 353+90 FE. LT.
1-18" X 28' PIPE CULV. REQD.

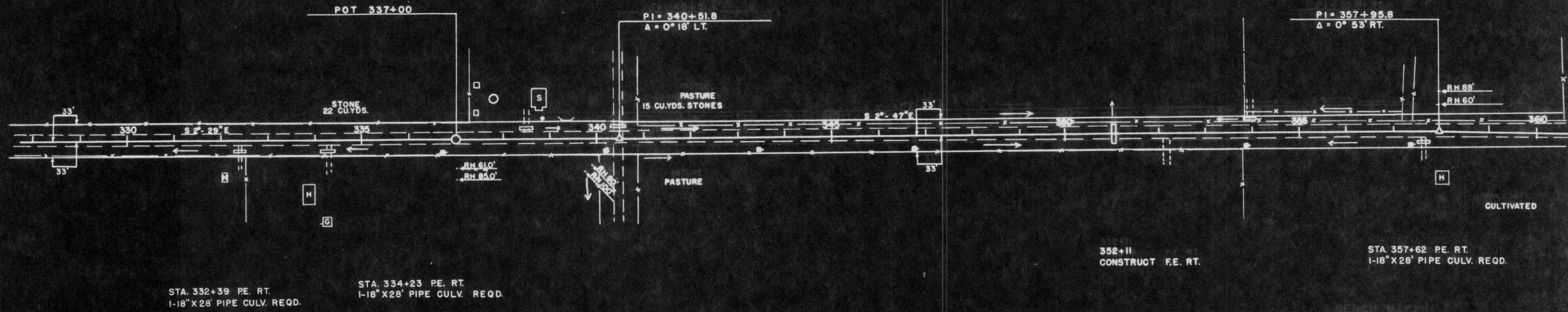

STA. 332+39 PE. RT.
1-18" X 28' PIPE CULV. REQD.

STA. 334+23 PE. RT.
1-18" X 28' PIPE CULV. REQD.

352+11
CONSTRUCT F.E. RT.

STA 357+62 PE. RT.
1-18" X 28' PIPE CULV. REQD.

BENCH MARKS			
NO.	STATION	DESCRIPTION	FLEV.
33	337+00	SPIKE IN 5" POPLAR	110' LT. 152.66
34	351+70	SPIKE IN 10" POPLAR	120' LT. 110.51
35	360+45	SPIKE IN 6" SPRUCE	120' LT. 131.86

NET LENGTH OF CENTERLINE STA. 330+00 - STA. 360+00 - 3000 LIN. FT.

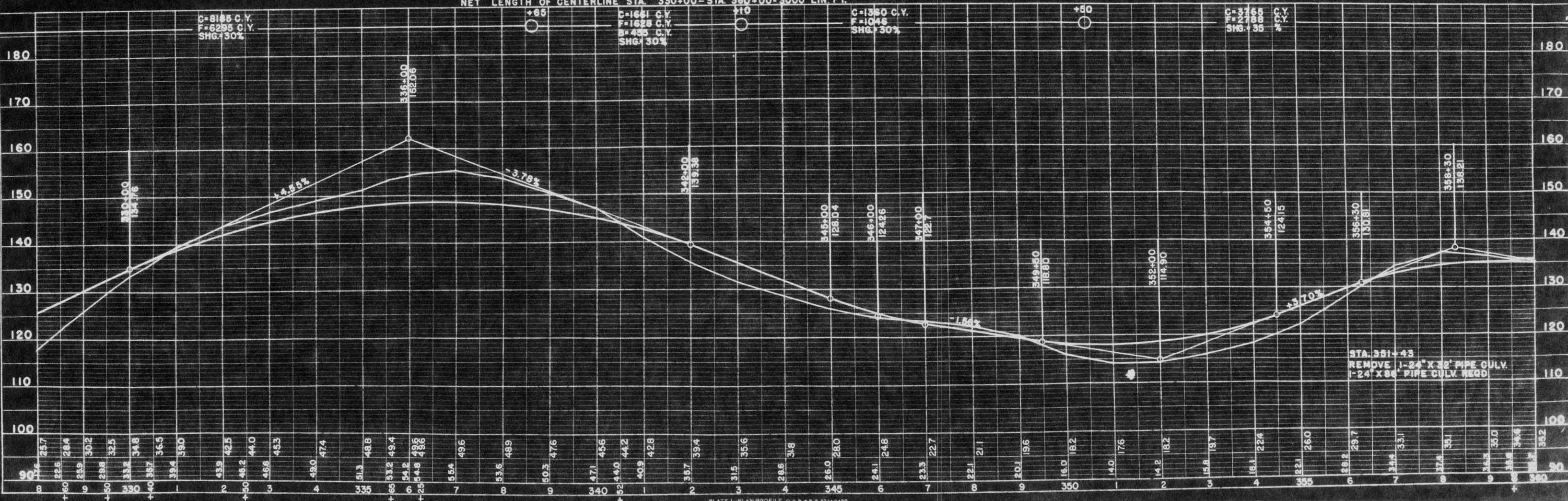

STA. 351+43
REMOVE 1-24" X 38' PIPE CULV.
1-24" X 38' PIPE CULV. REQD.

DATE: 1-55
BY: C.W. R.M.
SUBMITTED: []
NOTE BOOK: []
NO. 8483

DATE: 1-55
BY: C.W. R.M.
SUBMITTED: []
NOTE BOOK: []
NO. 8483