

INDEX OF SHEETS

- SHEET NO. 1 TITLE
- SHEET NO. 2 TYPICAL CROSS SECTIONS
- SHEET NO. 2-21 ESTIMATE OF QUANTITIES
- SHEET NO. 2A MISCELLANEOUS QUANTITIES
- SHEET NO. — RIGHT OF WAY PLAT
- SHEET NO. 3-8 PLAN AND PROFILE STA. 112+70 TO STA. 271+58
- SHEET NO. 9-13A STANDARD DETAILS
- SHEET NO. 14-15 DRAINAGE STRUCTURES
- SHEET NO. 16-36 CROSS SECTIONS



STATE OF WISCONSIN  
STATE HIGHWAY COMMISSION OF WISCONSIN

COUNTY AND HIGHWAY	ROUTE AND SECTION	CLASS AND AGREEMENT		FEDERAL DIVISION OFFICE	SHEET NUMBER	TOTAL SHEETS
		STATE	FEDERAL			
35.6	1184.0		11.1	WIS. 4	1	36

PLAN AND PROFILE OF PROPOSED  
BLOOMVILLE-EAST CO. LINE

CTH "J"  
LINCOLN COUNTY  
PROJECT S1184(1)

BEGINNING AT THE SOUTHWEST CORNER OF SECTION 34 T.33N, R.8E, AND EXTENDING EASTERLY TO THE SOUTHEAST CORNER OF SECTION 36 T.33N, R.8E.

SCALES { PLAN 1 IN. = 100 FT.  
PROFILE HOR. 1 IN. = 100 FT. VERT. 1 IN. = 10 FT.  
CROSS SECTIONS HOR. 1 IN. = 5 FT. VERT. 1 IN. = 5 FT.

APPROVED FOR LINCOLN COUNTY

*Francis X. Cox*

3-20-58 Date      COUNTY HIGHWAY COMM. Title

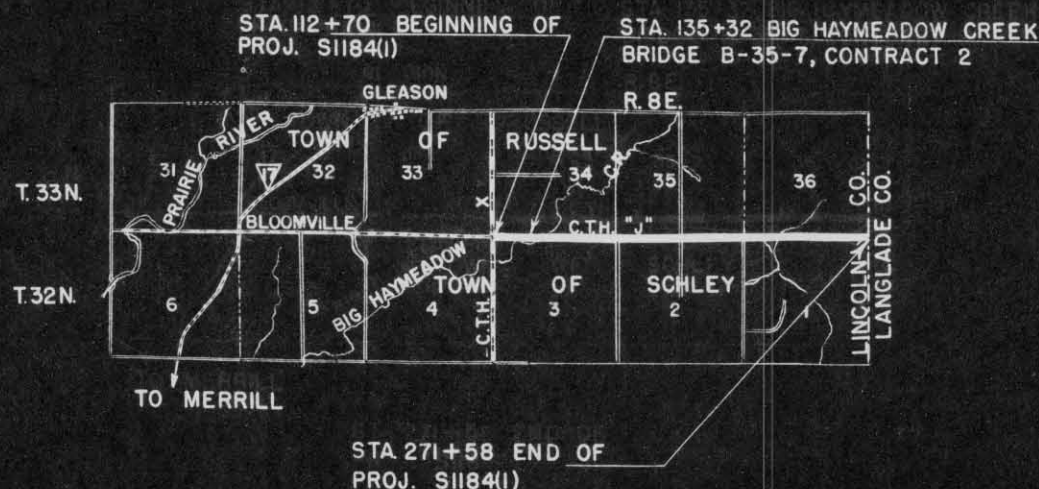

CONVENTIONAL SIGNS

- |                           |       |                               |       |
|---------------------------|-------|-------------------------------|-------|
| STATE LINE                | ----- | CULVERTS IN PLACE             | ----- |
| COUNTY LINE               | ----- | CULVERTS REQUIRED             | ----- |
| TOWNSHIP OR RANGE LINE    | ----- | DROP INLET                    | ----- |
| SECTION LINE              | ----- | POWER POLE                    | ----- |
| NEW RIGHT OF WAY LINE     | ----- | TELEPHONE OR TELEGRAPH POLE   | ----- |
| PRESENT RIGHT OF WAY LINE | ----- | RIGHT OF WAY MARKERS          | ----- |
| WIRE FENCE { WOVEN        | ----- | REFERENCE STAKE FOR HUBS ONLY | ----- |
| { BARBED                  | ----- | MARSH                         | ----- |
| LOT LINE                  | ----- | HEDGE                         | ----- |
| CORPORATE OR CITY LIMITS  | ----- | TREES                         | ----- |
| PROPERTY LINE             | ----- |                               |       |
| TRAVELED WAY OR P.E.      | ----- |                               |       |
| RAILROADS                 | ----- |                               |       |
| BASE OR SURVEY LINE       | ----- |                               |       |

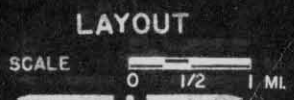

TOTAL NET LENGTH OF CENTERLINE = 3.009 MI.

STATE HIGHWAY COMMISSION OF WISCONSIN  
MADISON, WIS.

SURVEYOR SPRAGUE      NOTE BOOK 8276 - 8353  
DIVISION COMPUTER E. FS      H.S. CHECKER  
DISTRICT CHECKER GROP      CORRECT

CORRECT:

DATE 3-21-58      *Mrs. J. Little* DISTRICT ENGINEER

RECOMMENDED FOR APPROVAL:

DATE 3-4-58      *J. L. Pelt* ENGINEER OF DESIGN

APPROVED:

DATE 3/6/58      *E. G. Ruttman* STATE HIGHWAY ENGINEER

DEPARTMENT OF COMMERCE  
BUREAU OF PUBLIC ROADS

APPROVED: \_\_\_\_\_ DATE \_\_\_\_\_

DISTRICT ENGINEER

S1184(1)