

NOTE: PROPERTY LINES APPROXIMATE ONLY

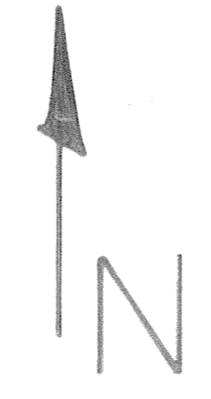

PLAN  
 SURVEYED BY: \_\_\_\_\_ DATE: \_\_\_\_\_  
 NOTE BOOK NO. \_\_\_\_\_  
 CHANGES CHECKED: \_\_\_\_\_  
 ALIGNMENT CHECKED: \_\_\_\_\_  
 RT. OF WAY CHECKED: \_\_\_\_\_

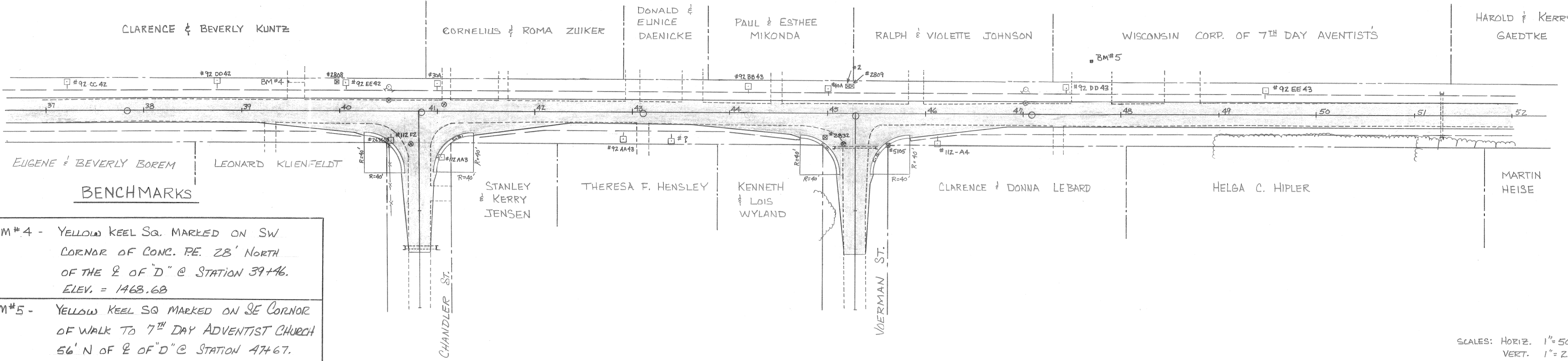

**BENCHMARKS**

BM #4 - YELLOW KEEL SQ. MARKED ON SW CORNER OF CONC. P.E. 28' NORTH OF THE E OF "D" @ STATION 39+46. ELEV. = 1468.68

BM #5 - YELLOW KEEL SQ. MARKED ON SE CORNER OF WALK TO 7<sup>TH</sup> DAY ADVENTIST CHURCH 56' N OF E OF "D" @ STATION 47+67. ELEV. = 1466.09

SCALES: HORIZ. 1" = 50'  
 VERT. 1" = 2'

PROFILE  
 SURVEYED BY: \_\_\_\_\_ DATE: \_\_\_\_\_  
 NOTE BOOK NO. \_\_\_\_\_  
 CHANGES CHECKED: \_\_\_\_\_  
 B.M.S. NOTED: \_\_\_\_\_  
 PROPOSED NOTATIONS (P.F.C.): \_\_\_\_\_

