

STA. 197+16
 RESTORE P.E. LT.
 1-18" x 18" C.P. REMOVE
 1-18" C.P. READ

GEORGE G. HAPER

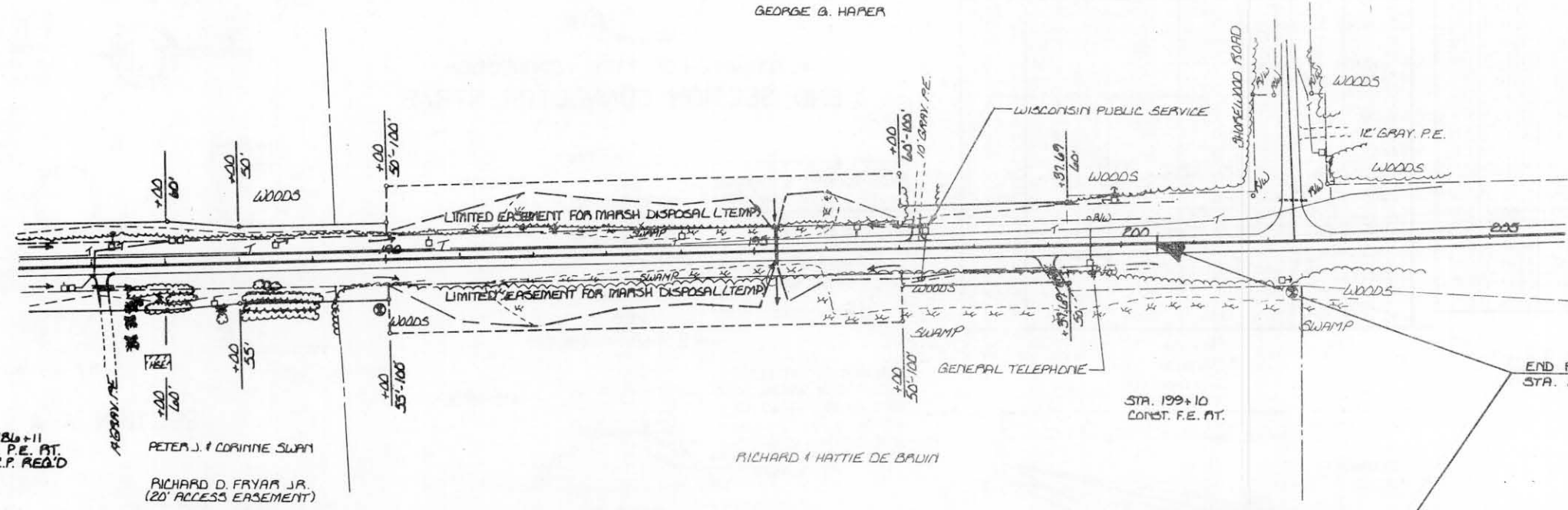

END PROJECT No. 9410-01-00
 STA. 200+50 - SAWCUT READ

STA. 186+11
 CONST. P.E. AT
 1-18" C.P. READ

PETER J. & CORINNE SWAN

RICHARD D. FRYAR JR.
 (20' ACCESS EASEMENT)

STA. 199+10
 CONST. F.E. AT

BENCHMARKS			
No.	STA.	DESCRIPTION	ELEV.
5	183+90	SET 3/8" SPK. 12" MAPLE RT. 68' AT.	1472.14
6	202+33	SET 3/8" SPK. 24" PINE AT. 67' AT.	1466.92

NET CENTERLINE LENGTH STA. 185+00 TO 200+50 = 1,550 L.F.

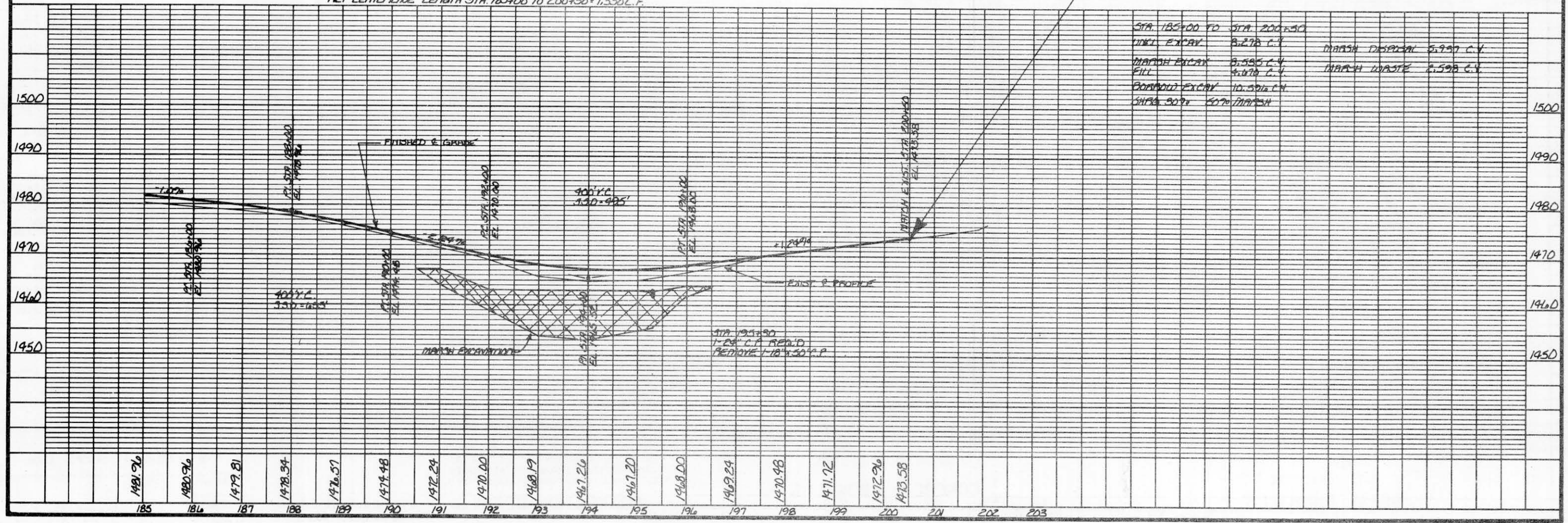

STA.	DESCRIPTION	QUANTITY
185+00 TO 200+50	NET EXCAV.	8,278 C.Y.
	MARSH DISPOSAL	5,997 C.Y.
	MARSH EXCAV.	8,595 C.Y.
	MARSH WASTE	2,598 C.Y.
	FILL	4,870 C.Y.
	BORING EXCAV.	10,596 C.Y.
	SHAFTS	5070 MARSH