

INDEX OF SHEETS

- SHEET NO. 1 TITLE
- SHEET NO. 2 TYPICAL CROSS SECTIONS
- SHEET NO. 2 ESTIMATE OF QUANTITIES
- SHEET NO. - MISCELLANEOUS QUANTITIES
- SHEET NO. - RIGHT OF WAY PLAT
- SHEET NO. 3-B PLAN AND PROFILE STA. 0+10.5 TO STA. 79+77
- SHEET NO. 9 STANDARD DETAILS
- SHEET NO. 10-11 DRAINAGE STRUCTURES
- SHEET NO. - CROSS SECTIONS

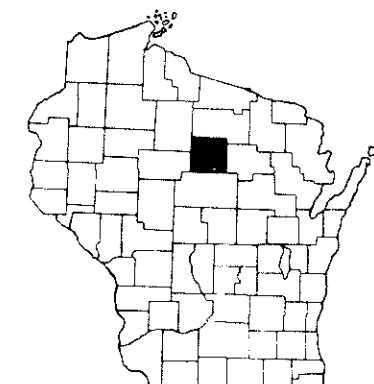

STATE OF WISCONSIN
STATE HIGHWAY COMMISSION OF WISCONSIN

COUNTY AND HIGHWAY	ROUTE AND SECTION	CLASS AND AGREEMENT		FEDERAL DIVISION OFFICE	SHEET NUMBER	TOTAL SHEETS
		STATE	FEDERAL			
35.2	13.0	22.1		WIS. 5N	1	11

PLAN AND PROFILE OF PROPOSED
WEST MAIN, POLK, SECOND, FIRST, MILL AND EAST MAIN STREETS
CITY OF MERRILL
S.T.H. 64
LINCOLN COUNTY
PROJECT T 013(1)

STARTING AT THE INTERSECTION OF EAST MAIN STREET AND CENTER AVENUE, THENCE WESTERLY TO THE EAST CHANNEL OF THE WISCONSIN RIVER

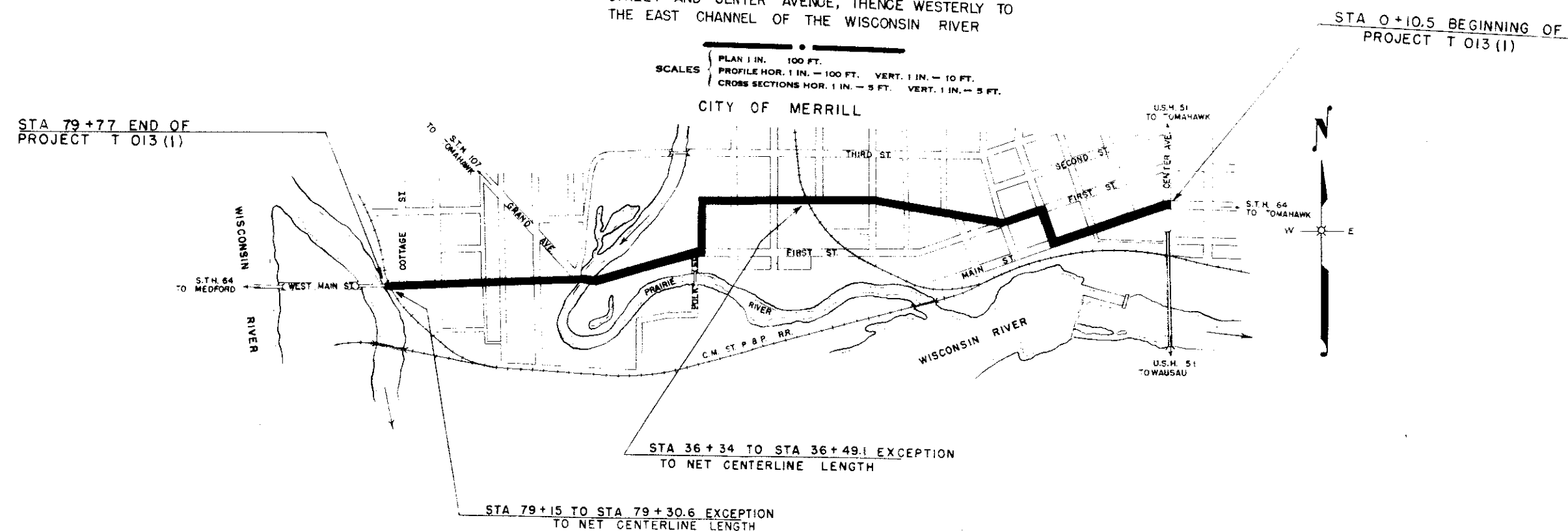

CONVENTIONAL SIGNS

STATE LINE	-----	CULVERTS IN PLACE	-----
COUNTY LINE	-----	CULVERTS REQUIRED	-----
TOWNSHIP OR RANGE LINE	-----	DROP INLET	-----
SECTION LINE	-----	POWER POLE	-----
NEW RIGHT OF WAY LINE	-----	TELEPHONE OR TELEGRAPH POLE	-----
PRESENT RIGHT OF WAY LINE	-----	RIGHT OF WAY MARKERS	-----
WIRE FENCE { WOVEN	-----	REFERENCE STAKE FOR HUBS ONLY	-----
BARBED	-----	MAPSH	-----
LOT LINE	-----	HEDGE	-----
CORPORATE OR CITY LIMITS	-----	TREES	-----
PROPERTY LINE	-----		
TRAVELED WAY OR P.E.	-----		
RAILROADS	-----		
BASE OR SURVEY LINE	-----		

LAYOUT
SCALE 1" = 1000 FT.
TOTAL NET LENGTH OF CENTERLINE = 1.503 MI.

STATE HIGHWAY COMMISSION OF WISCONSIN MADISON, WIS.		DEPARTMENT OF COMMERCE BUREAU OF PUBLIC ROADS	
SURVEYOR MANGOLD NOTE BOOK		RECOMMENDED FOR APPROVAL:	
DIVISION COMPUTER M.P. M.O. CHECKER		DISTRICT ENGINEER DATE	
DIVISION CHECKER D.O. COM. CHECKER		APPROVED:	
CORRECT	DATE 3/24/52	DATE	
RECOMMENDED FOR APPROVAL:	DATE 3/24/52	DATE	
APPROVED:	DATE 3/24/52	DATE	
STATE HIGHWAY ENGINEER		DIVISION ENGINEER	