

INDEX OF SHEETS

SHEET NO. 1 TITLE SHEET

2 TYPICAL CROSS SECTIONS OF IMPROVEMENTS & ESTIMATES

3 PLAN & PROFILE STA 52+00 TO STA 3067+00

4 SPECIAL SKETCH OF IMPROVEMENT ON LAKE STREET

5 DETAILED SKETCH OF CROSS SECTION

6 TYPICAL DRAWING STANDARDS

7 PROPOSED SECTION

8 GRADE SHEET

STATE OF WISCONSIN
WISCONSIN HIGHWAY COMMISSION

PLAN AND PROFILE OF PROPOSED
LAKE STREET IMPROVEMENT

LINCOLN COUNTY
 COUNTY AID PROJECT

COMMENCING AT A POINT 52' NORTH OF THE INTERSECTION OF THE CENTER LINES OF SIXTH AND LAKE STREETS IN THE CITY OF MERRILL WISCONSIN AND EXTENDING NORTH 30167' TO THE PRAIRIE RIVER BRIDGE.

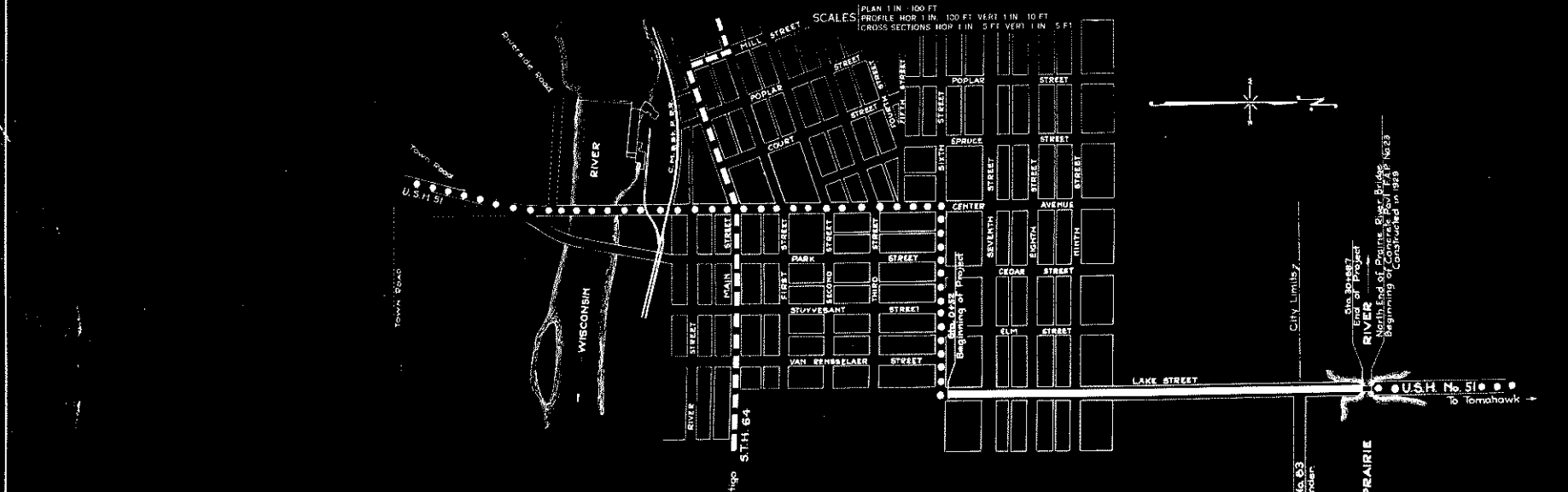

CONVENTIONAL SIGNS

STATE AND NATIONAL	---	CULVERTS	—
COUNTY LINE	---	DROP INLET	—
CITY, VILLAGE, OR TOWN	---	TROLLEY POLE	—
TOWNSHIP LINE	---	POWER POLE	—
SECTION LINE	---	TELEPHONE OR TELEGRAPH POLES	—
FENCE LINE	---	RAIL BOX	—
GUARD RAIL	---	REFERENCE STAKES	—
UNFENCED PROPERTY	---	MARSH	—
RIGHT OF WAY LINE	---	HEDGE	—
TRAVELED WAY	---	TREES	—
RAILROADS	---	GROUND ELEVATION	—
RETAINING WALL	---	GRADE ELEVATION	—
LEVEE	---		
BASE OR SURVEY LINE	---		

LAYOUT

1/4 MILE

TOTAL NET LENGTH OF CENTERLINE = 0.571 MI.

CITY OF
MERRILL, WISCONSIN
 APPROVED DATE *Jan 22/22*
Chas. D. Taylor
 CITY ENGINEER

LINCOLN COUNTY
 APPROVED DATE *Feb 22/22*
R. H. Buckley
 COUNTY HIGHWAY COMMISSIONER

WISCONSIN HIGHWAY COMMISSION
 MADISON, WIS.
 Surveyor: L. Wolfgram, No. 2986, 2996
 Div. Computer: M. D. Ocker
 Div. Checker: L. M. Paterson, Correct

CORRECT: *F. H. Sargent*
Franklin
 ENGINEER, PLANS AND SUPERVISOR
 APPROVED: *W. S. B...*
 STATE ENGINEER