

P.T. 439+64.61 SB.
N 50° 34' 29" E
E 2,085,471.53
Δ 33° 46' 39"
D. 1° 27' 48"
T. 1188.84
L. 2308.42'
S.E. 0.053'/
R.O. 260'

P.I. 439+35.46 NB.
N 50° 39' 17.5"
E 2,085,559.19
Δ 33° 46' 39"
D. 1° 30'
T. 1159.70'
L. 2251.83'
S.E. 0.053'/
R.O. 260'.

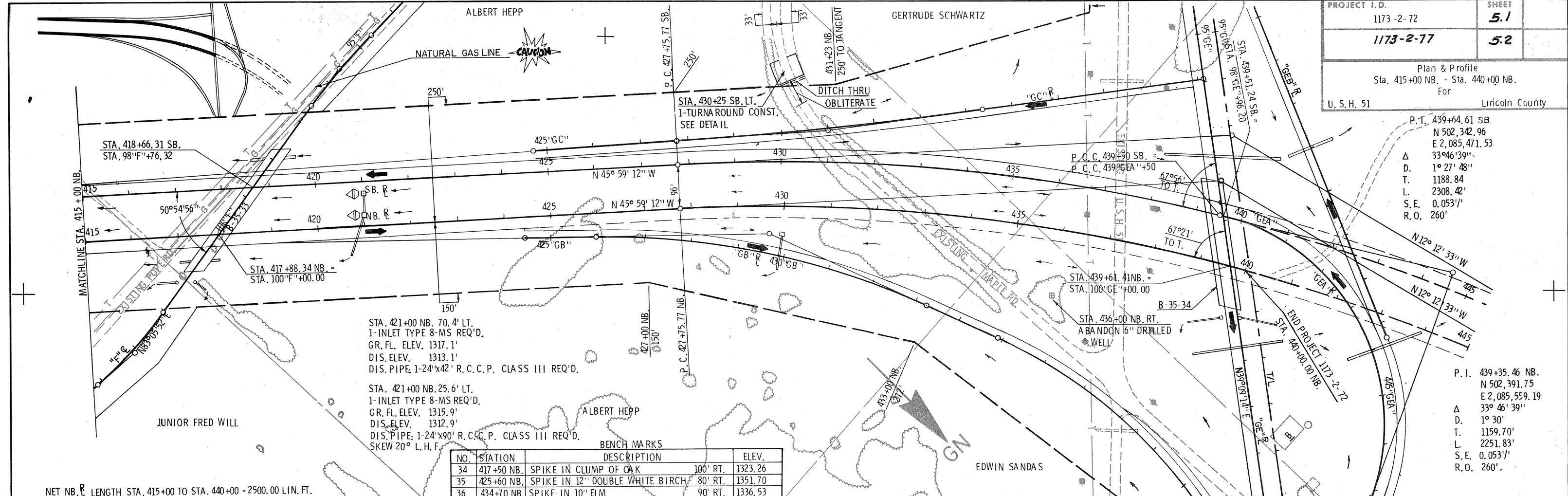

STA. 421+00 NB. 70.4' LT.
1-INLET TYPE 8-MS REQ'D.
GR. FL. ELEV. 1317.1'
DIS. ELEV. 1313.1'
DIS. PIPE: 1-24"x42" R.C.C.P. CLASS III REQ'D.

STA. 421+00 NB. 25.6' LT.
1-INLET TYPE 8-MS REQ'D.
GR. FL. ELEV. 1315.9'
DIS. ELEV. 1312.9'
DIS. PIPE: 1-24"x42" R.C.C.P. CLASS III REQ'D.
SKEW 20° L.H.F.

NO.	STATION	DESCRIPTION	ELEV.
34	417+50 NB.	SPIKE IN CLUMP OF OAK	100' RT. 1323.26
35	425+60 NB.	SPIKE IN 12" DOUBLE WHITE BIRCH	80' RT. 1351.70
36	434+70 NB.	SPIKE IN 10" ELM	90' RT. 1336.53

NET NB. R LENGTH STA. 415+00 TO STA. 440+00 = 2500.00 LIN. FT.

