

 INDICATES WETLAND IMPACT AREA
SALVAGE TOPSOIL, PLACE GEOTEXTILE
FABRIC TYPE MS IN THESE AREAS

 INDICATES WETLAND MITIGATION AREA
PLACE WETLAND SEED MIX NO. 60
IN THIS AREA

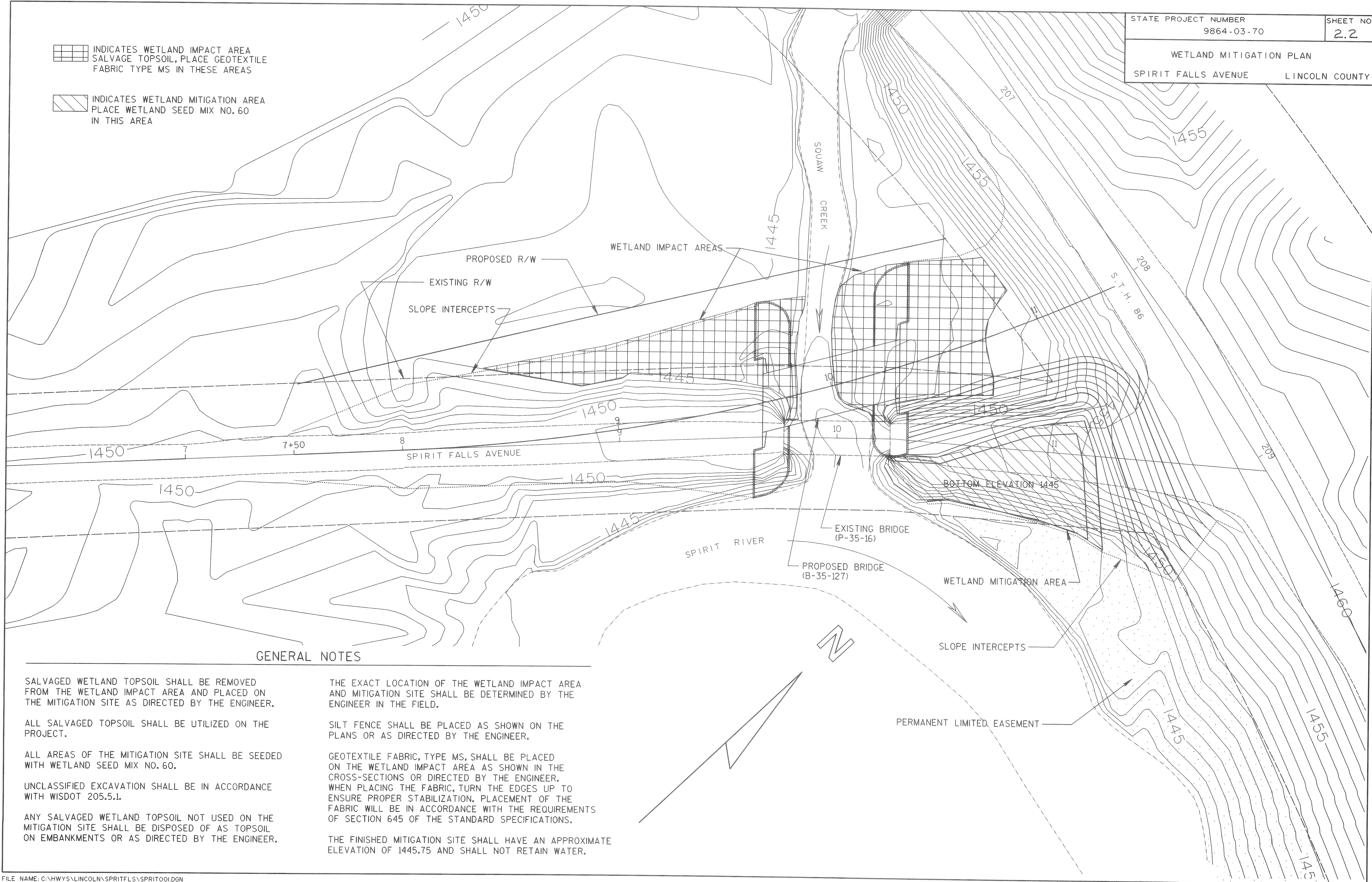

GENERAL NOTES

SALVAGED WETLAND TOPSOIL SHALL BE REMOVED FROM THE WETLAND IMPACT AREA AND PLACED ON THE MITIGATION SITE AS DIRECTED BY THE ENGINEER.

ALL SALVAGED TOPSOIL SHALL BE UTILIZED ON THE PROJECT.

ALL AREAS OF THE MITIGATION SITE SHALL BE SEEDED WITH WETLAND SEED MIX NO. 60.

UNCLASSIFIED EXCAVATION SHALL BE IN ACCORDANCE WITH WISDOT 205.5.1.

ANY SALVAGED WETLAND TOPSOIL NOT USED ON THE MITIGATION SITE SHALL BE DISPOSED OF AS TOPSOIL ON EMBANKMENTS OR AS DIRECTED BY THE ENGINEER.

THE EXACT LOCATION OF THE WETLAND IMPACT AREA AND MITIGATION SITE SHALL BE DETERMINED BY THE ENGINEER IN THE FIELD.

SILT FENCE SHALL BE PLACED AS SHOWN ON THE PLANS OR AS DIRECTED BY THE ENGINEER.

GEOTEXTILE FABRIC, TYPE MS, SHALL BE PLACED ON THE WETLAND IMPACT AREA AS SHOWN IN THE CROSS-SECTIONS OR DIRECTED BY THE ENGINEER. WHEN PLACING THE FABRIC, TURN THE EDGES UP TO ENSURE PROPER STABILIZATION. PLACEMENT OF THE FABRIC WILL BE IN ACCORDANCE WITH THE REQUIREMENTS OF SECTION 645 OF THE STANDARD SPECIFICATIONS.

THE FINISHED MITIGATION SITE SHALL HAVE AN APPROXIMATE ELEVATION OF 1445.75 AND SHALL NOT RETAIN WATER.