

INDEX OF SHEETS

| | |
|-------------|---|
| SHEET NO. 1 | TITLE |
| SHEET NO. | TYPICAL CROSS SECTIONS |
| SHEET NO. | ESTIMATE OF QUANTITIES |
| SHEET NO. | MISCELLANEOUS QUANTITIES |
| SHEET NO. | RIGHT OF WAY PLAT |
| SHEET NO. | PLAN AND PROFILE STA. 6+34.83 TO STA. 7+47.00 |
| SHEET NO. | STANDARD DETAILS |
| SHEET NO. | DRAINAGE STRUCTURES |
| SHEET NO. | CROSS SECTIONS |

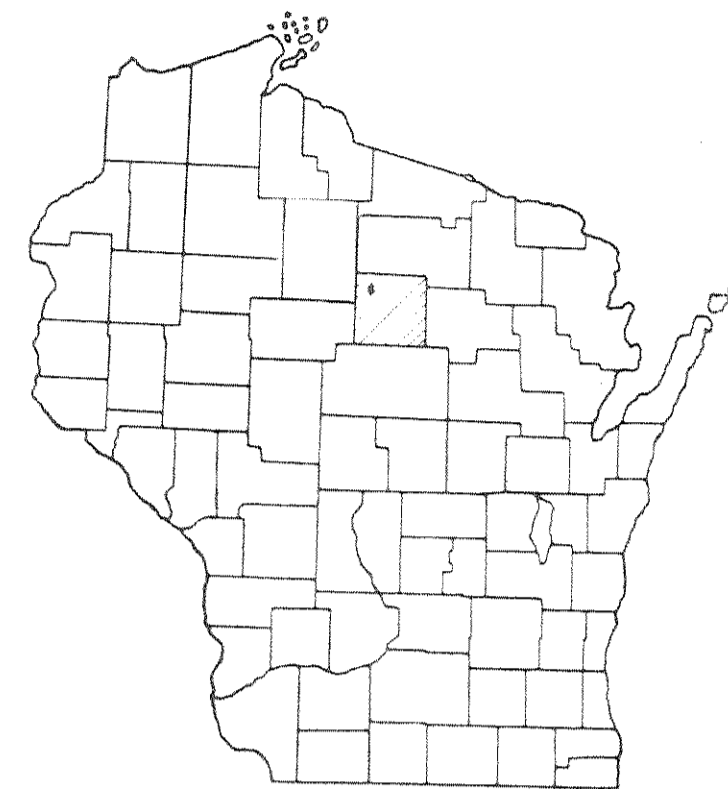

STATE OF WISCONSIN
STATE HIGHWAY COMMISSION OF WISCONSIN

PLAN AND PROFILE OF PROPOSED

C.T.H."E"- S.T.H."86"
SPIRIT RIVER BRIDGE
C.T.H."O"
LINCOLN COUNTY
PROJECT E0-0 (7)

| COUNTY AND HIGHWAY | ROUTE AND SECTION | CLASS AND AGREEMENT | | S.P.R. REGION DIVISION | SHEET NUMBER | TOTAL SHEETS |
|--------------------|-------------------|---------------------|---------|------------------------|--------------|--------------|
| | | LOCAL | FEDERAL | | | |
| 35.6 | 0.0 | 3.7 | | 4 WIS. | 1 | |

PLAN 1 IN. = 100 FT.
PROFILE HOR. 1 IN. = 100 FT. VERT. 1 IN. = 10 FT.
CROSS SECTIONS HOR. 1 IN. = 5 FT. VERT. 1 IN. = 5 FT.

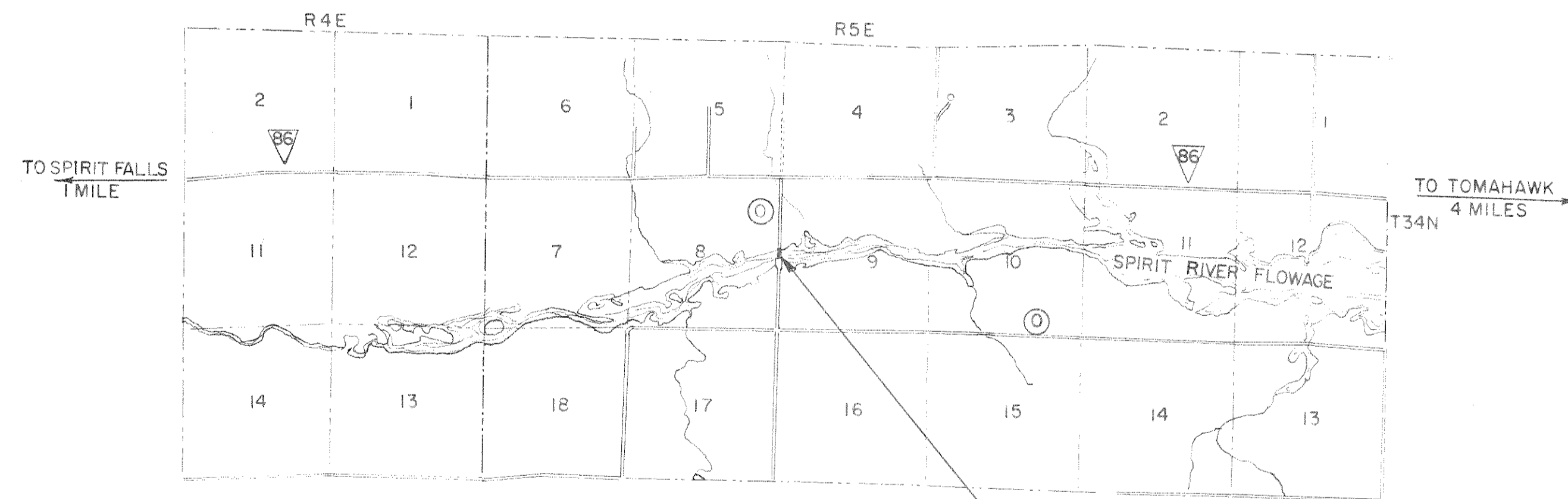

STA. 6+34.83 - STA. 7+47.00
PROJECT E 0-0 (7)
BRIDGE NO. B-35-3

LAYOUT

SCALE 1 MILE

TOTAL NET LENGTH OF CENTERLINE = 0.021 MI.

CONVENTIONAL SIGNS

| | | | |
|---------------------------|-------|-------------------------------|------------------|
| STATE LINE | ----- | CULVERTS IN PLACE | ----- |
| COUNTY LINE | ----- | CULVERTS REQUIRED | ----- |
| TOWNSHIP OR RANGE LINE | ----- | DROP INLET | ----- |
| SECTION LINE | ----- | POWER POLE | ----- |
| NEW RIGHT OF WAY LINE | ----- | TELEPHONE OR TELEGRAPH POLE | ----- |
| PRESENT RIGHT OF WAY LINE | ----- | RIGHT OF WAY MARKERS | ----- |
| WIRE FENCE { WOVEN | ----- | REFERENCE STAKE FOR HUBS ONLY | ----- |
| { BARBED | ----- | MARSH | ----- |
| LOT LINE | ----- | HEDGE | ----- |
| CORPORATE OR CITY LIMITS | ----- | TREES | ----- |
| PROPERTY LINE | ----- | GROUND ELEVATION | DATUM LINE 73.9 |
| TRAVELED WAY OR P.E. | ----- | GRADE ELEVATION | DATUM LINE 75.16 |
| RAILROADS | ----- | | |
| BASE OR SURVEY LINE | ----- | | |

STATE HIGHWAY COMMISSION OF WISCONSIN
MADISON, WIS.

SURVEYOR: L. SPARKS
DIVISION COMPUTER: MC NOWN
DISTRICT CHECKER: M. HESS

NOTE BOOK: 204
M. O. CHECKER:
CORRECT:

CORRECT: _____
DATE: _____ DISTRICT ENGINEER

RECOMMENDED FOR APPROVAL:
DATE: _____ ENGINEER OF DESIGN

APPROVED: _____
DATE: _____ STATE HIGHWAY ENGINEER

DEPARTMENT OF COMMERCE
BUREAU OF PUBLIC ROADS

APPROVED: _____
DATE: _____
DIVISION ENGINEER