

INDEX OF SHEETS

- SHEET NO. 1 TITLE
- SHEET NO. 2 TYPICAL CROSS SECTIONS
- SHEET NO. 2 ESTIMATE OF QUANTITIES
- SHEET NO. - MISCELLANEOUS QUANTITIES
- SHEET NO. - RIGHT OF WAY PLAT
- SHEET NO. 3 PLAN AND PROFILE STA. 20+19.75 TO STA. 21+28.25
- SHEET NO. 4 STANDARD DETAILS
- SHEET NO. 5-13 DRAINAGE STRUCTURES
- SHEET NO. - CROSS SECTIONS

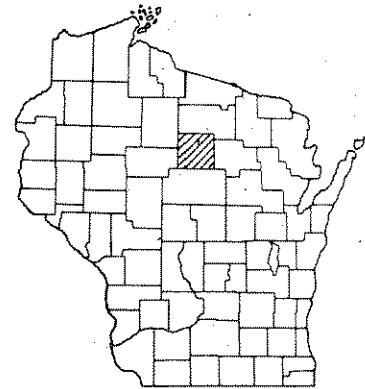

DESIGN DESIGNATION

- A. D. T. 1967 - 590
- A. D. T. 1968 - 1180
- D. H. V. - 200
- D. - 65%
- T. - 12%
- V. - 50 M. P. H.

CONVENTIONAL SIGNS

- | | | | |
|---------------------------|-------|-------------------------------|-------|
| STATE LINE | ----- | CULVERTS IN PLACE | ----- |
| COUNTY LINE | ----- | CULVERTS REQUIRED | ----- |
| TOWNSHIP OR RANGE LINE | ----- | DROP INLET | ----- |
| SECTION LINE | ----- | POWER POLE | ----- |
| NEW RIGHT OF WAY LINE | ----- | TELEPHONE OR TELEGRAPH POLE | ----- |
| PRESENT RIGHT OF WAY LINE | ----- | RIGHT OF WAY MARKERS | ----- |
| WIRE FENCE { WOVEN | ----- | REFERENCE STAKE FOR HUBS ONLY | ----- |
| { BARBED | ----- | MARSH | ----- |
| LOT LINE | ----- | HEDGE | ----- |
| CORPORATE OR CITY LIMITS | ----- | TREES | ----- |
| PROPERTY LINE | ----- | | |
| TRAVELED WAY OR P.E. | ----- | | |
| RAILROADS | ----- | | |
| BASE OR SURVEY LINE | ----- | | |

STATE OF WISCONSIN
STATE HIGHWAY COMMISSION OF WISCONSIN

PLAN AND PROFILE OF PROPOSED
SPIRIT RIVER BRIDGE
C.T.H. "E"
LINCOLN COUNTY
PROJECT S1182(2)

PLAN 1 IN. = 100 FT.
PROFILE HOR. 1 IN. = 100 FT. VERT. 1 IN. = 10 FT.
CROSS SECTIONS HOR. 1 IN. = 5 FT. VERT. 1 IN. = 5 FT.

B-35-18

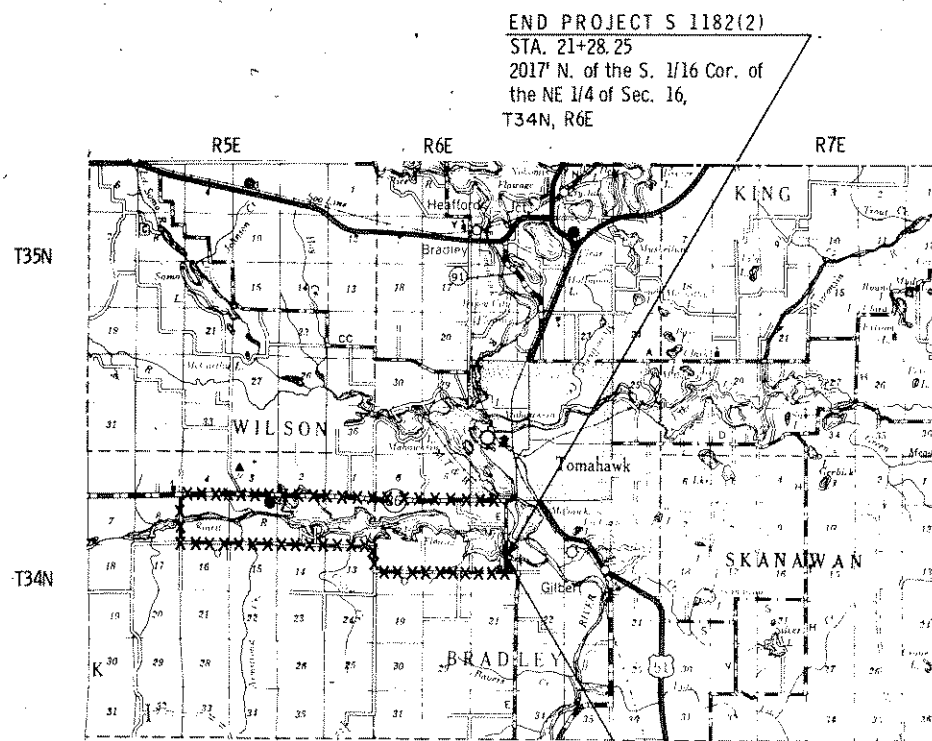

END PROJECT S 1182(2)
STA. 21+28.25
2017' N. of the S. 1/16 Cor. of
the NE 1/4 of Sec. 16,
T34N, R6E

BEGIN PROJECT S 1182(2)
STA. 20+19.75
1908.5' N. of the S. 1/16 Cor. of
the NE 1/4 of Sec. 16, T34N, R6E

LAYOUT
SCALE 2 MI.

TOTAL NET LENGTH OF CENTERLINE = 0.021 MI.

COUNTY AND HIGHWAY	ROUTE AND SECTION	CLASS AND AGREEMENT		B.P.P. REGION DIVISION	SHEET NUMBER	TOTAL SHEETS
		STATE	FEDERAL			
35.6	1182.0		11.2	4 WIS.	1	13

APPROVED FOR LINCOLN COUNTY
Francis X Fox
Date May 18 67 COUNTY HIGHWAY COMMISSIONER
Title

STATE HIGHWAY COMMISSION OF WISCONSIN MADISON, WIS.	
SURVEYOR J. WALLIN	NOTE BOOK 309
DIVISION COMPUTER W. CAIN	M. O. CHECKER W.H.B.
DISTRICT CHECKER G. WINAT	CORRECT
CORRECT:	
DATE 4/24/67	<i>Man Jutte</i> DISTRICT ENGINEER
RECOMMENDED FOR APPROVAL:	
DATE 4/28/67	<i>E.J. Bork</i> CHIEF DESIGN ENGINEER
APPROVED:	
DATE 5/1/67	<i>A. Burmeister</i> STATE HIGHWAY ENGINEER
DEPARTMENT OF COMMERCE BUREAU OF PUBLIC ROADS	
APPROVED:	
DATE	
DIVISION ENGINEER	