

STATE PROJECT	FEDERAL PROJECT	
	PROJECT	CONTRACT
9864-02-70		

Index of Sheets

Sheet No. 1	Title
Sheet No.	Typical Cross Sections
Sheet No.	Estimate of Quantities
Sheet No.	Miscellaneous Quantities
Sheet No.	Right of Way Plat
Sheet No.	Plan and Profile STA. 10+00 - 22+00
Sheet No.	Standard Details
Sheet No.	Structure Plans
Sheet No.	Computer Earthwork Data
Sheet No.	Cross Sections

TOTAL SHEETS =



STATE OF WISCONSIN
DEPARTMENT OF TRANSPORTATION
 PLAN OF PROPOSED IMPROVEMENT

SPIRIT RIVER BRIDGE & APPROACHES
BRIDGE ROAD (TOWN ROAD)
 LINCOLN COUNTY

STATE PROJECT NUMBER
9864-02-70

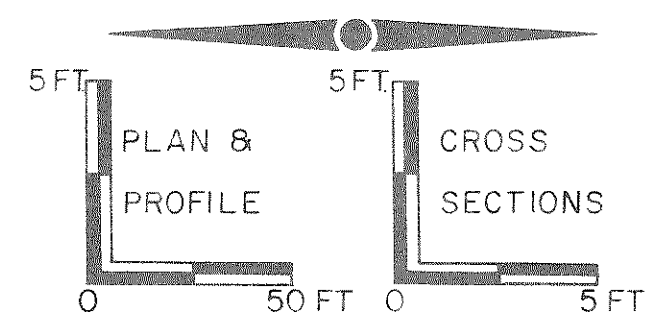

Design Designation

A.D.T. (1986)	■ 50
A.D.T. (2006)	■ 100
D.H.V. (2006)	■ 18
D.	■ 60/40
T.	■ 6%
V.	■ 40 M.P.H.

Conventional Signs

County Line	-----	Culverts in Place	-----
Township or Range Line	-----	Culverts Required	-----
Section Line	-----	Drop Inlet	-----
New Right of Way Line	-----	Power Pole	-----
Present Right of Way Line	-----	Telephone or Telegraph Pole	-----
Wire Fence	-----	Right of Way Markers	-----
Corporate or City Limits	-----	Reference Stake for Hubs Only	-----
Property Line	-----	Marsh	-----
Traveled Way or P.E.	-----	Hedge	-----
Railroads	-----	Trees	-----
Base or Survey Line	-----	Ground Elevation	-----
Caution Symbol (combustible fluids under pressure)	-----	Grade Elevation	-----

BEGIN PROJECT
 STA. 10 + 00
 N = 589,200 (±200')
 E = 2,005,200 (±200')

END PROJECT
 STA. 22 + 00

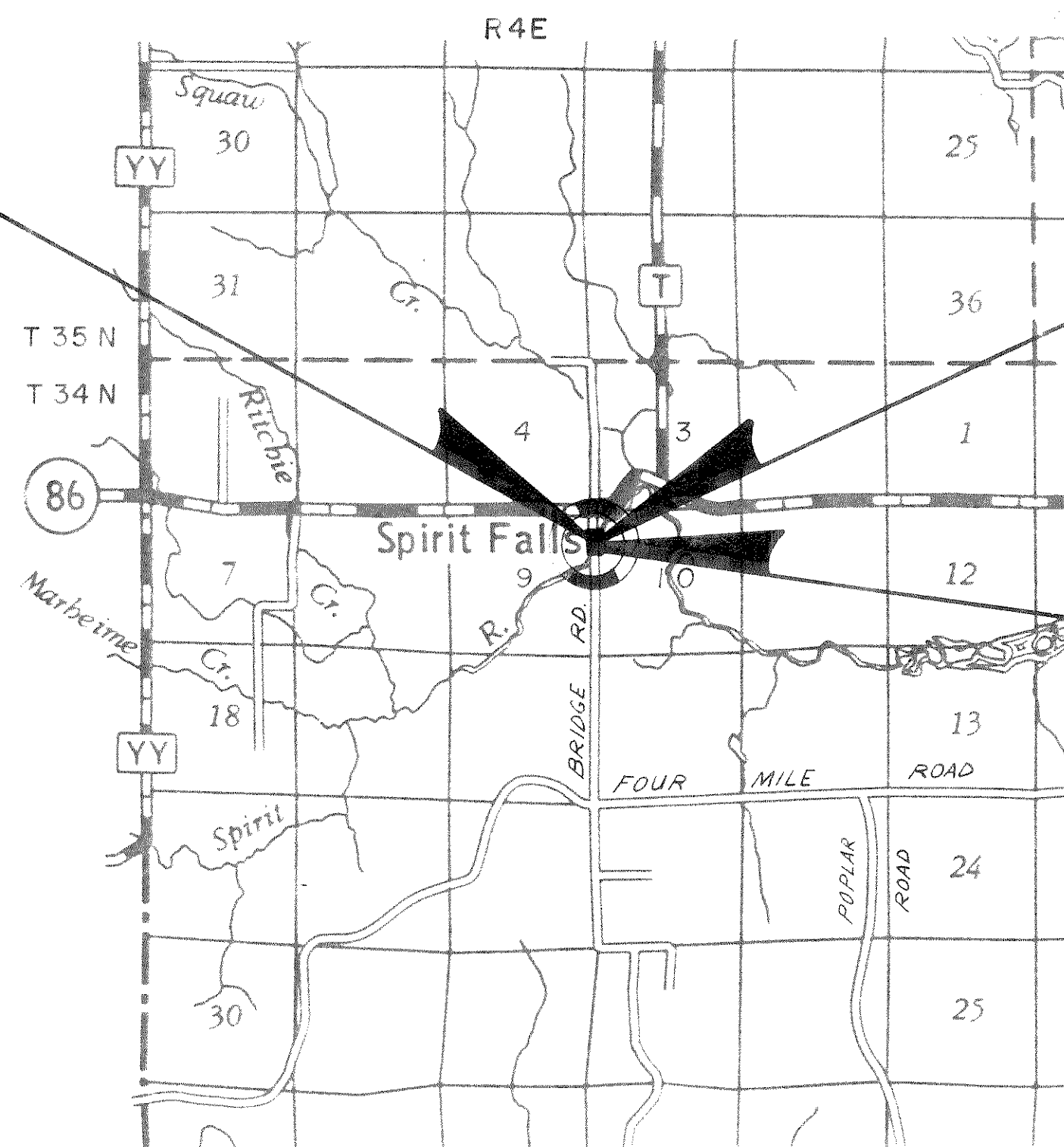

STRUCTURE B-35-91

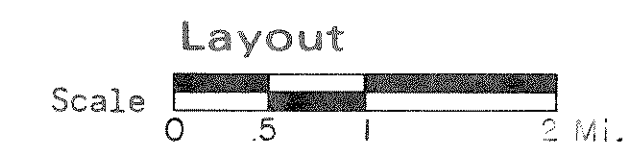

Total Net Length of Centerline = 0.227 Mi. (RURAL)

COORDINATES SCALED FROM U.S.G.S. TOPOGRAPHIC
 MAP SPIRIT FALLS, WISCONSIN, QUADRANGLE FOR
 IDENTIFICATION ONLY.

FILE COPY

APPROVED FOR
 LINCOLN
 COUNTY BY

10/9/85 (Date) *Michael J. Heup* (Signature of Official)

ORIGINAL
 PLANS PREPARED BY
 BARRIENTOS & ASSOCIATES, INC.
 CONSULTING ENGINEERS
 MADISON, WISCONSIN

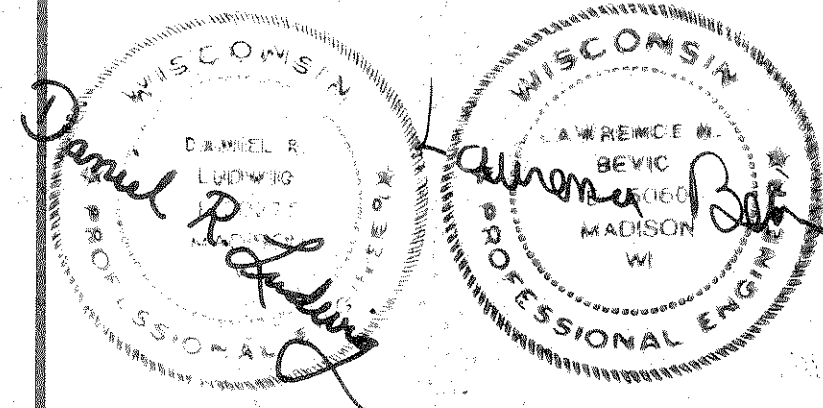

STATE OF WISCONSIN
 DEPARTMENT OF TRANSPORTATION

Surveyor BAI District Checker _____
 Designer BAI C.O. Checker _____
 District Supervisor _____ C.O. Coordinator _____

Approved: _____
 Date _____ District Transportation Director

Approved: _____
 Date _____ Chief Design Engineer

Approved: _____
 Date _____ Director of Development

U.S. DEPARTMENT OF TRANSPORTATION
 FEDERAL HIGHWAY ADMINISTRATION
 REGION 5 WISCONSIN DIVISION

Approved: _____
 Date _____ Division Administrator

FINAL PLANS 12-20-85