

B. P. R. DIVISION	PROJECT	SHEET NUMBER	TOTAL SHEETS
	SU 0593(4)	9	33

DATE: 11-63
BY: E.F.S.
CHECKED: D.L.J.
NO. 240

PLAN
SURVEYED, PLOTTED, AND CHECKED BY E.F.S.
NOTE BOOK: GRADIS CHECKED BY D.L.J.
NO. 240

DATE: 11-63
BY: E.F.S.
CHECKED: D.L.J.
NO. 240

PROFILE
SURVEYED, PLOTTED, AND CHECKED BY E.F.S.
NOTE BOOK: GRADIS CHECKED BY D.L.J.
NO. 240

STA. 33+00 TO 37+17.3 LT.
595 LIN. FT. CONCRETE CURB & GUTTER REMOVE
434 LIN. FT. CONCRETE CURB & GUTTER 30" TYPE "D" REQ'D.

STA. 37+17 LT.
EXISTING CATCH BASIN REMOVE

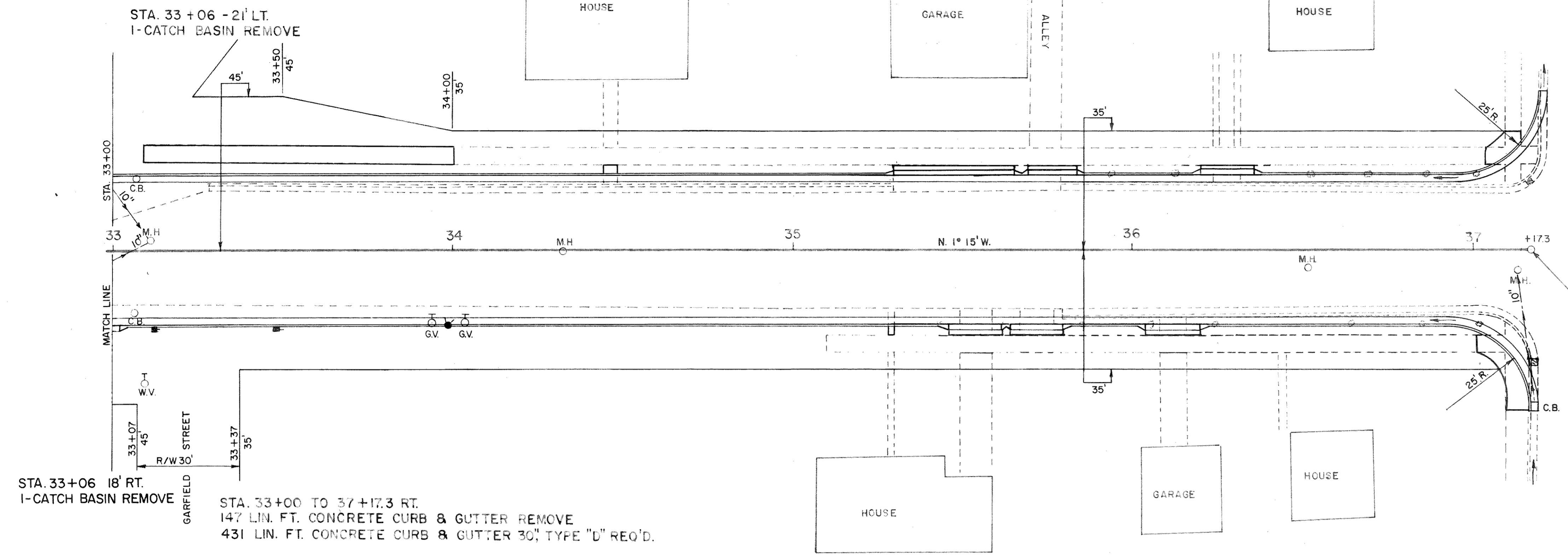

STA. 37+17 RT.
EXISTING CATCH BASIN REMOVE
1- CATCH BASIN TYPE 2A REQ'D
GRATE FLOWLINE ELEV. 1269.45
CATCH BASIN DISCHARGE ELEV. 1266.00
1-10"X36" EXTRA STRENGTH NONREINFORCED CPSS REQ'D
PIPE INLET ELEV. 1266.00
DISCHARGE ELEV. 1265.50

END OF PROJECT SU 0593(4) STA. 37+17.3

NET CENTERLINE LENGTH STA. 33+00 TO 37+17.3 = 4173 LIN. FT.

BENCH MARK			
NO	STATION	DESCRIPTION	ELEV.
5A	35+30	S. COR. BOTTOM STEP	50' RT. 1268.38

