

| | | | |
|-------------------|------------|--------------|--------------|
| B. P. R. DIVISION | PROJECT | SHEET NUMBER | TOTAL SHEETS |
| | SU 0593(4) | 6 | 33 |

STA. 15+00 TO 17+33 LT.
233 LIN. FT. CONCRETE CURB & GUTTER 30" TYPE "D" REQ'D.

STA. 17+22 LT.
1-CATCH BASIN TYPE 2A REQ'D.
GRATE FLOWLINE ELEV. 1264.95
CATCH BASIN DISCHARGE ELEV. 1260.00
1-10" X 26" EXTRA STRENGTH NONREINFORCED CPSS REQ'D.
PIPE INLET ELEV. 1260.00
DISCHARGE ELEV. 1259.50

STA. 16+85 - 17+25 LT. & RT.
81 LIN. FT. STEEL PLATE BEAM GUARD REQ'D.

STA. 16+26 5' LT. IRON PIPE - SAVE
SEE SPECIAL PROVISIONS

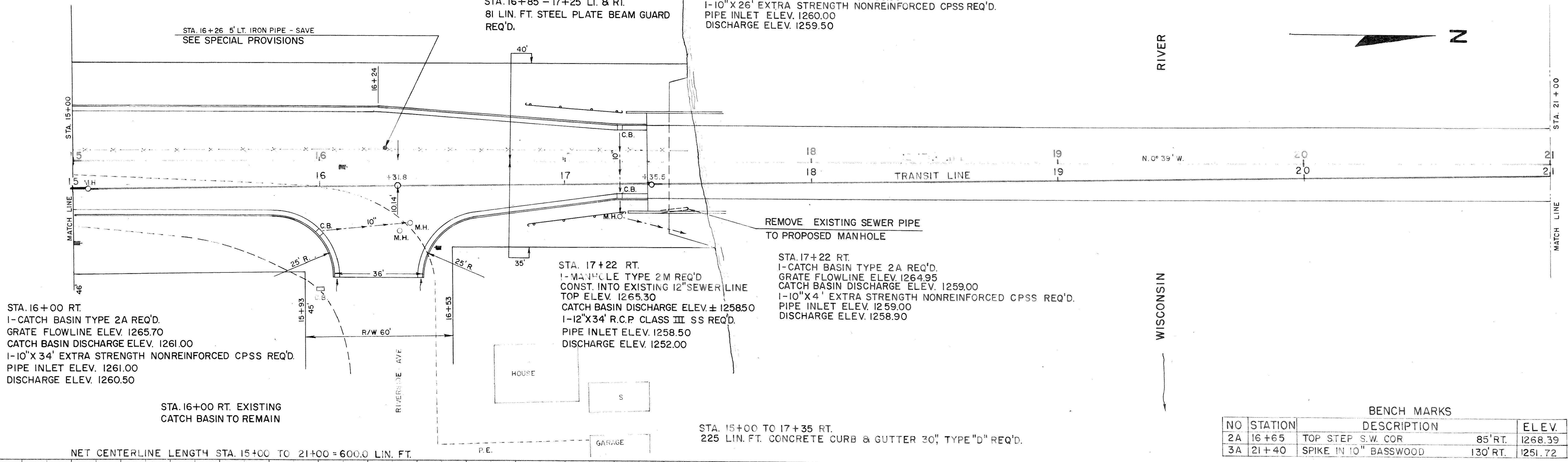

STA. 16+00 RT.
1-CATCH BASIN TYPE 2A REQ'D.
GRATE FLOWLINE ELEV. 1265.70
CATCH BASIN DISCHARGE ELEV. 1261.00
1-10" X 34' EXTRA STRENGTH NONREINFORCED CPSS REQ'D.
PIPE INLET ELEV. 1261.00
DISCHARGE ELEV. 1260.50

STA. 17+22 RT.
1-MANHOLE TYPE 2M REQ'D
CONST. INTO EXISTING 12" SEWER LINE
TOP ELEV. 1265.30
CATCH BASIN DISCHARGE ELEV. ± 1258.50
1-12" X 34' R.C.P. CLASS III SS REQ'D.
PIPE INLET ELEV. 1258.50
DISCHARGE ELEV. 1252.00

STA. 17+22 RT.
1-CATCH BASIN TYPE 2A REQ'D.
GRATE FLOWLINE ELEV. 1264.95
CATCH BASIN DISCHARGE ELEV. 1259.00
1-10" X 4' EXTRA STRENGTH NONREINFORCED CPSS REQ'D.
PIPE INLET ELEV. 1259.00
DISCHARGE ELEV. 1258.90

STA. 15+00 TO 17+35 RT.
225 LIN. FT. CONCRETE CURB & GUTTER 30" TYPE "D" REQ'D.

BENCH MARKS

| NO | STATION | DESCRIPTION | ELEV. |
|----|---------|-----------------------|------------------|
| 2A | 16+65 | TOP STEP S.W. COR | 85' RT. 1268.39 |
| 3A | 21+40 | SPIKE IN 10" BASSWOOD | 130' RT. 1251.72 |

PLAN

| | |
|-------|--------|
| DATE | BY |
| 11-63 | E.F.S. |
| 4-64 | D.L.J. |
| 4-64 | F.L. |

NO. 240

PROFILE

| | |
|-------|--------|
| DATE | BY |
| 11-63 | E.F.S. |
| 4-64 | D.L.J. |

NO. 240

