

B. P. R. DIVISION	PROJECT	SHEET NUMBER	TOTAL SHEETS
	SU 0593(4)	4	33

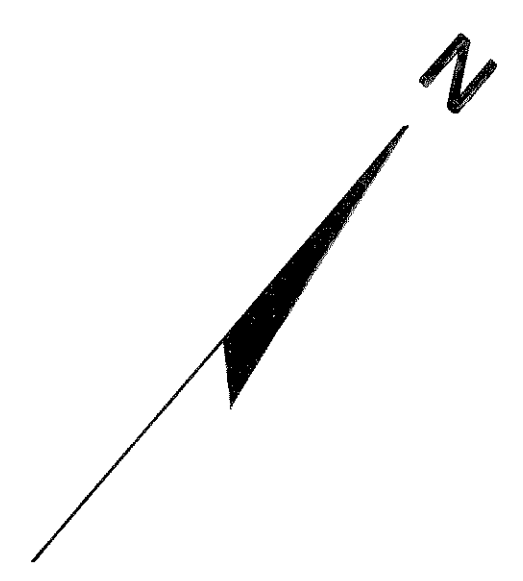

DATE 11-63
BY E.S.
SURVEYED
NOTE BOOK ALIGNED CHECKED
RT. OF WAY CHECKED
NO. 240
PLAN

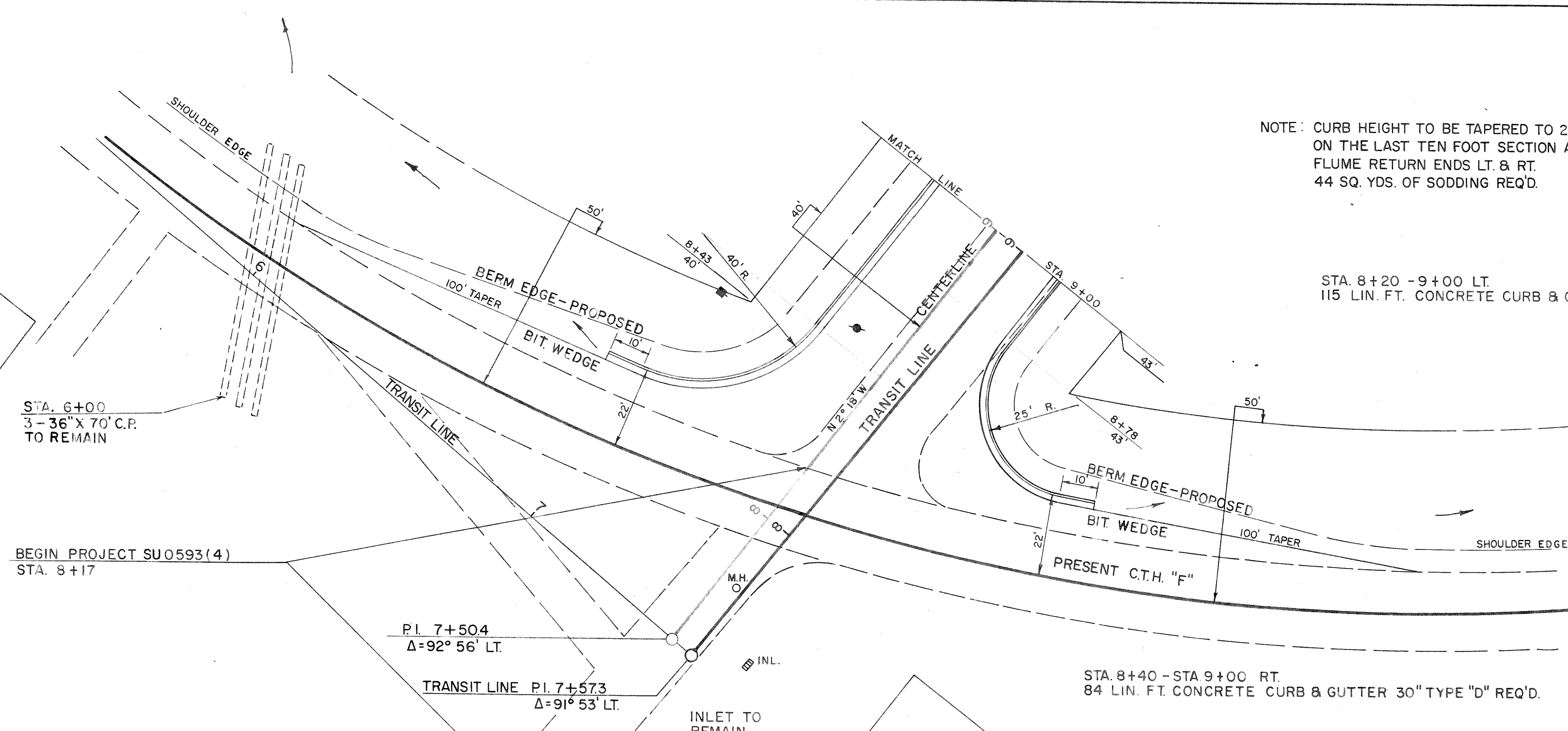

NOTE: CURB HEIGHT TO BE TAPERED TO 2 INCHES ON THE LAST TEN FOOT SECTION AT RADIUS RETURNS FLUME RETURN ENDS LT. & RT. 44 SQ. YDS. OF SODDING REQ'D.

NET CENTERLINE LENGTH STA. 8+17-9+00=83 LIN. FT.

NO	STATION	DESCRIPTION	ELEV.
1	6+80	N.W. COR. OF 1ST. STEP 90' RT.	1264.38

DATE 11-63
BY E.S.
SURVEYED
NOTE BOOK GRADES CHECKED
B. AS NOTED
C. AS NOTED
D. AS NOTED
E. AS NOTED
NO. 240
PROFILE

