

ELEVATION

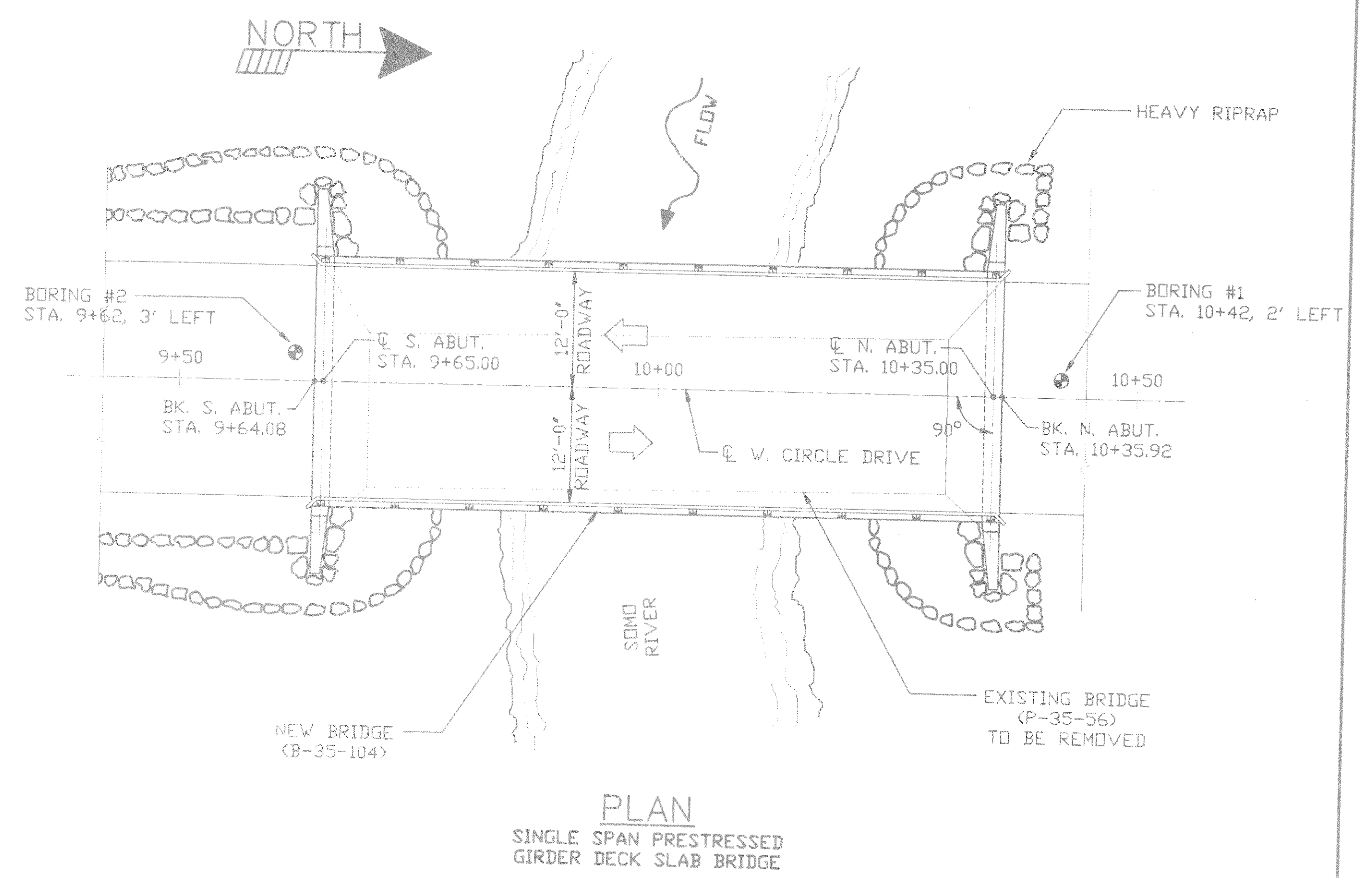

PLAN
SINGLE SPAN PRESTRESSED
GIRDER DECK SLAB BRIDGE

BORINGS BY: Environmental & Foundation Drilling, Inc.
MADISON, WISCONSIN

MATERIAL DESCRIPTIONS

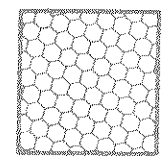
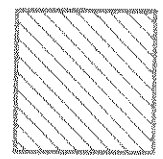
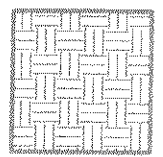
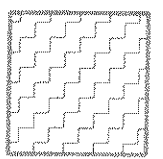
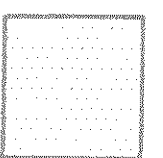
-  FILL - BROWN TO REDISH BROWN LAYERS OF SANDY SILT, SAND AND GRAVEL.
-  FILL - BROWN TO REDISH BROWN LAYERS OF SILTY AND CLAYEY FINE SAND, SANDY SILT AND F-M SAND.
-  REDISH BROWN SILTY F-M SAND WITH GRAVEL, SOME CLAY AND OCCASSIONAL COBBLES.
-  BROWN CLAYEY F-M SAND WITH SOME SILT AND GRAVEL.
-  BROWN TO GRAYISH BROWN SANDY SILT WITH SOME GRAVEL.

* THE BLOWS PER FOOT AT THE LOCATIONS INDICATED ARE BASED ON DRIVING A 2" O.D. SPLIT BARREL SAMPLER WITH A 140 LB. HAMMER HAVING A FREE FALL OF 30". THE BLOW COUNT IS TAKEN IN UN-DISTURBED SOIL 6" BELOW A CASED HOLE ELIMINATING SIDE FRICTION ON THE DRIVE PIPE.

SUBSURFACE EXPLORATION FOR FOUNDATION
DESIGN AND BIDDERS INFORMATION

To obtain relative data concerning the character of material in and upon which the foundation might be built, borings were made at points approximately as indicated on this drawing. The data presented herein represents the findings of the subsurface explorations made. However, because the depths investigated are limited and the area of the borings is very small in relation to the entire area, the Department of Transportation does not warrant conditions below the depths investigated or that the classification of material encountered in these investigations is necessarily typical of the entire site.

S-SOIL.DWG

No.	Date	Revision	By
BECHER-HOPPE Inc. ENGINEERS, ARCHITECTS, PLANNERS 330 Fourth Street Wausau, WI. 54402			
STATE OF WISCONSIN DEPARTMENT OF TRANSPORTATION			
STRUCTURE B-35-104			
Const. Spec.:	WI. 1989	Drawn By:	DGK
Plans Checked:			
SUBSURFACE EXPLORATION		SHEET 2 of 7 X82697	