

BENCH MARKS

NO.	STA.	DESCRIPTION	ELEV.
1		TOP OF BOLT IN SW COR. ABUT. PILING, PAINTED RED	1412.38

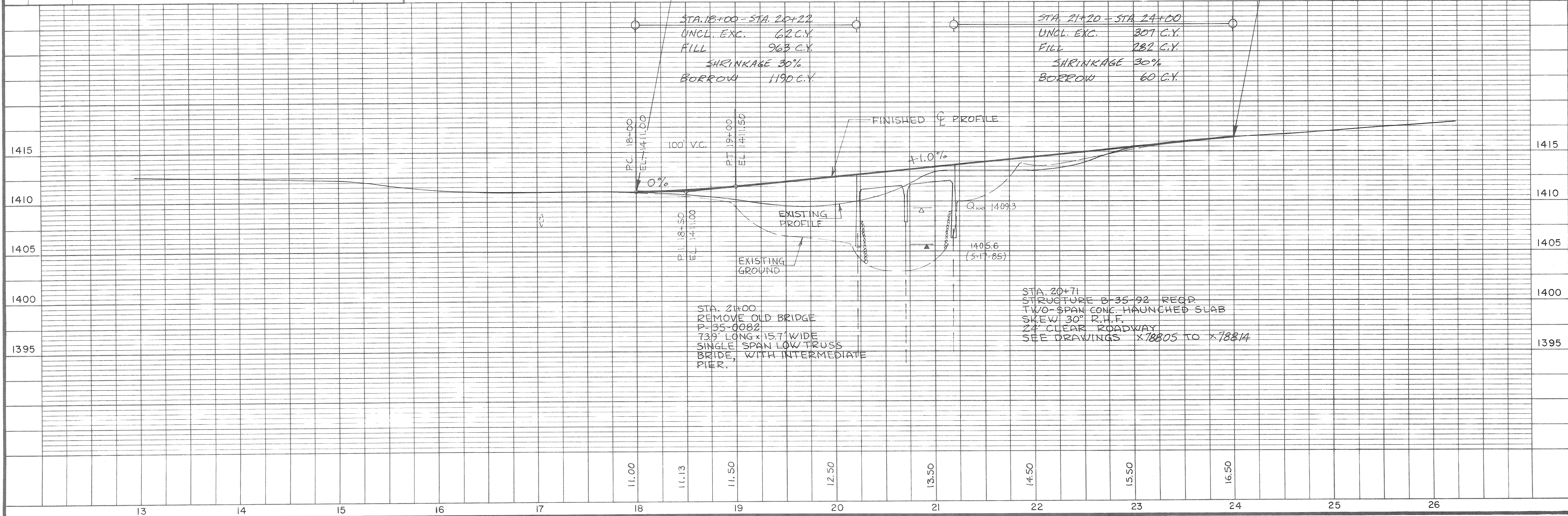

P.I. 19+29.56
 Δ 40°-15'-23"
 D 21°-00'-00"
 T 100.00'
 L 191.70'
 R 272.84'
 $S.E.$ N/C

P.I. 23+10.75
 Δ 17°-16'-03"
 D 12°-00'-00"
 T 72.50'
 L 143.90'
 R 477.47'
 $S.E.$ N/C

STA. 18+00 - STA. 20+22
 UNCL. EXC. 62 C.Y.
 FILL 963 C.Y.
 SHRINKAGE 30%
 BORROW 1190 C.Y.

STA. 21+20 - STA. 24+00
 UNCL. EXC. 307 C.Y.
 FILL 282 C.Y.
 SHRINKAGE 30%
 BORROW 60 C.Y.

STA. 21+00
 REMOVE OLD BRIDGE
 P-35-0082
 739' LONG x 15.7' WIDE
 SINGLE SPAN LOW TRUSS
 BRIDGE, WITH INTERMEDIATE
 PIER.

STA. 20+71
 STRUCTURE B-35-92 REQ'D.
 TWO-SPAN CONC. HAUNCHED SLAB
 SKEW 30° R.H.F.
 24' CLEAR ROADWAY
 SEE DRAWINGS X78805 TO X78814