

INDEX OF SHEETS

Sheet No. 1	Title
Sheet No.	Typical Sections and Details
Sheet No.	Estimate of Quantities
Sheet No.	Miscellaneous Quantities
Sheet No.	Right of Way Plat
Sheet No.	Plan and Profile
Sheet No.	Standard Detail Drawings
Sheet No.	Sign Plates
Sheet No.	Structure Plans
Sheet No.	Computer Earthwork Data
Sheet No.	Cross Sections

TOTAL SHEETS =

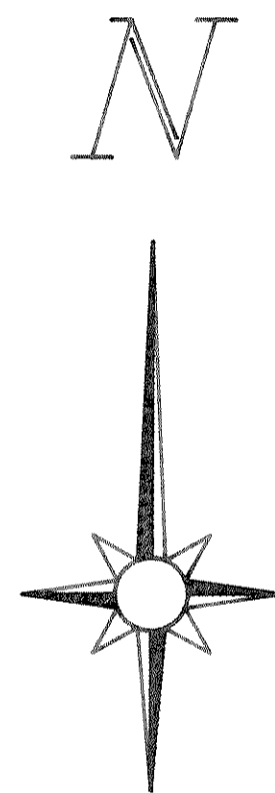

DESIGN DESIGNATION

A.D.T. (1990)	60
A.D.T. (2010)	73
D.H.V.	
D.	
I.	8%

CONVENTIONAL SIGNS

COUNTY LINE	-----	COMBUSTIBLE FLUIDS (UNDER PRESSURE)	☠
CORPORATE LIMITS	//////	UNDERGROUND UTILITIES	
PROPERTY LINE	-----	GAS	— G —
LOT LINE	-----	ELECTRIC	— E —
LIMITED HIGHWAY EASEMENT	-----	TELEPHONE	— T —
EXISTING RIGHT OF WAY	-----	SERVICE PEDESTAL	☒
NEW RIGHT OF WAY	-----	CABLE MARKER	P
REFERENCE LINE	-----	POWER POLE	⊥
SLOPE INTERCEPT	-----	TELEPHONE POLE	⊥
ORIGINAL GROUND	-----	RAILROADS	+++++
MARSH OR ROCK PROFILE	-----	MARSH	~~~~~
CULVERT IN PLACE	-----	WOODED AREA	
CULVERT REQUIRED	-----		
CULVERT REQUIRED (Profile)	-----		

STATE OF WISCONSIN
DEPARTMENT OF TRANSPORTATION

PLAN OF PROPOSED IMPROVEMENT

PRAIRIE RIVER BRIDGE & APPROACHES

(BACHELORS AVENUE)

TOWN ROAD

LINCOLN COUNTY

STATE PROJECT NUMBER
9859-05-70

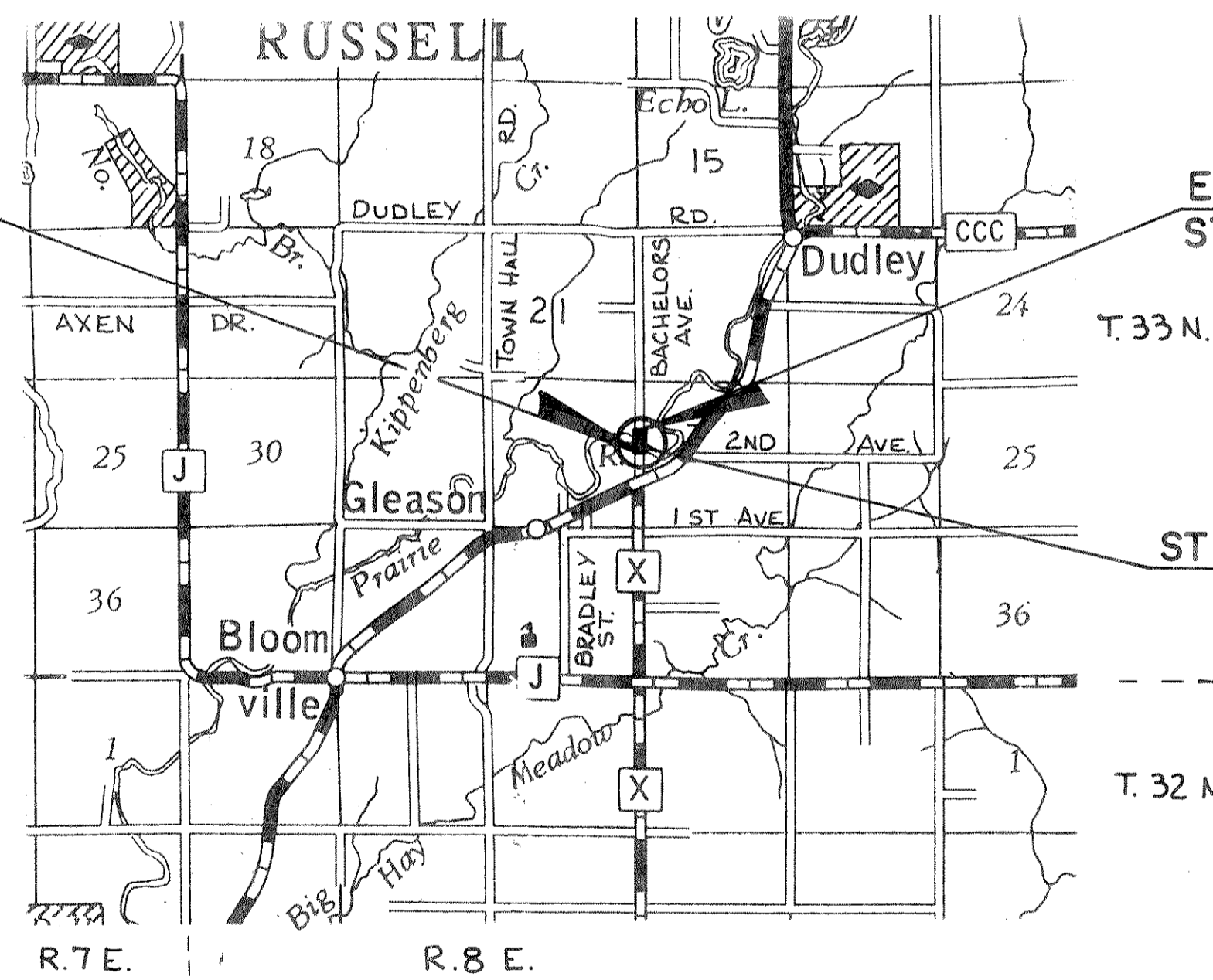

BEGIN PROJECT
STA. 12+00
N = 540,800 (±100')
E = 2,132,200 (±100')

END PROJECT
STA. 17+50

STRUCTURE B-35-106

LAYOUT
SCALE 0 1 MI.

TOTAL NET LENGTH OF CENTERLINE = 0.104 MI. (RURAL)

NOTE: All coordinates shown are referenced to the WISCONSIN COORDINATE SYSTEM, CENTRAL ZONE, and are scaled from the GLEASON QUADRANGLE for identification purposes only.

STATE PROJECT	FEDERAL PROJECT	
	PROJECT	CONTRACT
9859-05-70		

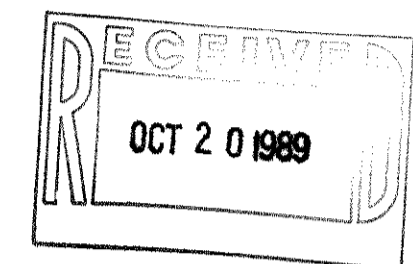

*Final Plans Received
As Approved For
Submitted to WISDOT
mjk
10/23/89*

APPROVED FOR
LINCOLN
COUNTY BY

10/23/89
DATE
Michael Step
HIGHWAY COMMISSIONER

ORIGINAL
PLANS PREPARED BY
BARRIENTOS & ASSOC., INC.
CONSULTING ENGINEERS
MADISON, WISCONSIN

*Lawson River
10-18-89*

STATE OF WISCONSIN
DEPARTMENT OF TRANSPORTATION

Surveyor BAI District Checker FWB
Designer BAI C.O. Checker
District Supervisor RJS C.O. Coordinator

APPROVED:
DATE: _____ DISTRICT DIRECTOR
APPROVED:

DATE: _____ REGIONAL CHIEF ROAD DESIGN ENG.

U.S. DEPARTMENT OF TRANSPORTATION
FEDERAL HIGHWAY ADMINISTRATION
REGION 5 WISCONSIN DIVISION

APPROVED:
DATE: _____ DIVISION ADMINISTRATOR