

- POINT NOTES**
1. MATERIAL - CAST STEEL (ASTM A-27-84-65-35)
  2. ALL FILLETS = 10 mm
  3. ALL WELDS BETWEEN PILE & POINT TO BE IN ACCORDANCE WITH AWS SPEC'S. WELD FLANGES TO FITTING ON OUTSIDE FACES.
  4. CONTRACTOR MAY USE AN ALTERNATE DESIGN UPON APPROVAL OF THE ENGINEER.

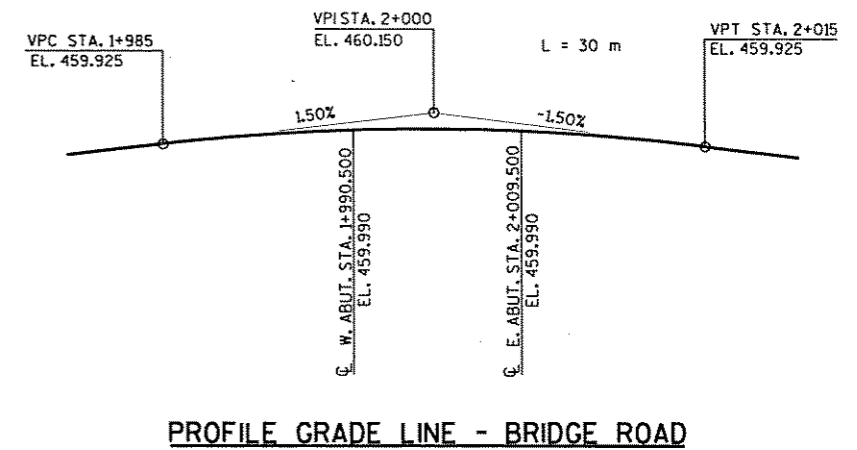

**TOTAL ESTIMATED QUANTITIES**

BID ITEMS	UNIT	WEST ABUT.	EAST ABUT.	SUPER	TOTAL
REMOVING OLD BRIDGE, STATION 2+000, ON C	LS	-	-	-	1
EXCAVATION FOR STRUCTURES, BRIDGES B-35-136	LS	-	-	-	1
STRUCTURE BACKFILL	m3	100	100	-	200
CONCRETE MASONRY, BRIDGES	m3	22.5	22.5	47.0	92
PROTECTIVE SURFACE TREATMENT	m2	-	-	165	165
PRESTRESSED GIRDER, I TYPE, 915 mm	m	-	-	77.2	77.2
HIGH-STRENGTH BAR STEEL REINFORCEMENT, BRIDGES	kg	935	935	1940	3810
COATED HIGH-STRENGTH BAR STEEL REINFORCEMENT, BRIDGES	kg	210	210	2900	3320
NON-LAMINATED ELASTOMERIC BEARING PADS	EACH	-	-	8	8
STEEL PILING DELIVERED & DRIVEN, HP 250 mm x 62 kg/m	m	35	35	-	70
PILE POINTS	EACH	5	5	-	10
RUBBERIZED MEMBRANE WATERPROOFING	m2	5	5	-	10
HEAVY RIPRAP	m3	75	80	-	155
GEOTEXTILE FABRIC, TYPE HR	m2	140	145	-	285
ARCHITECTURAL SURFACE TREATMENT, ITEM 90002	m2	10.9	10.9	-	21.8
GLULAM ELEMENT RAILING, ITEM 90004	LS	-	-	-	1
PAINTING, EPOXY SYSTEM, ITEM 90004	LS	-	-	-	1
NON-BID ITEMS					
FILLER	SIZE	-	-	-	13 & 19

\* - OIL FIELD PIPE IS NOT AN OPTION ON THIS PROJECT.

**GENERAL NOTES**

DRAWINGS SHALL NOT BE SCALED.  
 ALL MEASUREMENTS ARE IN MILLIMETERS EXCEPT AS SHOWN.  
 ALL ELEVATIONS AND STATIONS ARE IN METERS.  
 BAR STEEL REINFORCEMENT SHALL BE EMBEDDED 50 mm CLEAR UNLESS SHOWN OR NOTED OTHERWISE.  
 THE FIRST TWO DIGITS OF A BAR MARK SIGNIFIES THE BAR SIZE.  
 NON-LAMINATED ELASTOMERIC BEARING PADS NEED NOT BE INDIVIDUALLY MOLDED PROVIDED THE CUT EDGES ARE SMOOTH AND TRUE.  
 THE SLOPE OF THE FILL IN FRONT OF THE ABUTMENTS SHALL BE COVERED WITH HEAVY RIPRAP AS SHOWN ON SHEET 1 OR AS DIRECTED BY THE ENGINEER.  
 THE PROPOSED SUBGRADE SHALL BE THE UPPER LIMITS OF "EXCAVATION FOR STRUCTURES" FOR THE ABUTMENTS.  
 AT THE ABUTMENTS ALL EXCAVATED VOLUME NOT OCCUPIED BY THE NEW STRUCTURE SHALL BE BACKFILLED WITH STRUCTURE BACKFILL. THE STRUCTURE BACKFILL ESTIMATED QUANTITIES ASSUMED A 1:1.5 EXCAVATION SLOPE.  
 THIS STRUCTURE WILL REPLACE EXISTING STRUCTURE P-35-0067, A THREE SPAN TIMBER DECK GIRDER ON TIMBER ABUTMENTS AND TIMBER PILE BENT PIERS.  
 ALTERNATE STEEL INTERMEDIATE DIAPHRAGMS WILL NOT BE PERMITTED ON THIS STRUCTURE.  
 THE MINIMUM CONCRETE HAUNCH OVER THE PRESTRESSED GIRDERS SHALL BE 30 mm AND THE HAUNCH CONCRETE QUANTITY IS BASED ON AN AVERAGE HAUNCH DEPTH OF 60 mm WHICH IS THE MAXIMUM HAUNCH QUANTITY FOR WHICH THE CONTRACTOR WILL BE PAID.

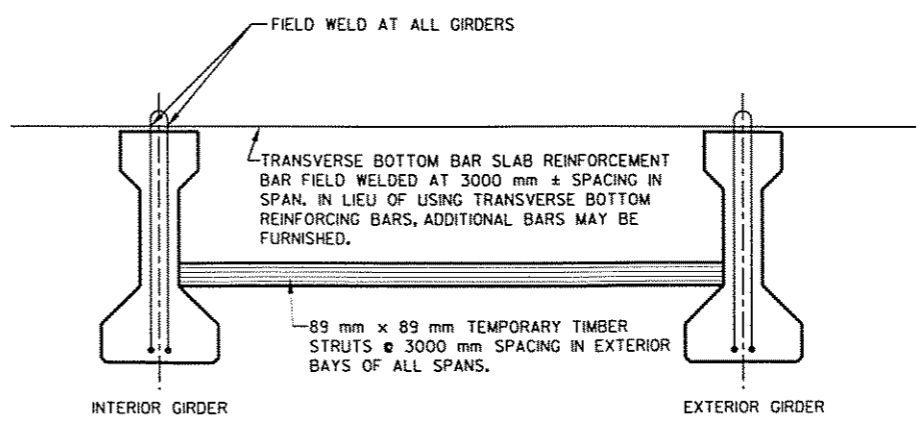

**CROSS SECTION THRU RDWY.**  
(EXT. GIRDER BRACING FOR SLAB OVERHANG)

No.	Date	Revision	By
STATE OF WISCONSIN DEPARTMENT OF TRANSPORTATION			
<b>STRUCTURE B-35-136</b>			
Const. Spec.	WI '96"	Drawn By RLR	Plans Checked JMB
<b>CROSS-SECTION &amp; QUANTITIES</b>			SHEET 2 OF 9

ORIGINAL: RLR  
 LEVELS ON 1, 2, 3, 4, 5, 6, 7, 8, 9, 10, 11, 12, 13, 14, 15, 16, 17, 18, 19, 20, 21, 22, 23, 24, 25, 26, 27, 28, 29, 30, 31, 32, 33, 34, 35, 36, 37, 38, 39, 40, 41, 42, 43, 44, 45, 46, 47, 48, 49, 50, 51, 52, 53, 54, 55, 56, 57, 58, 59, 60, 61, 62, 63  
 MSA #: 933966102  
 REV. DATE: 9-11-97  
 PLOT SCALE: