

MARATHON

9859-07-71

INDEX OF SHEETS

Sheet No.	Title
1	Typical Section Sheet
	Estimate of Quantities
	Miscellaneous Quantities
	Right of Way Plan
	Plan & Profile (includes Erosion Control Plan)
	Standard Detail Drawings
	Sign Plates
	Structure Plans
	Computer Earthwork Data
	Cross Sections

TOTAL SHEETS =



DESIGN DESIGNATION

A.D.T.	(1998)	=	5
A.D.T.	(2018)	=	10
D.H.V.	(2018)	=	1
D.		=	50/50
T.		=	1%
DESIGN SPEED		=	50 km/h
ESALS		=	N/A

Conventional Symbols

County Line	-----	Combustible Fluids	CAUTION
Town or Range Line	-----	Railroad	—X—X—
Section Line	-----	Fence	—X—X—
Corporate Limits	-----	Culvert (in Place)	—X—X—
Property Line	-----	Culvert (Required)	—X—X—
Lot Line	-----	Power Pole	—X—X—
Existing Right of Way Line	-----	Telephone Pole	—X—X—
New Right of Way Line	-----	Telephone Pedestal	—X—X—
Reference Line	-----	Right of Way Monument (Type)	—X—X—
Slope Intercept	-----	Marsh	—X—X—
Existing Roadway or Private Entrance	-----	Edge of Stream	—X—X—
Limited Easement	-----	Wooded or Shrub Area	—X—X—
Right of Way Point	-----	Grade Line Elevation	—X—X—
Silt Fence	-----	Water	—X—X—
Silt Screen	-----	Gas	—X—X—
Erosion Boles	-----	Telephone	—X—X—
Sod	-----	Electric	—X—X—
Ditch Dike	-----	Cable Television	—X—X—
Intercepting Embankment	-----	Fiber Optic	—X—X—
Riprap	-----	Sanitary Sewer	—X—X—
Erosion Mat	-----	Storm Sewer	—X—X—

STATE OF WISCONSIN
DEPARTMENT OF TRANSPORTATION

PLAN OF PROPOSED IMPROVEMENT

PRAIRIE RIVER BRIDGE & APPROACHES

(BRIDGE ROAD)

TOWN ROAD

LINCOLN COUNTY

STATE PROJECT NUMBER
9859-07-71

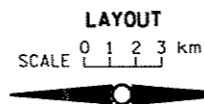
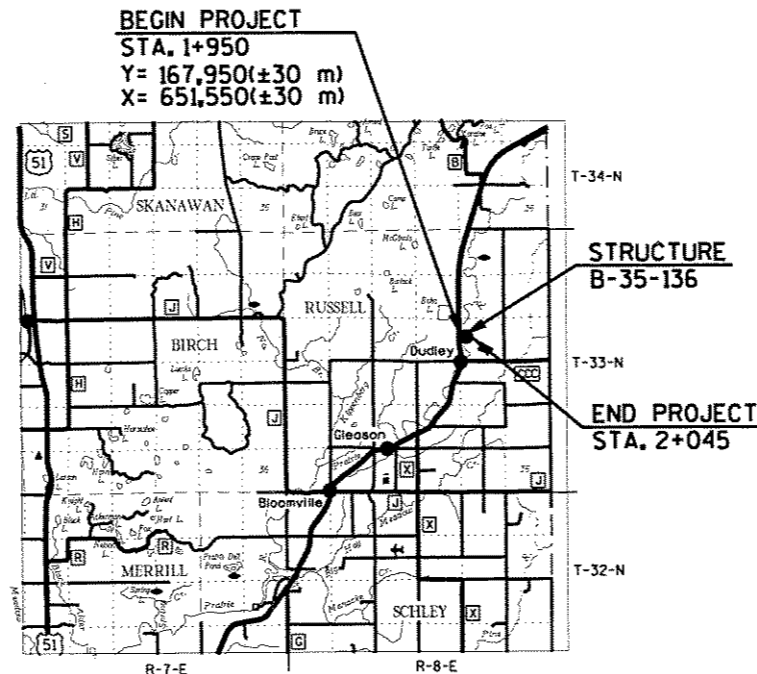

TOTAL NET LENGTH OF CENTERLINE = 0.095 km (RURAL)

COORDINATES ARE SCALED FROM THE U.S.G.S. TOPOGRAPHIC MAP GLEASON, WISCONSIN QUADRANGLE, FOR IDENTIFICATION ONLY.

STATE PROJECT	FEDERAL PROJECT	
	PROJECT	CONTRACT
9859-07-71		

ACCEPTED FOR
COUNTY OF LINCOLN

DATE _____ COMMISSIONER _____

ORIGINAL PLANS PREPARED BY:
MSA PROFESSIONAL SERVICES, INC.
TRANSPORTATION - MUNICIPAL - RECREATION
DEVELOPMENT - ENVIRONMENTAL
1220 South Boulevard, Baraboo, WI 53513
608-356-2771 1-800-363-4505 Fax: 608-356-2770

PREPARED BY
Surveyor _____ MSA PROFESSIONAL SERVICES, INC.
Designer _____ MSA PROFESSIONAL SERVICES, INC.
District Examiner _____
District Supervisor _____
Proj. Dev. Engineer _____
C.O. Examiner _____

APPROVED FOR DISTRICT OFFICE

DATE: _____ (Signature) _____