

STATE PROJECT	FEDERAL PROJECT	
	PROJECT	CONTRACT
9859-07-70	BRO 1998 (254)	1

**STATE OF WISCONSIN
DEPARTMENT OF TRANSPORTATION**

PLAN OF PROPOSED IMPROVEMENT

**PRAIRIE RIVER BRIDGE & APPROACHES
(BRIDGE ROAD)
TOWN ROAD
LINCOLN COUNTY**

STATE PROJECT NUMBER
9859-07-70

- As Built-
- Prime Contractor
- Zenith Tech, Inc.
- Sub Contractors
- Karlson Forming Specialty, Inc.
 - United Painting, Inc.
 - Rent-a-Flash of Wisconsin
 - Roswell Electric
 - American Asphalt of Wisconsin
 - Hi Beam Erecting
 - Timberline Contractors
 - Merrill Gravel & Construction

Project Engineer
- Allen M. Wesolowski
CWE, Inc. (715) 359 9400

Start work: 6/12/98
Work complete: 8/15/98
Project Diary: 98-08

INDEX OF SHEETS

Sheet No. 1	Title
Sheet No. 2	Typical Section Sheet
Sheet No. 3 & 3.1	Estimate of Quantities
Sheet No. 2	Miscellaneous Quantities
Sheet No. 4	Right of Way Plan
Sheet No. 5	Plan & Profile (includes Erosion Control Plan)
Sheet No. 6-6.4	Standard Detail Drawings
Sheet No. ---	Sign Plates
Sheet No. 8-8.8	Structure Plans
Sheet No. ---	Computer Earthwork Data
Sheet No. 9	Cross Sections

TOTAL SHEETS = 21

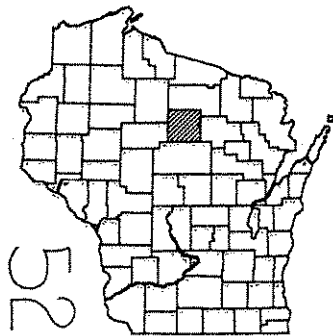

DESIGN DESIGNATION

A.D.T. (1998)	=	5
A.D.T. (2018)	=	10
D.H.V. (2018)	=	1
D.	=	50/50
T.	=	1%
DESIGN SPEED	=	50 km/h
ESALS	=	N/A

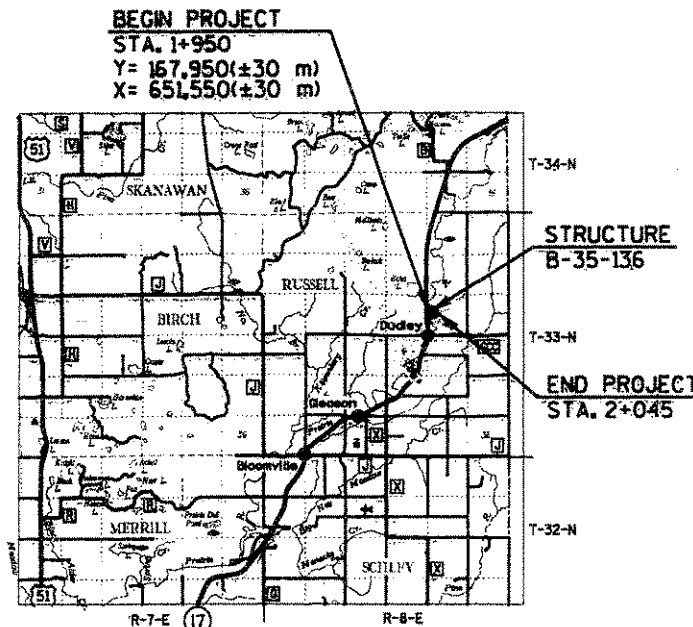

Conventional Symbols

County Line	-----	Combustible Fluids
Town or Range Line	-----	Railroad	-----
Section Line	-----	Fence	-----
Corporate Limits	-----	Culvert (in Place)	-----
Property Line	-----	Culvert (Required)	-----
Lot Line	-----	Power Pole	-----
Existing Right of Way Line	-----	Telephone Pole	-----
New Right of Way Line	-----	Telephone Pedestal	-----
Reference Line	-----	Right of Way Monument (Type)	-----
Slope Intercept	-----	Marsh	-----
Existing Roadway or Private Entrance	-----	Edge of Stream	-----
Limited Easement	-----	Wooded or Shrub Area	-----
Right of Way Point	-----	Grade Line Elevation	-----
Silt Fence	-----	Water	-----
Silt Screen	-----	Gas	-----
Erosion Bales	-----	Telephone	-----
Sod	-----	Electric	-----
Ditch Dike	-----	Cable Television	-----
Intercepting Embankment	-----	Fiber Optic	-----
Riprap	-----	Sanitary Sewer	-----
Erosion Mat	-----	Storm Sewer	-----

LAYOUT
SCALE 0 1 2 3 km

TOTAL NET LENGTH OF CENTERLINE = 0.095 km (RURAL)

COORDINATES ARE SCALED FROM THE U.S.G.S. TOPOGRAPHIC MAP GLEASON, WISCONSIN QUADRANGLE, FOR IDENTIFICATION ONLY.

ACCEPTED FOR
COUNTY OF LINCOLN

9/17/97 DATE *Peter A. Kachel* COMMISSIONER

ORIGINAL PLANS PREPARED BY:
MSA TRANSPORTATION • SURVEYING • ENVIRONMENTAL
1228 South Industrial Drive, WI 53115
608-336-0771 1-800-963-6666 Fax: 608-336-0770

WISCONSIN
JANICE M. BENNETT
REGISTERED PROFESSIONAL ENGINEER

9-9-97 DATE *Janice M. Bennett* SIGNATURE

STATE OF WISCONSIN
DEPARTMENT OF TRANSPORTATION

PREPARED BY
Surveyor **MSA PROFESSIONAL SERVICES, INC.**
Designer **MSA PROFESSIONAL SERVICES, INC.**
District Examiner
District Supervisor **ALLAN J. PETERSON**
Proj. Dev. Engineer
C.O. Examiner **N.R. AFFELDT**

APPROVED FOR DISTRICT OFFICE

DATE: 9/25/97 *Henry E. Harty* (Signature)

LINCOLN
9859-07-70
(9859-07-00)