

STATE PROJECT NUMBER	SHEET NO.
9856-1-70	8
CROSS SECTIONS	
DUGINSKI ROAD & MILL STREET	
DUGINSKI ROAD LINCOLN COUNTY	

STATION	DISTANCE	UNCL. EXCAV.	FILL
8+00			
9+00	100		30
10+00	100		330
11+96			
12+60	64		160
13+50	90		65
SHEET TOTALS			585

DATE \_\_\_\_\_ BY \_\_\_\_\_  
 SURVEYED \_\_\_\_\_ PLOTTED \_\_\_\_\_  
 ORIGINAL SURVEY BOOK NO. \_\_\_\_\_  
 NOTE BOOK NO. \_\_\_\_\_  
 AREAS CHECKED \_\_\_\_\_

DATE \_\_\_\_\_ BY \_\_\_\_\_  
 SURVEYED \_\_\_\_\_ PLOTTED \_\_\_\_\_  
 ORIGINAL SURVEY BOOK NO. \_\_\_\_\_  
 NOTE BOOK NO. \_\_\_\_\_  
 AREAS CHECKED \_\_\_\_\_

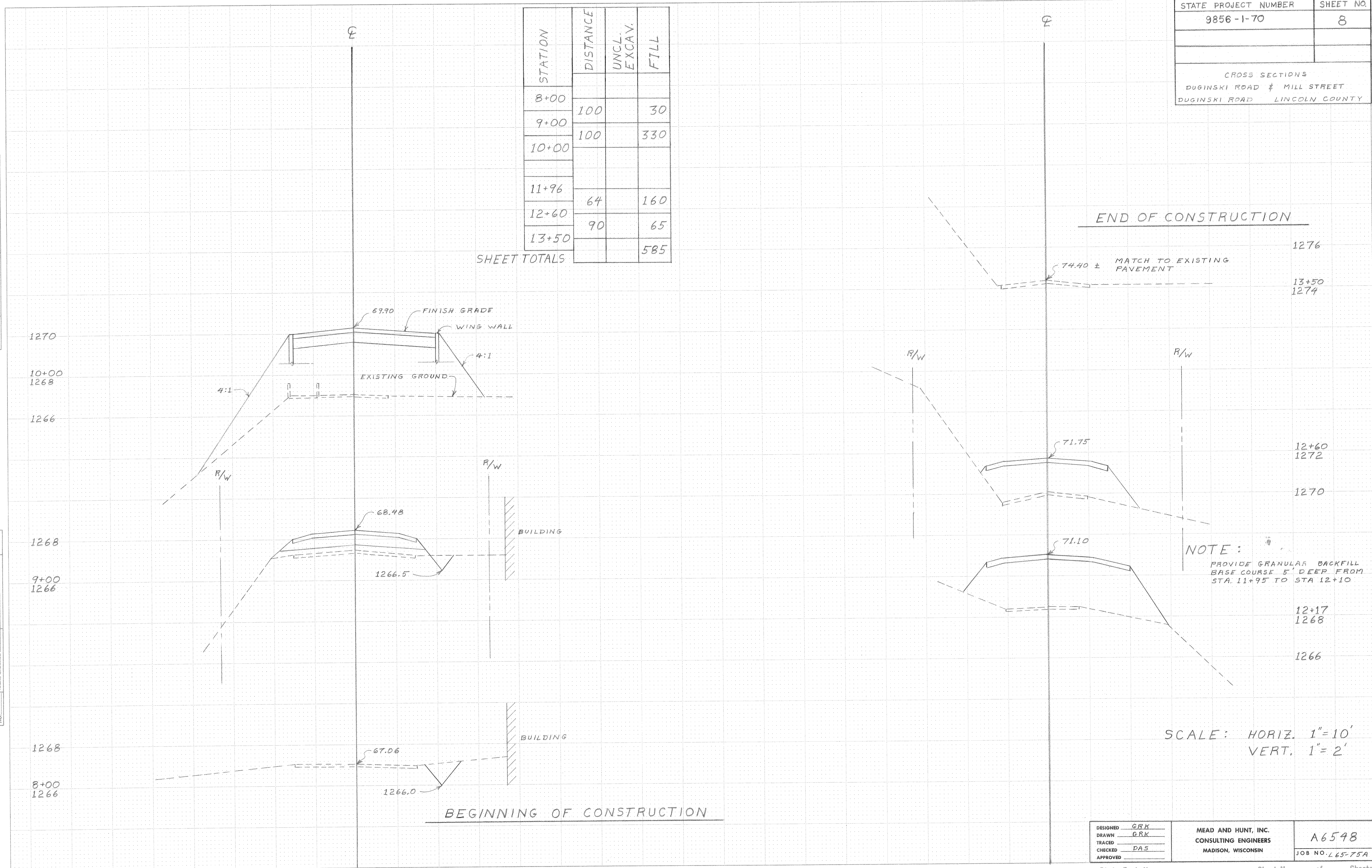

NOTE:  
 PROVIDE GRANULAR BACKFILL  
 BASE COURSE 5' DEEP FROM  
 STA. 11+95 TO STA 12+10

SCALE: HORIZ. 1"=10'  
 VERT. 1"=2'

DESIGNED	GRK	MEAD AND HUNT, INC. CONSULTING ENGINEERS MADISON, WISCONSIN	A6548 JOB NO. L65-75A
DRAWN	GRK		
CHECKED	DAS		
APPROVED			