

BENCH MARKS			
NO.	STA.	DESCRIPTION	ELEV.
1	22+31	SEC. LINE MON.	1426.23
2	98+38	RR SPIKE IN POWER POLE	1401.68

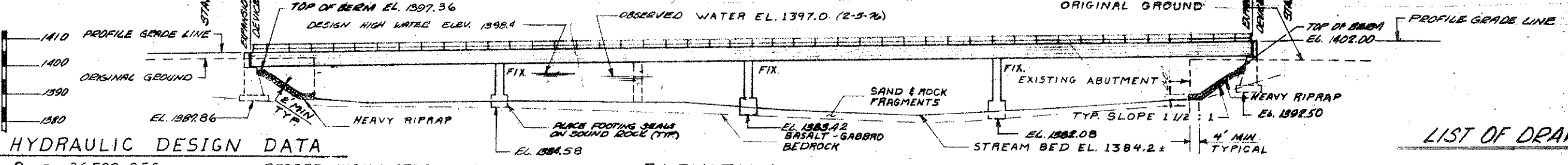
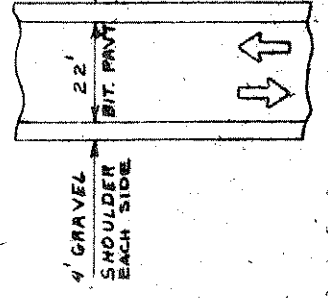
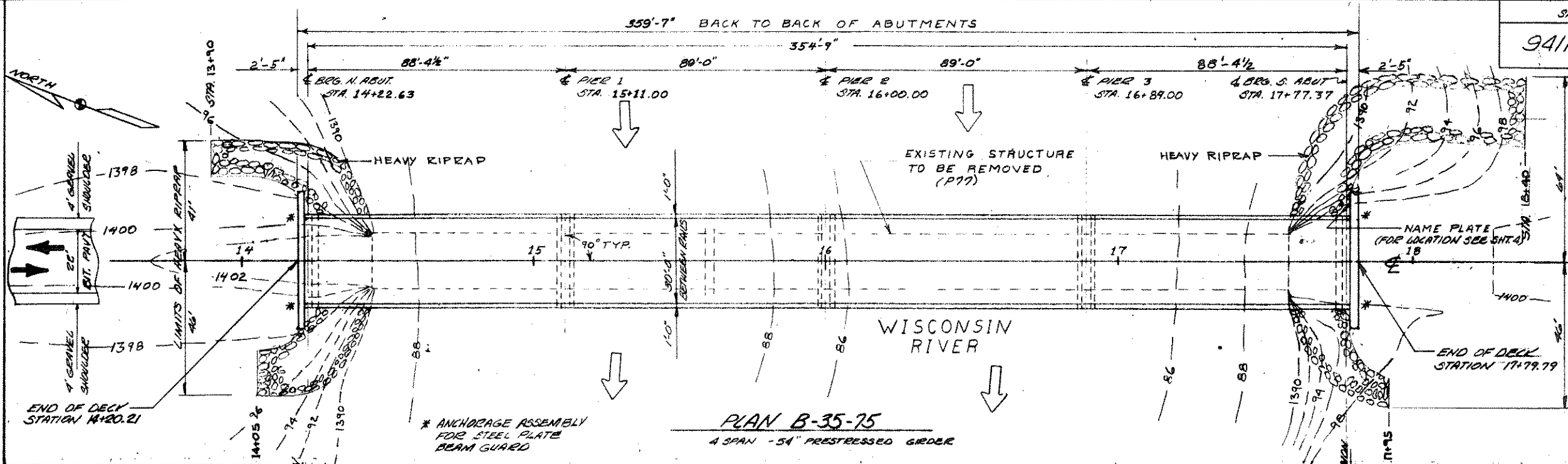

HYDRAULIC DESIGN DATA
 $Q_{100} = 26,500$ C.F.S.
 $V_{100} = 7.5$ F.P.S.
 WATERWAY AREA = 3540 S.F.
 H.W. = 1398.4
 DRAINAGE AREA = 2,293 SQ. MI.

ELEVATION

4. N. ABUT. STA. 14+22.63 EL. 1405.51	5. PIER 1 STA. 15+11.00 EL. 1406.66	6. PIER 2 STA. 16+00.00 EL. 1407.53	7. PIER 3 STA. 16+89.00 EL. 1408.41	8. S. ABUT. STA. 17+77.37 EL. 1410.15
---------------------------------------	-------------------------------------	-------------------------------------	-------------------------------------	---------------------------------------

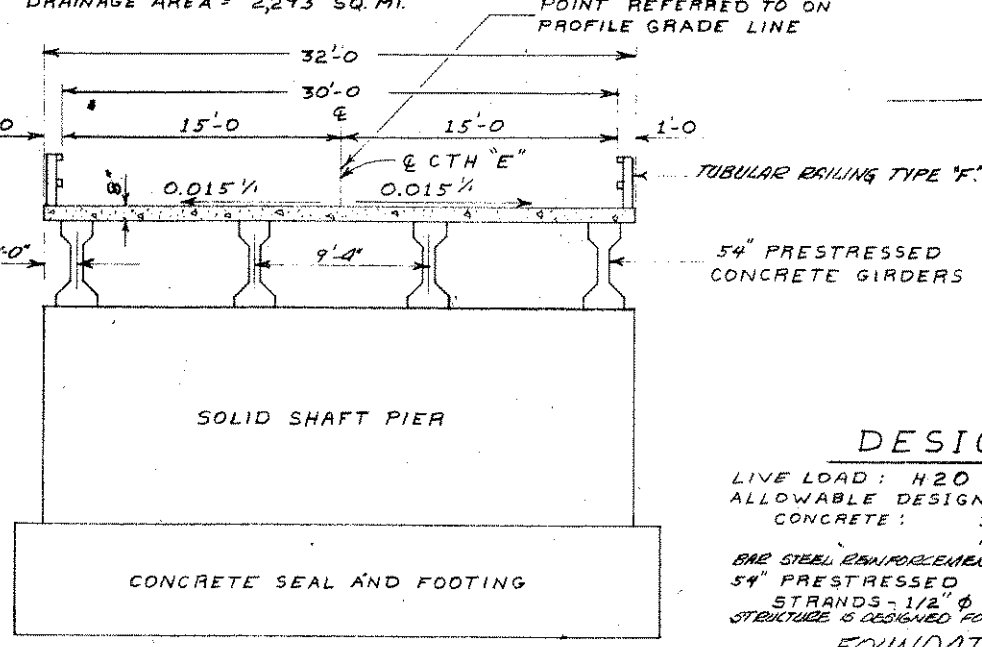

TRAFFIC DATA
 A.D.T. = 200 (1977)
 R.D.S. = 40 MPH

DESIGN DATA
 LIVE LOAD: H20
 ALLOWABLE DESIGN STRESSES:
 CONCRETE: SLAB $f_c = 4000$ P.S.I.
 ALL OTHER $f_c = 3500$ P.S.I.
 54\"/>

FOUNDATION DATA
 NORTH ABUTMENT AND PIERS TO BE PLACED ON SOUND BASALT-GABBRO BEDROCK WITH 10,000 POUNDS PER SQUARE FOOT BEARING. SOUTH ABUTMENT TO BE PLACED ON SOUND BLACK AND WHITE GRANITE GNEISS MATERIAL WITH 10,000 POUNDS PER SQUARE FOOT CAPACITY.

NOTES

- DRAWINGS SHALL NOT BE SCALED. BAR STEEL REINFORCEMENT SHALL BE EMBEDDED 2" CLEAR UNLESS OTHERWISE SHOWN OR NOTED.
- THE SLOPE OF THE FILL IN FRONT OF THE ABUTMENTS SHALL BE COVERED WITH HEAVY RIPEAP TO THE EXTENT SHOWN ON THIS SHEET AND IN THE ABUTMENT DETAILS.
- ELASTOMERIC BEARING PADS NEED NOT BE INDIVIDUALLY MOLDED PROVIDED THE CUT EDGES ARE SMOOTH AND TRUE.
- AT ABUTMENTS ALL SPACES EXCAVATED AND NOT OCCUPIED BY THE NEW STRUCTURE SHALL BE BACK-FILLED WITH GRANULAR BACKFILL. FILLMENT WILL BE MADE ONLY FOR MATERIAL ACTUALLY PLACED WITHIN THE LIMITS FOR "EXCAVATION FOR STRUCTURES". THE UPPER LIMITS OF "EXCAVATION FOR STRUCTURES" FOR THE ABUTMENTS AND PIERS SHALL BE THE ORIGINAL GROUND LINE.

RATINGS
 INVENTORY - H 25
 OPERATIONAL - HS 32(S.R.)

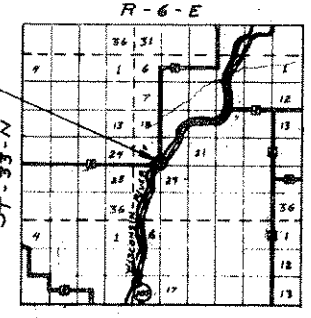

LIST OF DRAWINGS

1. GENERAL PLAN	X58160
2. SUBSURFACE EXPLORATION	X58161
3. NORTH ABUTMENT	X58162
4. SOUTH ABUTMENT	X58163
5. PIER 1	X58164
6. PIER 2	X58165
7. PIER 3	X58166
8. SUPERSTRUCTURE	X58167
9. SUPERSTRUCTURE DETAILS	X58168
10. 54\"/>	

NO.	DATE	REVISION	BY
STATE OF WISCONSIN DEPARTMENT OF TRANSPORTATION DIVISION OF HIGHWAYS			
STRUCTURE B-35-75			
CTH E OVER WISCONSIN RIVER			
COUNTY	LINCOLN	TOWN OF ROCK FALLS	
DESIGN SPEC. AND DETAILS	A.A.S.H.O. 1973	LOAD H20	CORNER 1975
DESIGNED BY	G.E.K.	CHECKED	T.L.K.
APPROVED	W.A. Kline	7-15-77	
CHIEF BRIDGE ENGINEER			DATE
GENERAL PLAN			SHEET 1 OF 15
			X58160

MEAD AND HUNT