

TOTAL ESTIMATED QUANTITIES

BID ITEMS	UNIT	SOUTH ABUT.	NORTH ABUT.	SUPER.	TOTAL
REMOVING OLD BRIDGE, STATION 19+86	L.S.				1
EXCAVATION FOR STRUCTURES, BRIDGES B-35-93	L.S.				1
CONCRETE MASONRY, BRIDGES	C.Y.	34.2	34.3	79.5	148
STRUCTURAL CARBON STEEL	LBS.			300	300
HIGH STRENGTH BAR STEEL REINFORCEMENT, BRIDGES	LBS.	2780	2790	12130	17700
PROTECTIVE SURFACE TREATMENT	GAL.			6	6
CRST-IN-PLCE CONCRETE PILING, DELIVERED AND DRIVEN, 10 3/4-INCH	L.F.	245	245		490
TUBULAR RAILING, TYPE F, STRUCTURE B-35-93	L.S.				1
HEAVY RIPRAP	C.Y.	90	100		190
COATED HIGH STRENGTH BAR STEEL REINFORCEMENT	LBS.			1860	1860
GEOTEXTILE FABRIC	S.Y.	140	150		290
NON-BID ITEMS					
POLYVINYL CHLORIDE WATERSTOP	L.F.	36	36		72
FILLER	SIZE				1/2" & 3/4"

GENERAL NOTES

- DRAWINGS SHALL NOT BE SCALED.
- BAR STEEL REINFORCEMENT SHALL BE EMBEDDED 2" CLEAR UNLESS SHOWN OR NOTED OTHERWISE.
- FILLER SHALL CONFORM TO A. A. S. H. T. O. DESIGNATION M153, TYPE I, II, III OR M213.
- THE FIRST DIGIT OF A THREE DIGIT BAR MARK SIGNIFIES THE BAR SIZE.
- THE SLOPE OF THE FILL IN FRONT OF THE ABUTMENTS SHALL BE COVERED WITH HEAVY RIPRAP TO THE LIMITS SHOWN ON SHEET 1, ON THE ABUTMENT SHEET OR AS DIRECTED BY THE ENGINEER.
- SLAB FALSEWORK SHALL BE SUPPORTED ON PILES. ○
- THE EXISTING STRUCTURE IS A SINGLE SPAN STEEL DECK GIRDER BRIDGE, 32'-0" ± LONG
- ALTERNATE SUPPORT MAY BE PROVIDED SUBJECT TO THE APPROVAL OF THE ENGINEER.

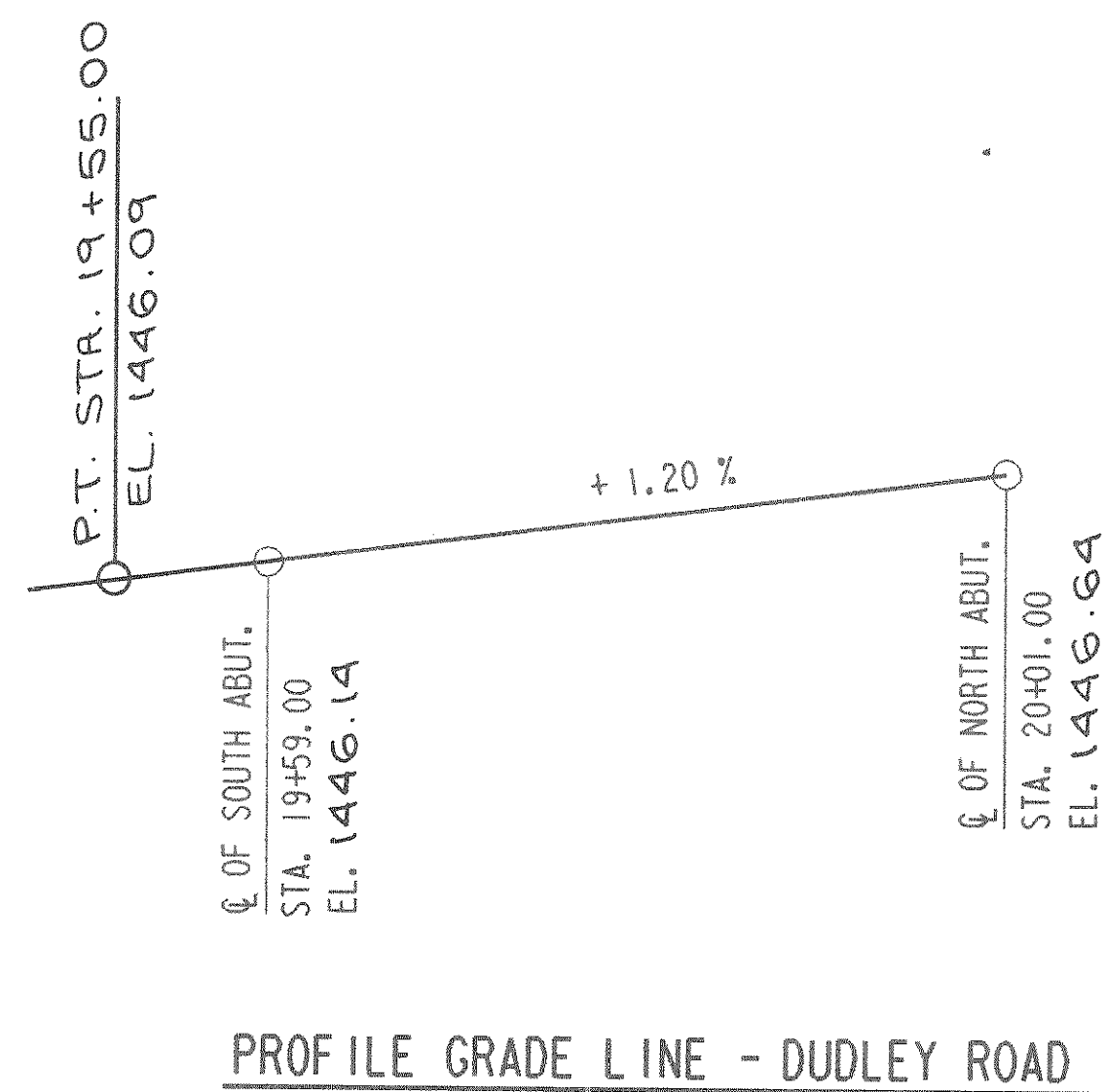

No.	Date	Revision	By
STATE OF WISCONSIN DEPARTMENT OF TRANSPORTATION			
STRUCTURE B-35-93			
Const. Spec.	Wis. 1981	Drawn By	D.F.K.
Plans Checked	JRL		
GENERAL PLAN		SHEET 2 OF 12	
		X78441	